



Drawing No. ES P601D

HYDRO BAN[®] XP

Tile Installation Mortar*

SPECTRALOCK[®] PRO Premium Grout; or,
PERMACOLOR[®] Select

Ceramic Tile or Stone

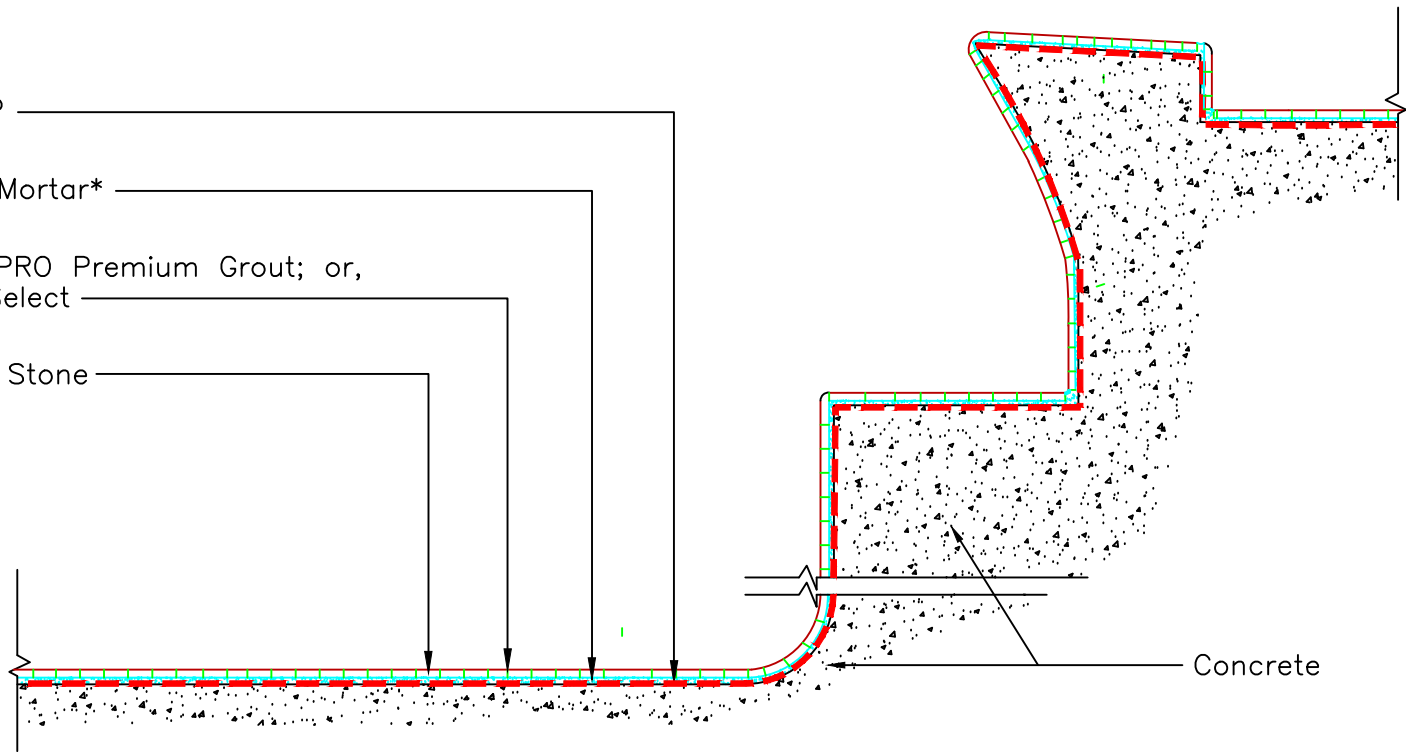

Concrete

* Slurry bond coat is required under the mortar bed at all horizontal surfaces.
Slurry bond coat and tile installation mortar to be either 254 Platinum Plus,
2574 Platinum or MULTIMAX[™] LITE.

Revision Date: 5/23 Scale: N.T.S.

AS A PROFESSIONAL COURTESY, LATICRETE OFFERS TECHNICAL SERVICES FREE OF CHARGE. THE USER MAINTAINS ALL RESPONSIBILITY FOR VERIFYING THE APPLICABILITY AND SUITABILITY OF THE TECHNICAL SERVICE OR INFORMATION PROVIDED.

(C)2023 LATICRETE INTERNATIONAL, INC. ALL RIGHTS RESERVED. THE RIGHT TO UTILIZE LATICRETE DETAILS FOR COMMERCIAL PURPOSES IS GRANTED EXCLUSIVELY TO CONTRACTORS, ARCHITECTS, QUANTITY SURVEYORS, ENGINEERS, AND SPECIFICATIONS WRITERS. ALL TRADEMARKS SHOWN ARE THE INTELLECTUAL PROPERTY OF THEIR RESPECTIVE OWNERS.