



Drawing No. ES-P602

HYDRO BAN[®] Cementitious Waterproofing

3701 Fortified Mortar Bed

Tile Installation Mortar*

SPECTRALOCK[®] PRO Premium Grout; or,
PERMACOLOR[®] Select

Ceramic, Glass or Stone Tile

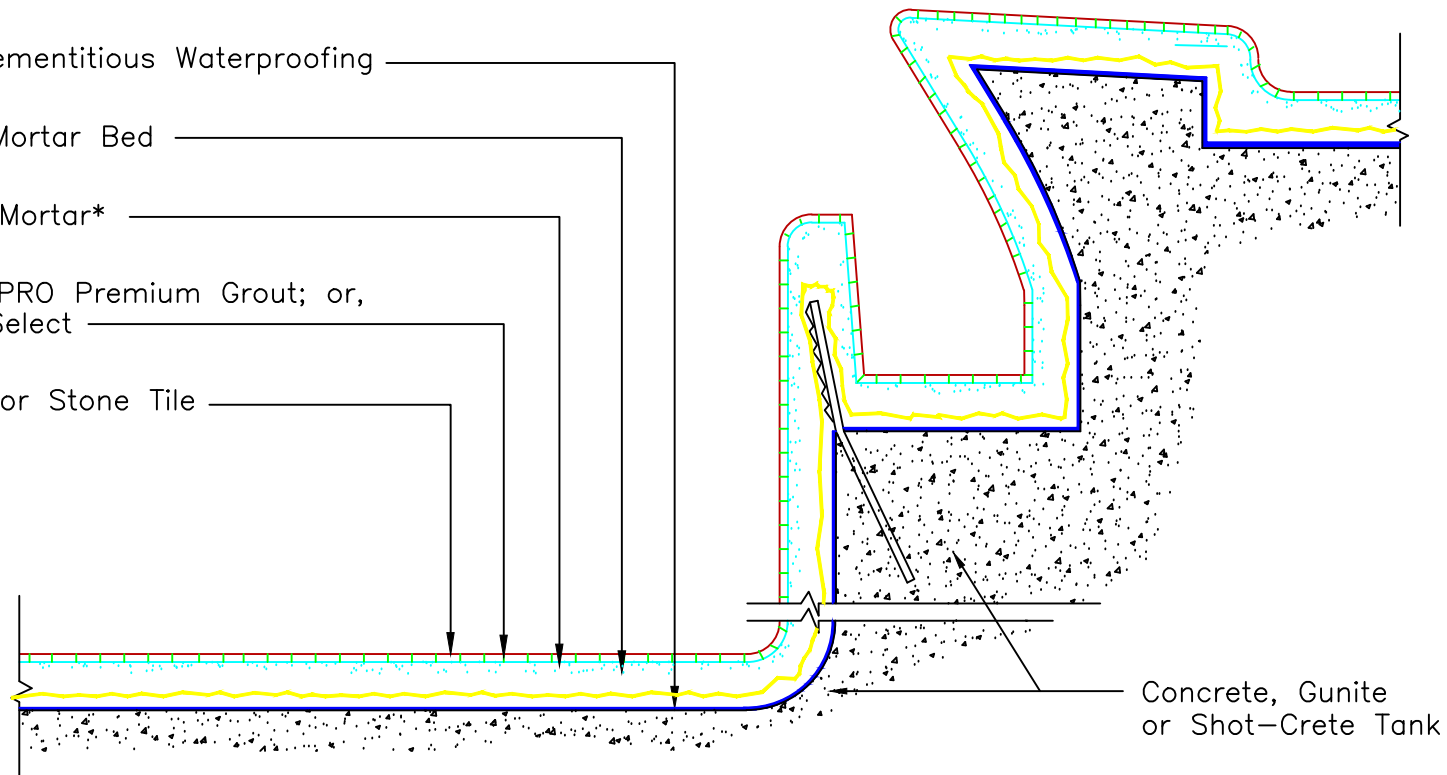

- * Slurry bond coat is required under the mortar bed at all horizontal surfaces. Slurry bond coat and tile installation mortar to be either 254 Platinum Plus, 254 Platinum or MULTIMAX LITE. Movement joints are required at all changes of plane, around all penetrations, and throughout field on floors and walls. Use LATICRETE LATASIL with LATICRETE 9118 Primer in movement joints. Refer to TCNA EJ-171 for more information on movement joints.

Revision Date: 5/23 Scale: N.T.S.

AS A PROFESSIONAL COURTESY, LATICRETE OFFERS TECHNICAL SERVICES FREE OF CHARGE. THE USER MAINTAINS ALL RESPONSIBILITY FOR VERIFYING THE APPLICABILITY AND SUITABILITY OF THE TECHNICAL SERVICE OR INFORMATION PROVIDED.

(C)2023 LATICRETE INTERNATIONAL, INC. ALL RIGHTS RESERVED. THE RIGHT TO UTILIZE LATICRETE DETAILS FOR COMMERCIAL PURPOSES IS GRANTED EXCLUSIVELY TO CONTRACTORS, ARCHITECTS, QUANTITY SURVEYORS, ENGINEERS, AND SPECIFICATIONS WRITERS. ALL TRADEMARKS SHOWN ARE THE INTELLECTUAL PROPERTY OF THEIR RESPECTIVE OWNERS.