



Globally Proven
Construction Solutions

LATAPOXY[®] SP-100 Installation Guide Australia

TDS-1012



- An epoxy grout or coloured epoxy adhesive for tiling contractors.
- For most ceramic tile, glass tile, porcelain tile and natural stone.
- Floors and walls.
- Interior and exterior.
- Residential and commercial.

LATAPOXY® SP100 installs easily and provides the colour uniformity, stain protection and durability you can only get with an epoxy grout. New improved non-sag formula makes installation even easier and helps achieve full, flush grout joints. LATAPOXY SP-100 Grout can be used for interior or exterior applications on floors and walls. LATAPOXY® SP100 is also an economical coloured epoxy adhesive. It can be used over difficult to bond to substrates for interior and exterior applications on floors and walls.

BEFORE YOU BEGIN GROUTING

- Contact LATICRETE for free training, particularly where a trained LATAPOXY SP-100 Grouter is a condition of warranty.
- LATAPOXY SP-100 is easy to use however it is not installed in the same way as ordinary epoxy grouts.
- Follow adhesive manufacturer's recommendations for minimum cure times prior to grouting.
- LATAPOXY SP-100 is a sanded grout. Use of sanded grouts in joints less than 3 mm will result in a coarser surface texture as compared to wider joints.
- Do not add water or any other materials to the grout mixture. Do not re-temper with water or solvents. This will have an adverse effect on the product and void all warranties.
- Clean-up is critical. Prepare for the initial and final washes by having pails of clean water and all necessary supplies for the clean up process ready.
- Not for use in areas subjected to enzymatic cleaners and no-rinse cleaners. Use LATICRETE SPECTRALOCK 2000 IG for installations exposed to these cleaners.
- Part C grout powder should be from the same batch/lot and have the same C.N. number. If using Part C powder with different C.N. numbers, mix dry powder thoroughly prior to adding gauging liquid. No claims for shade variation will be honoured.
- Conduct mock-up of grouts with the tile for approval of colour prior to commencing installation.

ENSURE THE FOLLOWING ITEMS ARE ON THE JOBSITE BEFORE GROUTING.

Preparation and Installation Tools

- Broom/vacuum (remove debris)
- Utility knife (removes excess thin-set in joints, open A and B pouches)
- Clean water and sponges (to clean surface of tile)
- Firm edged, rubber epoxy grout float
- Margin trowel
- Low speed drill and grout mix paddle (optional)
- Empty pails
- Sheets of 100um plastic to work on.

Clean-up Supplies

- Fresh water supply
- Extra sponges
- Terry cloth towels (optional for wall clean up)
- Empty pails
- White scrub pad

STORAGE



Condition the components at 21°C to allow for easier application.
Protect Part A and Part B liquids from freezing.

SURFACE PREPARATION

Note: Ensure the substrate including tile bedding is dry before commencing work. Wet/damp substrates may damage curing grout, cause surface blemishes in the grout, or discolour grout.

- Ensure the tile surface is clean and has no residual film from adhesive setting material.
- Use STONETECH® Grout Release on unglazed, abrasive, rough textured or porous ceramic or stone tile to facilitate cleaning and reduce trapping of epoxy.
- LATAPOXY SP-100 Grout, as well as other sanded grouts, may "scratch" glass tiles, soft or polished marble and stone, soft glazed and handmade tiles. Test grout on a small area to ensure compatibility.

- Test stone for compatibility.
- Epoxy resins may affect the colour of white or light coloured porous stones (such as White Carrara, Thassos White, Royal Danby, etc.).
- Make sure tile joints are free from debris, spacers, high tile mountings or standing water.
- Surface temperature range for installation must be above 16°C (including for the length of the cure period) and less than 32°C.

WORKING TIME

Working time of grout is approximately 60 minutes at 21°C after the components are thoroughly mixed. Please note that working time is affected by many variables including grout mix consistency, surface and ambient temperatures. Warmer climates, for example, will shorten working time, while colder conditions will extend working time.

NOTE: Wear appropriate personal protection, including gloves and glasses. See SDS.

MIXING

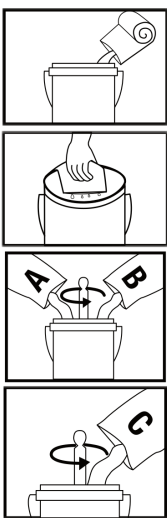

- Cut open Part A and B pouches, and squeeze the liquids (A first, then B) into a clean pail.

IMPORTANT: MAKE SURE TO SQUEEZE ALL THE LIQUIDS OUT OF THE POUCHES. DO NOT SPLIT KITS. USE FULL KITS ONLY.

NOTE:

- Make sure tile is ready to grout before mixing.
- Fold pouches in half and rollup like a toothpaste tube.
- To remove any remaining liquid, fold pouch in half from top to bottom, drape folded pouch over the edge of the pail and squeeze out liquids against the inside of the pail.
- Mix liquids thoroughly, completely blending all liquid from sides and bottom of pail. Mix with a margin trowel or slow speed drill mixer (< 300 RPM) until liquids are completely blended and of one uniform colour.
- Once blended, add Part C colour powder to blended A and B liquids and mix thoroughly with margin trowel or slow speed drill mixer (< 300 RPM) until liquids are completely blended and of one uniform colour. The LATAPOXY® SP-100 Grout unit is designed to use all the Part C colour powder for most applications. For narrow joints, it is acceptable to leave up to 10% Part C colour powder to produce a more fluid mix.

GROUTING

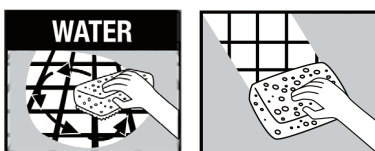

- Dampen tile surface with a wet sponge to help lubricate the application. Remove any free standing water in the joints before application
- After mixing, dump grout from bucket onto the tiles or a sheet of clean plastic and spread out to slow the reaction and speed of set.
- Spread grout using a sharp edged, firm rubber grout float. Work the grout diagonally across the joints, packing them full.
- “Cut” excess grout off the tile surface using the edge of the float held at a 90° angle like a squeegee, striking the joint direction at an angle to avoid having the float edge digging into the packed joint and pulling grout out.
- Once the grout has been spread and joints filled, loosen any excess grout and dress joints smooth by using a wet scrub pad or sponge in a circular motion on the surface of the tile. Clean off any further excess grout using plenty of water. Rinse scrub pads or sponges regularly in a clean water. Change water regularly
- Repair any low spots with additional grout

INITIAL WASH



NOTE: Have multiple pails of clean water ready.

- Wait 15 - 20 minutes or within 1 hour of mixing before cleaning the remaining grout and film from the face of the tile after the joints have been initially dressed. Continue to use a wet scrub pad or sponge in a circular motion to breakdown epoxy film on the face of the tile
- Drag a clean wet sponge diagonally over the tile surface to remove grout film. Rinse sponges regularly after every pass; use each side of sponge only once between rinsing.
- Instead of a sponge, the use of a wet folded cloth towel can be helpful to remove excess grout. Dragging a heavy wet towel diagonally across the joints will remove epoxy film. Rinse cloth regularly for best results

FINAL INSPECTION AND CLEANING

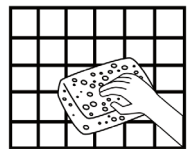

- Begin final cleaning approximately 6-8 hours after installation or when the grout can withstand aggressive cleaning with scrub pads and detergent. Carry out final clean within 24 hours of application.
- Follow the same process as the initial wash but use the clean white scrub pad in place of the sponge to break apart any leftover film. Rinse scrub pad frequently.
- **Do not expose grout to acid cleaners or epoxy grout haze removers for 7 days.**
- Allow grout to cure for 10 days at 21°C prior to use in immersed applications or steam rooms. See LATICRETE LATAPOXY SP-100 Grout Product Data Sheet DS-1070 for more information.
- The use of solvents before adequate curing will likely cause damage to the grout installation. Manifestations include, whitening of grout, weakening of grout or loss of chemical resistance.
- The use of cleaning chemicals on curing grout, other than those discussed in this document, will damage the grout. Manifestations include, change of colour, weakening of grouts or loss of chemical resistance.

PROTECTION OF SURFACE AND TIME TO TRAFFIC



- Protect finished surface from traffic for at least 24 hours at 21°C.

ITEM	TIME @21°C
Working Time	60 minutes
Tack Free Time	24 hours
Ready for Light Foot Traffic	24 hours
Ready for Heavy Foot Traffic	72 hours
Cure time before immersion	10 days

Note: Do not cover with moisture vapour blocking covers like polyethylene till grout is cured.

BEFORE YOU BEGIN USING AS A COLOURED ADHESIVE

- Have sufficient tile area ready to install prior to mixing.
- Do not add water or any other materials to the epoxy mixture.
- Where a coloured adhesive influences the aesthetics of the work, ensure the Part C grout powder is from the same batch/lot and have the same C.N. number. If using Part C powder with different C.N. numbers, mix dry powder thoroughly prior to adding gauging liquid. No claims for shade variation will be honoured.

INSTALLATION TOOLS AND SUPPLIES

- Utility knife (Open A and B pouches)
- Mixing pail
- Margin trowel
- Low speed drill and grout mix paddle (optional)
- Clean water and sponges (to clean surface and tools)
- Appropriate sized notch trowel
- Empty Pails
- Sheets of 100um plastic to work on
- White scrub pad

SURFACE PREPARATION

- Before starting, clean areas to be covered. Remove dust and dirt using a damp sponge.
- Do not leave water standing in on surfaces to be treated, applications can be made on damp surfaces.
- Do not clean surfaces with acid based cleaners. Condition substrates, temperature must be 16°C and rising and not more than 32°C.
- Polyester or fiberglass surfaces should be mechanically cleaned prior to the application of LATAPOXY SP-100. Lightly sand to clean and remove waxes and mold releases from surfaces. Metals should be brushed back to bright and coated with SP-100 liquids just prior to adhesive work in critical installations.
- Warm temperatures will speed curing and shorten working time. Cool temperatures will slow curing and require longer time to traffic.
- Store LATAPOXY SP-100 Epoxy at 21°C for 24 hours prior to use.

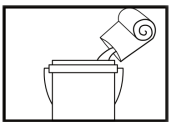

MIXING

Cut open Part A and B pouches, and squeeze the liquids (A first, then B) into a clean pail.

IMPORTANT: MAKE SURE TO SQUEEZE ALL THE LIQUIDS OUT OF THE POUCHES. DO NOT SPLIT KITS. USE FULL KITS ONLY.

NOTE:

- Make sure tile is ready to install before mixing.
- Fold pouches in half and rollup like a toothpaste tube.
- To remove any remaining liquid, fold pouch in half from top to bottom, drape folded pouch over the edge of the pail and squeeze out liquids against the inside of the pail.
- Mix liquids thoroughly, completely blending all liquid from sides and bottom of pail. Mix with a margin trowel or slow speed drill mixer (<300 RPM) until liquids are completely blended and of one uniform colour.
- Once blended, add Part C colour powder to blended A and B liquids and mix thoroughly with margin trowel or slow speed drill mixer (< 300 RPM) until liquids are completely blended and of one uniform colour. It is acceptable to leave out Part C colour powder to produce a more trowelable mix.

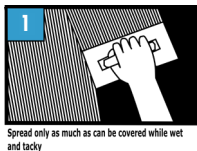
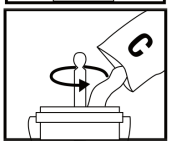
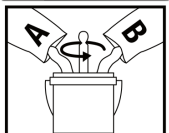
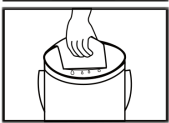

Spread only as much as can be covered while wet and tacky

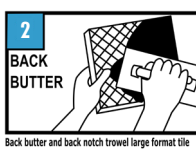

BACK BUTTER and back notch trowel large format tile

APPLICATION

Apply adhesive to the substrate with the flat side of the trowel, pressing firmly to work into surface. Comb on additional adhesive with the notched side. Note: Use the proper sized notched trowel to insure full bedding of the tile. Back butter large tiles to provide full bedding and firm support. Place tiles into wet, sticky adhesive to the correct alignment and level. Check adhesive for complete coverage by periodically removing a tile and inspecting bedding adhesive transfer onto back of tile.

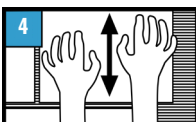

See AS3958 For trowel & application method

CLEANING

Remove excess adhesive from the face of the tiles as the work progresses with a wet sponge

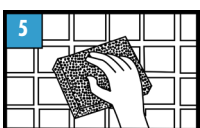

CAUTIONS (See SDS)

NOTE: Always use protective clothing (gloves, long sleeve shirt and safety glasses) when working with epoxy LATAPOXY SP-100 Epoxy Grout.
KEEP OUT OF REACH OF CHILDREN.

PART AB LIQUIDS CAUTION

This product can be irritating to eyes and skin. Avoid prolonged contact with eyes and skin. In case of direct contact with eyes, wash eyes immediately with water and seek medical attention quickly. Do not swallow. **KEEP OUT OF REACH OF CHILDREN.**

PART C POWDER CAUTION

Contains silica sand. Crystalline silica inhaled from occupational sources can cause cancer in humans. Prolonged inhalation of silica sand may cause delayed lung injury including silicosis. May irritate eyes. Avoid contact with eyes. In case of contact, flush thoroughly with water. Do not take internally. Avoid breathing dust. Wear safety glasses and a WorkSafe approved dust respirator in dusty areas. For more information consult the SDS for this product. **KEEP OUT OF REACH OF CHILDREN.**

MAINTENANCE

LATICRETE and LATAPOXY grouts, sealers and sealants require routine maintenance and cleaning with a neutral pH detergent and water. See TDS 1113 for more information. Contact the cleaner manufacturer if another cleaner type will be used to ensure compatibility with the grout.

All other LATICRETE and LATAPOXY non-finish materials require no maintenance but installation performance and durability may depend on properly maintaining products supplied by other manufacturers.

WARNING: This product may cause skin sensitization. Avoid skin contact. Wear gloves when using this product.