



LATAPOXY® 300 Adhesive

A chemical resistant, EPOXY adhesive that will bond to most sound, clean surfaces. Adhesive spreads easily and cleans with water while fresh. LATAPOXY 300 Adhesive is a factory-proportioned kit consisting of epoxy resin, hardener, and chemical resistant silica filler.



ADVANTAGES



- Water cleanable
- No flammable solvents are required to clean tools or finished work.
- Ideal for installing moisture sensitive marble and agglomerate tiles.
- Ideal for the installation of resin backed tile, mosaics, stone, and agglomerates.
- Non-staining on white and light-colored marble
- High bond strength
- Maximum chemical resistance
- Superior adhesion for submerged applications.

Note: The Tile Council of North America recommends the use of epoxy adhesives and grouts for thin-set installations on suspended concrete slabs and for floors and walls when chemical resistance is required.

MANUFACTURER

LATICRETE Middle East LLC.
P.O. Box. 86028, Ras Al Khaimah
United Arab Emirates
Toll Free (with in UAE) 800 5632
Telephone: + 971 7 244 6396
Fax: + 971 7 244 5915
www.laticrete.me

USES

- Can be used in interior and exterior (see limitations) walls and floors, wet and dry areas.
- For heavy-duty commercial chemical resistant installations in food processing areas, commercial kitchens, restaurants, etc.
- Install all types of ceramic tile, marble, and natural stone over post-tensioned and precast floor systems.
- Recommended for rubber flooring and wood block floors.
- The installation of green marble, white marble, and resin backed tiles and stones agglomerate marbles that tend to stain, darken or warp when installed with water-based installation materials.
- Can be used in Swimming pools.

STANDARDS / CERTIFICATIONS

**Conforms to ISO
13007 with a R2
Classification
EN 12004
ANSI A118.3**



DCLD & GREENGUARD CERTIFIED

Please see the technical data

Packaging:

#2 Unit: Net weight 11.1kg, Gross weight 12.1Kg, makes 6.8 L of Mortar, #2 unit consists of the following components:

- 2 pouches of Part A, 2 pouches of Part B and 2 bags of Part C Powder. All components packed in one pail, 48 pails per pallet.

Commercial unit: Net weight: 22.2Kg, Gross weight: 23.7 Kg, consists of the following components:

- 4 pouches of Part A & Part B in a pail 48 pails/pallet
- 4 bags of Part C Powder in a carton 48 cartons/pallet

Suitable Substrates

- Concrete
- Ceramic Tile and Stones
- Exterior Glue Plywood*
- Concrete Masonry
- Brick Masonry
- Non-Water-Soluble Cut-Back Adhesive*
- Vinyl Or Other Resilient Tile*
- Cement Mortar Beds
- Gypsum Wallboard*
- Cement Plaster
- Cement Terrazzo
- Plastic Laminate*
- Cement Backer Board**
- Steel
- Fiberglass
- HYDRO BAN® Board***

* Interior application only.

**Consult cement backer board manufacturer for specific installation recommendations and to verify acceptability for exterior use.

***Consult product datasheet (DS-040.0) for specific installation recommendations

Approximate Coverage for #2 Unit (11.1 kg/6.8 L)

NOTE: Above coverage is intended as a guide, it may vary depending upon application technique, substrate profile/flatness, trowel angle, trowel wear and wastage factor. Actual coverage shall be determined by mockup area based on site conditions.

Trowel Type	Area
With 1.5 mm (1/16") v-notch trowel	125-135 ft ² (11.6-12.5 m ²)
With 4 mm (3/16") v-notch trowel	40-50 ft ² (3.7-4.6m ²)
With 3 x 3 mm (1/8" x 1/8) square notch trowel	60-70 sq. ft / 5.6-6.5 m ²
With 6 x 6 mm (1/4" x 1/4) square notch trowel	30-35 sq. ft / 2.8-3.3 m ²

Shelf Life: Factory sealed containers of this product are guaranteed to be of first quality for two (2) years if stored at 10 - 30°C at 50 - 60% relative humidity. (High humidity will reduce the shelf life of bagged product.)

Limitations

- For veneer installations using this product, consult local building code requirements regarding limitations and installation system specifications.

- Not intended for use as grout. Please use LATICRETE® Grouts, such as SPECTRALOCK® Pro Premium Grout or PERMACOLOR® Grout, etc.
- Do not install when surface temperature is below 60°F (16°C) or above 90°F (32°C).
- Not for use as a wear surface.
- Adhesives for ceramic tile and stone are not replacements for waterproofing membranes. When a waterproofing membrane is required, use a LATICRETE® Waterproofing Membrane (see Section 10 FILING SYSTEMS).
- Consult LATICRETE® Technical Services on limitations for exterior installations.

Note: Surfaces must be structurally sound, stable and rigid enough to support ceramic/stone tile, thin brick and similar finishes. Substrate deflection under all live, dead and impact loads, including concentrated loads, must not exceed L/360 for thin bed ceramic tile/brick installations or L/480 for thin bed stone installations where L=span length (except where local building codes specify more stringent deflection requirements)

Cautions

Consult SDS for more safety information.

- During cold weather, protect finished work from traffic until fully cured.
- LATAPOXY® 300 Adhesive Part A is corrosive until fully cured. Damage to eyes or skin is possible.
- Wait 14 days after the final grouting period before filling water features with water at 70°F (21°C).
- Contains silica sand. Silica sand may cause cancer or serious lung problems. Avoid breathing dust. Wear a respirator in dusty areas.
- Keep out of reach of children.

TECHNICAL DATA**Performance Properties**

Test	Method	Specification	Results
Quarry Tile Shear Bond Strength	ANSI A118.3-5.5	>1000 psi (6.9 MPa)	>1000 psi (6.9 MPa)
Tensile Strength	ANSI A118.3-5.7	>1000 psi (6.9 MPa)	1000-1400 psi (6.9-9.6 MPa)
Compressive Strength	ASTM C579	>3500 psi (24.1 MPa)	6970-7550 psi (48.1-50.8 MPa)
Thermal Shock Resistance	ANSI A118.3-5.8	>500 psi (3.4 MPa)	600-700 psi (4.1-4.8 MPa)
Shrinkage	ANSI A118.3-5.3	<0.25%	0-0.1%
Sag Resistance	ANSI A118.3-5.4	No shape change	Pass
Water Cleanability	ANSI A118.3-5.1	>80 minutes	>80 minutes
Shear Adhesion Strength	ISO 13007-2 4.3.4	≥2 N/mm ²	>5 N/mm ²
Shear Adhesion Strength after Water Immersion	ISO 13007-2 4.3.5	≥2 N/mm ²	≥2 N/mm ²
Shear Adhesion After Thermal Shock	ISO 13007-2 4.3.8	≥2 N/mm ²	≥2 N/mm ²
Open Time: Tensile Adhesion Strength	ISO 13007-2 4.1	>0.5 N/mm ² in not less than 20 minutes	>0.5 N/mm ² in not less than 20 minutes

Specifications subject to change without notification. Results shown are typical but reflect test procedures used. Actual field performance will depend on installation methods and site conditions.

Classification in Compliance with EN 12004

LATAPOXY 300 Epoxy Adhesive is an improved reaction resin adhesive classified as R2. LATAPOXY 300 Epoxy Adhesive is CE marked, as declared in report no. 50/0776/05 issued by Materialprüfungs- und Versuchsanstalt Neuwied Forschungsinstitut für Vulkanische Baustoffe GmbH (Neuwied, Germany)

Working Properties (70°F [21°C])

Pot Life	45 minutes
Time to Grout	12 hours
Time to Light Traffic	12 hours
Time to Heavy Traffic	24 hours
Minimum Application Layer	1/8 in (3 mm)
Maximum Application Layer	3/8 in (9 mm)
Wet Density	1.80± 0.10 g/cm ³

CHEMICAL RESISTANCE CHART

REAGENT TYPE at (70°F [21°C])	LATAPOXY® 300 adhesive exposure level	
	Intermittent	Constant
Citric Acid 10%	R	R
Sulfuric Acid 10%	R	R
Hydrochloric Acid 10%	R	R
Lactic Acid 5%	R	R
Vinegar	R	NR
Acetic Acid 10%	R	NR
Nitric Acid 10%	R	R
Sodium Hydroxide 10%	R	R
Sodium Chloride 10%	R	R
Concentrated Detergents	R	R
Ammonium Hydroxide	R	R
Sugars	R	R
Gasoline	R	R
Cooking Oils	R	R
Turpentine	R	R
Mineral Spirits	R	R
Toluene	NR	NR
Xylene	NR	NR

R= Recommended NR= Not Recommended

Chemical Resistance determined in accordance with ASTM C267-1982.

NOTES TO SPECIFIER: Use the constant exposure recommendations for intermittent exposure to reagents at temperatures above 90°F (32°C).

DCLD: This product has been certified for Low Emitting Materials by Dubai Central Laboratory Department (DCLD) of Dubai Municipality. No.CL20020733: 2017 Al Sa'fat Dubai Green Building Evaluation System.

GREENGUARD: This product has been certified for Low Chemical Emissions (ULCOM/GG UL2818) under the UL GREENGUARD Certification Program for Chemical Emissions for Building Materials, Finishes and Furnishings (UL 2818 Standard) by UL Environment.

Total VOC Content (g/L) of product is < 24 g/L

INSTALLATION

Surface Preparation



All surfaces should be between 60°F (16°C) and 90°F (32°C) and structurally sound, clean and free of all dirt, oil, grease, paint, concrete sealers or curing compounds. Rough or uneven concrete surfaces should be made smooth with Latex Portland Cement Underlayment to provide a wood float (or better) finish.

Installation may be made on a damp surface. New concrete slabs must be damp cured and 28 days old prior to application. All slabs must be plumb and true to within 1/4" (6 mm) in 10 ft (3 m). Expansion joints shall be provided through the tile work from all construction or expansion joints in the substrate. Follow ANSI specification A108.01-3.7 "Requirements for Movement Joints: Preparations by Other Trades" or TCNA detail EJ-171 "Movement Joints—Vertical & Horizontal". Do not cover expansion joints with mortar.

Note: Temperature will effect working properties of LATAPOXY 300 Adhesive. Warm temperatures will speed curing and shorten working time. Cool temperatures will slow curing and require longer time to traffic. Store LATAPOXY 300 Adhesive at 70°F (21°C) for 24 hours prior to use.

1. Installer must verify that deflection under all live, dead and impact loads of interior plywood floors does not exceed industry standards of L/360 for ceramic tile and brick or L/480 for stone installations where L=span length.
2. Minimum construction for interior plywood floors.
SUBFLOOR: 15 mm (5/8") thick exterior glue plywood, either plain with all sheet edges blocked or tongue and groove, over bridged joints spaced 400 mm (16") o.c. maximum; fasten plywood 150 mm (6") o.c. along sheet ends and 200 mm (8") o.c. along intermediate supports with 8d ring-shank, coated or hot dip galvanized nails (or screws); allow 3 mm (1/8") between sheet ends and 6 mm (1/4") between sheets edges; all sheet ends must be supported by a framing member; glue sheets to joints with construction adhesive.

UNDERLAYMENT: 15 mm (5/8") thick exterior glue plywood fastened 150 mm (6") o.c. along sheet ends and 200 mm (8") o.c. in the panel field (both directions) with 8d ring-shank, coated or hot dip galvanized nails (or screws); allow 1/8" (3 mm) to 6 mm (1/4") between sheets and 6 mm (1/4") between sheet edges and any abutting surfaces; offset underlayment joints from joints in subfloor and stagger joints between sheet ends; glue underlayment to subfloor with construction adhesive. Refer to Technical Data Sheet 152 "Bonding Ceramic Tile Stone or Brick Over Wood Floors" for complete details.

3. DO NOT bond to particle board, OSB, luan, Masonite® or hardwood surfaces.

Mixing

Pour LATAPOXY® 300 Adhesive Part A and Part B into a clean mixing pail and mix thoroughly.

Add LATAPOXY® 300 Part C Filler Powder and mix to a smooth, trowelable consistency. Mortar is ready for use immediately after mixing.

Application

Apply mortar to the substrate with the flat side of the trowel,

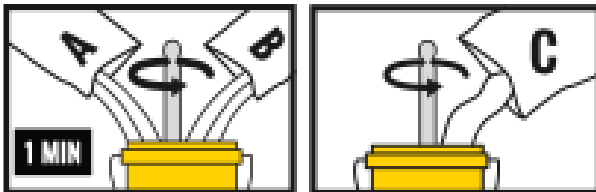

pressing firmly to work into surface. Comb on additional mortar with the notched side.

Note: Use the proper sized notched trowel to ensure full bedding of the tile. Back butter large tiles > 8" x 8" (>200 mm x 200 mm) to provide full bedding and firm support. Place tiles into wet, sticky mortar and beat in using a beating block and rubber mallet to embed tile and adjust level. Check mortar for complete coverage by periodically removing the tile and inspecting



bedding mortar transfer onto back of tile.

Curing: Allow to cure for 48 hrs. minimum for heavy traffic and 5 - 7 days for full cure before subject to final service, at $25 \pm 5^\circ\text{C}$ & $55 \pm 5\%$ relative humidity conditions.

AVAILABILITY AND COST

Availability

LATICRETE® materials are available worldwide.

For distributor information, please contact us by email at: enquiry@laticrete.me or, visit www.laticrete.me

Cost

Contact a LATICRETE® closer distributor to obtain complete information and cost.

WARRANTY

The supplier warrants that the product will not deteriorate under normal conditions and use. The warranty validity of one (1) year. Contact Technical Support for further information

MAINTENANCE

LATICRETE® products are of high quality designed to achieve lasting installations and avoid maintenance, however performance and durability may depend on properly maintaining products, depending of the cleaning products used.

TECHNICAL SERVICES

Technical assistance

For information contact us by email at: enquiry@laticrete.me

Technical and safety literature

To obtain technical and safety literature, please visit our website at: www.laticrete.me

Warning: The information and the instructions in the data sheet, although based on knowledge gained through years of applications, are indicative. LATICRETE® unable to directly control the installation conditions and modalities of application of products, do not assume any liability arising from their implementation. Those who want to use the LATICRETE® products must conduct adequate tests to determine the site specifications. Results shown are typical but reflect test procedures used. Actual field performance will depend on installation method and site conditions.