



325 Plus Premium Flexible Adhesive

Formerly known as 325 Plus Premium Adhesive, now rebranded as 325 Plus Premium Flexible Adhesive, this high-performance, polymer-modified, bagged cementitious powder combined with water to make a flexible premium adhesive for tile and stone installation using the thin-set method.



ADVANTAGES

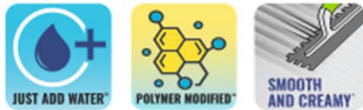

- Flexible - Smooth and creamy.
- Easy to apply - Ready to use just mix with water.
- Long open time.
- Water & heat resistant.
- Strong bond and durable.

USES

- Good bond to Ceramic tiles, Porcelain tile and Stones*.
- Recommended for wet areas such as bathrooms, kitchens etc.
- For exterior & interior floor / wall use.

*See limitations | Contact our technical service for more information.

MANUFACTURER

LATICRETE Middle East LLC.
P.O. Box. 86028, Ras Al Khaimah
United Arab Emirates
Toll Free (with in UAE) 800 5632
Telephone: + 971 7 244 6396
Fax: + 971 7 244 5915
www.laticrete.me

STANDARDS



Meets ANSI A 118.4, Euro Norms Standard (C2TE) ISO 13007 & EN 12004 requirements.

DCLD CERTIFIED



Please see the technical data

Packaging,

20 kg bags, 72 bags per pallet

Color: grey and white

Recommended surfaces

- Concrete
- Masonry
- Cement plaster and mortar
- Gypsum boards*
- Cement backer boards**

* Interior use only.

** Consult cement backerboard manufacturer for specific installation recommendations and to verify acceptability for exterior use.

Approximate Coverage for 20Kg bag.

Trowel notch size	Sqm.
6 mm x 6 mm	5.5 – 6.5
6 mm x 9 mm	5.0 – 6.0
12 mm x 12 mm	2.75 – 3.25

NOTE: Above coverage is intended as a guide, it may vary depending upon application technique, substrate profile/flatness, trowel angle, trowel wear and wastage factor. Actual coverage shall be determined by mockup area based on site conditions.

Shelf Life

Factory sealed containers of this product are guaranteed to be of first quality for one (1) year if stored off the ground on pallet in warehouse condition at 0 - 40°C , below 65% relative humidity. **High humidity will reduce the shelf life of bagged product.

Limitations

Adhesives/mastics, mortars and grouts for ceramic tile, pavers, brick and stone are not replacements for waterproof membranes. When a waterproof membrane is required, use a LATICRETE Waterproof Membrane.

Note: Surfaces must be structurally sound, stable and rigid enough to support ceramic/stone tile, thin brick and similar finishes. Substrate deflection under all live, dead and impact loads, including concentrated loads, must not exceed L/360 for thin bed ceramic tile/brick installations or L/480 for thin bed stone installations where L=spanlength.

Cautions

- Contains Portland cement and silica sand. May irritate eyes and skin. Avoid contact with eyes or prolonged contact with skin. In case of contact, flush thoroughly with water.
- Do not take internally. Avoid breathing dust. Wear a respirator in dusty areas.
- Keep out of reach of children.

TECHNICAL DATA**Certification/ Approvals**

DCLD: This product has been certified for Low Emitting Materials by Dubai Central Laboratory Department (DCLD) of Dubai Municipality. No.CL20020733: 2017 Al Sa'fat Dubai Green Building Evaluation System.

VOC/LEED Product Information

Total VOC Content grams/liter of product in unused form is <0.00 g/l.

Table-1: ANSI 118.4

Shear strength, Porcelaine tile		
1 day, Cl 7.2.2	0.5 Mpa (72.5 psi)	0.8 - 1.6 MPa
7 day, Cl 7.2.3	1.38 Mpa (200 psi)	1.5 - 2.0 MPa
Water immersion-7 days, Cl 7.2.4	1.03 Mpa (149 psi)	1.1 - 1.8 MPa
28 day, Cl 7.2.5	1.38 Mpa (200 psi)	1.4 - 1.8 MPa
Freeze thaw cycling- 28 days, Cl 7.2.6	1.21 Mpa (175.5 psi)	1.3 - 1.9 MPa

Table-2: EN 12004-2/ ISO 13007-2

Initial tensile adhesion strength	≥ 1.0 N/mm ²	1.2 - 2.2 N/mm ²
Tensile adhesion strength after water immersion	≥ 1.0 N/mm ²	1.1 - 2.0 N/mm ²
Tensile adhesion strength after heat ageing	≥ 1.0 N/mm ²	1.2 - 2.3 N/mm ²
Tensile adhesion strength after freeze– thaw cycles	≥ 1.0 N/mm ²	1.1 - 1.7 N/mm ²
Open time: tensile adhesion strength, 30 mins	≥ 0.5 N/mm ²	0.6 - 0.8 N/mm ²
Slip (T)	≤ 0.5 mm	Passes

Working Properties @ 25°C

Wet density	1.60 ± 0.10 g/cm ³
Open time	30 minutes
Pot life	2 Hrs.
Time to traffic	48 Hrs.

Specifications subject to change without notification. Results shown are typical but reflect test procedures used. Actual field performance will depend on installation methods and site conditions.

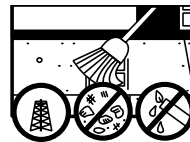
INSTALLATION**Surface Preparation**

All surfaces should be between 4° C to 35° C and structurally sound, clean and free of all dirt, oil, grease, loose peeling paint, laitance, concrete sealers or curing compounds. Rough or uneven concrete surfaces should be made smooth with LATICRETE® Latex Portland Cement underlayment to provide a wood float (or better) finish.

Dry, dusty concrete slabs or masonry should be dampened and excess water swept off. Installation may be made on a damp surface. All slabs must be plumb and true to within 6mm in 3m. Expansion joints shall be provided through the

tile work from all construction or expansion joints in the substrate. Follow ANSI Specification AN-3.8" Requirements for Expansion Joints" or TCA Details EJ171 "Expansion Joints". Do not cover expansion joints with mortars. Cement Backer Board; follow TCA installation detail W244.

Mixing

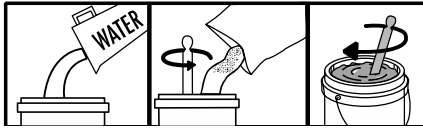

Place clean potable water into a clean pail. Add the powder of 325 Plus. Use approximately 4.2- 4.6 Liters of water for 20 Kg bag of powder. Mix by hand or with a slow speed mixer to a smooth, trowelable consistency. Allow mortar to slake for 5 – 10 minutes. Remix and apply with the proper sized notched trowel.

Application

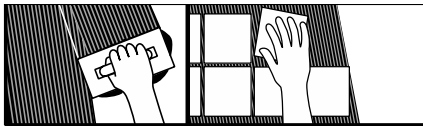

Apply mortar to the substrate with the flat side of the trowel, pressing firmly to work into surface. Comb on additional mortar with the notched side.

Note: Use the proper sized notched trowel to insure full bedding of the tile. Spread as much mortar as can be covered with tile in 15-20 minutes. Back butter large tiles (>8"x8") to provide full bedding and firm support. Place tiles into wet, sticky mortar and beat in using a beating block and rubber mallet to imbed tile and adjust level. Check mortar for complete coverage by periodically removing a tile and inspecting bedding mortar transfer onto back of tile. If mortar is skinned over (not sticky), remove and replace with fresh mortar.

Cleaning

Clean tools and tile work with water while mortar is fresh.

AVAILABILITY AND COST

Availability

LATICRETE® materials are available worldwide.

For distributor information,

please contact us by email at: enquiry@laticrete.me or, visit www.laticrete.me

Cost

Contact a LATICRETE® closer distributor to obtain complete information and cost.

The supplier warrants this product will not deteriorate under normal conditions and use, the warranty validity of one (1) year. The product subject to the terms and conditions stated in the LATICRETE® Product Warranty. Please consult our technical support for further information.

TECHNICAL SERVICES

Technical assistance

For information contact us by email at: enquiry@laticrete.me

Technical and safety literature

To obtain technical and safety literature, please visit our website at: www.laticrete.me

Warning: The information and the instructions in the data sheet, although based on knowledge gained through years of applications, are indicative. LATICRETE® unable to directly control the installation conditions and modalities of application of products, do not assume any liability arising from their implementation. Those who want to use the LATICRETE® products must conduct adequate tests to determine the site specifications. Results shown are typical but reflect test procedures used. Actual field performance will depend on installation method and site conditions.

WARRANTY