



# Tile & Stone Installation Systems

*Including Tile, Stone & Surface Care*  
Product Selection Catalog



Globally Proven Construction Solutions

**TILE & STONE SYSTEMS AND CARE SOLUTIONS**

Warranties ..... 4  
 Installation Systems ..... 5  
 Brand LATICRETE ..... 6-7  
 Customer Support/Social Media ..... 8  
 Technical Training and Seminars ..... 9  
**NEW Product Launch** ..... 10-13

**PLAZA & DECK SYSTEM**  
 Tile Drain Mat ..... 14

**UNCOUPLING MAT**  
 STRATA\_MAT™ ..... 15  
 STRATA\_MAT XT ..... 15

**SURFACE PREPARATION**  
**Underlayment**  
 NXT® Level Plus ..... 18  
 NXT Level Flow ..... 19  
 NXT Level ..... 19

**Overlay**  
**NEW** NXT Level SP ..... 20  
 NXT Level DL ..... 20

**Primers**  
 NXT Primer ..... 21  
 NXT Epoxy Primer ..... 21

**Repair**  
 NXT Patch ..... 22  
**NEW** Skim Lite ..... 22  
 NXT Embossing Admix ..... 23

**Tools**  
**NEW** Pro-Mix Station ..... 24  
 NXT Tool Kit ..... 24  
 LATICRETE® NIVCOMP™ Digital Level ..... 25  
 LATICRETE Elevation Pins ..... 25

**Moisture Control**  
 NXT Vapor Reduction Coating ..... 26  
 VAPOR BAN™ Primer ER ..... 26

**PREFORMED SHOWER SYSTEM AND DRAINS**  
 HYDRO BAN® Shower Pans ..... 27  
 HYDRO BAN Shower Pan Kits ..... 27  
 HYDRO BAN Pre-Sloped Shower Pan ..... 28  
 HYDRO BAN Linear Pre-Sloped Shower Pan ..... 28  
 HYDRO BAN Preformed Seats ..... 29  
 HYDRO BAN Preformed Niches ..... 29  
 HYDRO BAN Preformed Bench ..... 30  
 HYDRO BAN Board ..... 30  
 HYDRO BAN Board and Accessories ..... 31  
 HYDRO BAN Adhesive and Sealant ..... 31  
 HYDRO BAN Accessories ..... 32  
 HYDRO BAN Sheet Membrane Rolls ..... 32  
 HYDRO BAN Sealing Tape ..... 33  
 HYDRO BAN Preformed Corners ..... 33  
 HYDRO BAN Drain Collars and Seals ..... 34

HYDRO BAN Linear Drains ..... 35  
 HYDRO BAN Bonding Flange Drains ..... 36  
 HYDRO BAN Drain Grates ..... 36

**WATERPROOFING**  
**NEW** HYDRO BAN XP ..... 38  
 HYDRO BAN ..... 39  
 HYDRO BAN QUICK CURE  
 Waterproofing Membrane ..... 39  
 HYDRO BAN CEMENTITIOUS  
 Waterproofing Membrane ..... 40  
 9235 Waterproofing Membrane ..... 40  
**NEW** HYDRO BARRIER™ Plus ..... 41  
 LATAPOXY® Waterproof Flashing Mortar ..... 41  
 LATICRETE® Flashing Sealant ..... 42

**SOUND CONTROL/ANTI-FRACTURE**  
 Blue 92 Anti-Fracture Membrane and  
 Crack Suppression Kit ..... 42  
 FRACTURE BAN SC ..... 43  
 125 TRI MAX® ..... 43  
 170.3 Sound & Crack Isolation Mat ..... 44  
 170.5 Sound & Crack Isolation Mat ..... 44  
 FRACTURE BAN™ ..... 45  
 FRACTURE BAN Primer ..... 45

**FLOOR WARMING**  
 STRATA\_HEAT™ Mat ..... 49  
 STRATA\_HEAT Spliceless Wire ..... 49  
 STRATA\_HEAT Wire Spacing Strips ..... 50  
**NEW** STRATA\_HEAT Thermostats ..... 50  
 STRATA\_HEAT Thermal Pack ..... 51

**EPOXY ADHESIVES**  
 LATAPOXY 310 Stone Adhesive ..... 52  
 LATAPOXY 310 Cordless Mixer ..... 52  
 LATAPOXY BIOGREEN™ 300 Adhesive ..... 53  
 LATAPOXY 300 Adhesive ..... 53

**MULTIPURPOSE BONDING PRIMER**  
 PRIME-N-BOND™ ..... 56

**POLYMER FORTIFIED THIN-SET MORTARS**  
 257 TITANIUM™ ..... 56  
 254 Platinum ..... 57  
 254R Platinum Rapid ..... 57  
**NEW** Glass Tile Adhesive Lite ..... 58  
 253 Gold ..... 58  
 253R Gold Rapid ..... 60  
 252 Silver ..... 60

**NON-MODIFIED THIN-SET MORTARS**  
 272 Mortar ..... 61  
 317 Mortar ..... 61

**LATEX THIN-SET ADDITIVES**  
 333 Flexible Additive ..... 62

**MASTIC**  
 15 Premium Mastic ..... 62

**LARGE AND HEAVY TILE MORTARS**  
 MULTIMAX™ Lite ..... 63  
**NEW** TRI-LITE Rapid ..... 63  
 TRI-LITE™ ..... 64  
 4-XLT ..... 64  
 4-XLT Rapid ..... 65  
 LHT™ Plus ..... 65  
 LHT ..... 66

**MODULAR ADHESIVE SYSTEM**  
 LATICRETE® SELECT-BOND™ Adhesive ..... 66  
 LATICRETE SELECT-BOND Rapid Kits ..... 67  
 LATICRETE SELECT-BOND Non-Sag Kits ..... 67  
 LATICRETE SELECT-BOND  
 High Performance Kits ..... 67

**PREMIUM MORTAR BEDS**  
 3701 Lite Mortar ..... 68  
 3701 Lite Mortar R ..... 68  
 Quick Cure Mortar Bed ..... 70  
 3701 Fortified Mortar Bed ..... 70  
 3701 Mortar Admix and 226 Thick Bed Mortar ..... 71  
 209 Floor Mud ..... 71

**CEMENTITIOUS GROUTS**  
 PERMACOLOR® Select Color Kit ..... 74  
 PERMACOLOR Select Base ..... 74  
 PERMACOLOR Select NS Grout Base ..... 75  
 PERMACOLOR Grout^ ..... 76  
 1500 Sanded Grout ..... 77  
 1600 Unsanded Grout ..... 77

**EPOXY GROUTS**  
 SPECTRALOCK® PRO Premium  
 Translucent Grout† ..... 78  
 SPECTRALOCK PRO Premium Grout ..... 78  
 SPECTRALOCK DAZZLE™ Part D Component ..... 79  
 SPECTRALOCK PRO Grout ..... 80  
 SPECTRALOCK Grout Part C Powders ..... 80

**PRE-MIXED GROUTS**  
 SPECTRALOCK 1 ..... 81  
 READY-TO-USE™ GROUT ..... 81

**EPOXY GROUTS/CAULK**  
 SPECTRALOCK 2000 IG ..... 82  
 Premium Acrylic Caulk ..... 82

**SEALANT**  
 LATASIL™ ..... 83  
 LATASIL 9118 Primer ..... 83

**GROUT AND SEALANT COLOR CHART** ..... 84  
**GROUT COVERAGE CHARTS** ..... 85-87

## TILE & STONE SYSTEMS AND CARE SOLUTIONS

### SEALERS

STONETECH® BulletProof® Sealer .....	90
STONETECH Heavy Duty Sealer .....	90
STONETECH Stone, Tile & Grout Sealer.....	91
STONETECH Impregnator Pro® Sealer .....	92
STONETECH Quartz & Porcelain Tile Sealer .....	92
STONETECH Salt Water Resistant Sealer.....	93
STONETECH Heavy Duty Exterior Sealer .....	93
STONETECH Heavy Duty Grout Sealer .....	94
STONETECH Grout Release.....	95
STONETECH Stain Protecting Grout Additive .....	95

### CLEANERS

STONETECH Revitalizer® Cleaner & Protector .....	96
STONETECH Stone & Tile Cleaner .....	96
STONETECH Quartz & Tile Cleaner.....	97
<b>NEW</b> STONETECH Luxury Vinyl & Laminate Cleaner .....	97
STONETECH Stainless Steel Pro Cleaner †.....	98
STONETECH Mold & Mildew Stain Remover †.....	98
STONETECH Soap Scum Remover †.....	99
STONETECH DeepKlenz™ Cleaner † .....	99
STONETECH KlenzAll™ Cleaner .....	100
STONETECH Restore™ Acidic Cleaner .....	100
STONETECH Epoxy Grout Haze & Coating Stripper <b>Gel</b> †.....	101
STONETECH Oil Stain Remover.....	102

### ENHANCERS/RESTORATION

STONETECH Stone Polish.....	102
STONETECH Enhancer Pro™ Sealer .....	103
STONETECH Enhancer & Sealer .....	103
STONETECH High Gloss Finish & Sealer.....	104
STONETECH Semi Gloss Finish & Sealer.....	104
STONETECH Honing Powder.....	105
STONETECH Polishing Powder.....	105

### SPECIALTY KITS

STONETECH Countertop Warranty Care Kit.....	106
---	-----

# LATICRETE OFFERS THE BEST SYSTEM WARRANTIES IN THE INDUSTRY

## Unmatched Peace of Mind

LATICRETE takes pride in delivering comprehensive system warranty packages and superior service through industry-leading support. With training from our highly experienced technical support team and quick, easy access to supportive online tools, we provide everything you need to ensure high-performance solutions.



<b>Lifetime System Warranty</b> See Data Sheet 230.99 for complete warranty information.	
APPLICATION	PRODUCTS
<b>Underlayment</b>	NXT® Primer NXT Level Plus
<b>Floor Warming<sup>^</sup></b>	STRATA_HEAT™ Spliceless Wire STRATA_HEAT Mat STRATA_HEAT Thermal Pack ††4-XLT with STRATA_HEAT Thermal Packs
<b>Waterproofing/ Anti-Fracture</b>	HYDRO BAN® 9235 Waterproofing Membrane
<b>Waterproofing</b>	HYDRO BAN Sheet Membrane HYDRO BAN Quick Cure
<b>Shower System</b>	HYDRO BAN Pre-Sloped Shower Pan (and applicable accessories) HYDRO BAN Linear Pre-Sloped Shower Pan (and applicable accessories) HYDRO BAN Shower & HYDRO BAN Shower Kits (and applicable accessories) HYDRO BAN Linear Drain (and applicable accessories) HYDRO BAN Bonding Flange Drain (and applicable accessories) HYDRO BAN Board (and applicable accessories) 4-XLTΔ
<b>Uncoupling</b>	STRATA_MAT™, STRAT_MAT XT
<b>Substrate Primer</b>	PRIME-N-BOND™
<b>Thick Bed Mortar</b>	3701 Fortified Mortar Bed 3701 Lite Mortar OR 3701 Lite Mortar R Quick Cure Mortar Bed
<b>Slurry Bond Coat</b>	254 Platinum 257 TITANIUM™
<b>Thin Bed Method</b>	254 Platinum (regular or rapid version) 257 TITANIUM LATAPOXY® 300 Adhesive OR BIOGREEN™ 300
<b>Large, Heavy Tile Method</b>	MULTIMAX™ Lite
<b>Grout</b>	SPECTRALOCK® PRO Premium Grout SPECTRALOCK PRO Grout SPECTRALOCK 1 Pre-Mixed Grout PERMACOLOR® Select
<b>Sealant†</b>	LATASIL™ LATASIL 9118 Primer

<b>25 Year System Warranty</b> See Data Sheet 025.0 for complete warranty information.	
APPLICATION	PRODUCTS
<b>Underlayment</b>	NXT® LEVEL PLUS SUPERCAP® SC500 Plus
<b>Primer</b>	NXT PRIMER SUPERCAP Primer Plus PRIME-N-BOND™
<b>Floor Warming<sup>^</sup></b>	STRATA_HEAT Spliceless Wire STRATA_HEAT STRATA_HEAT Thermal Pack ††4-XLT with STRATA_HEAT Thermal Packs
<b>Vapor Reduction</b>	VAPOR BAN™ Primer ER NXT Vapor Reduction Coating
<b>Waterproofing/Anti-Fracture</b>	HYDRO BAN 9235 Waterproofing Membrane HYDRO BAN CEMENTITIOUS Waterproofing Membrane
<b>Exterior Veneer Waterproofing/ Anti-Fracture</b>	LATAPOXY Waterproof Flashing Mortar
<b>Waterproofing</b>	HYDRO BAN Sheet Membrane LATAPOXY Waterproof Flashing Mortar HYDRO BAN Quick Cure
<b>Shower System</b>	HYDRO BAN Pre-Sloped Shower Pan (and applicable accessories) HYDRO BAN Linear Pre-Sloped Shower Pan (and applicable accessories) HYDRO BAN Shower & HYDRO BAN Shower Kits HYDRO BAN Linear Drain (and applicable accessories) HYDRO BAN Bonding Flange Drain (and applicable accessories) HYDRO BAN Board (and applicable accessories) 4-XLTΔ
<b>Sound Control/Anti-Fracture</b>	125 TRIMAX® 170.3 OR 170.5 Sound & Crack Isolation Mat FRACTURE BAN™ 40 OR 90 FRACTURE BAN Primer
<b>Plaza &amp; Deck</b>	Plaza and Deck System
<b>Uncoupling</b>	STRATA_MAT, STRATA_MAT XT
<b>Thick Bed Method</b>	3701 Fortified Mortar Bed 3701 Lite Mortar / 3701 Lite Mortar R Quick Cure Mortar Bed
<b>Slurry Bond Coat</b>	257 TITANIUM™ 254 Platinum
<b>Thin Bed/Adhesive Method</b>	257 TITANIUM 254 Platinum (regular or rapid version) LATAPOXY 300 Adhesive OR BIOGREEN™ 300 Glass Tile Adhesive Lite LATICRETE® SELECT-BOND™ (+ High Performance [ANSI A118.15] Kit)
<b>Large, Heavy Tile Method</b>	MULTIMAX™ Lite TRI-LITE™
<b>Spot Bonding</b>	LATAPOXY 310 Stone Adhesive—Standard and Rapid Grade
<b>Grouting</b>	SPECTRALOCK PRO Premium Grout (non-industrial applications) SPECTRALOCK PRO Grout (non-industrial applications) SPECTRALOCK 1 Pre-Mixed Grout PERMACOLOR® Grout PERMACOLOR Select
<b>Sealant†</b>	LATASIL LATASIL 9118 Primer

† Use of suitable flexible sealant is required per Tile Council of North America Detail E1171 for use in expansion joints, covers, corners, changes in plane and other joints or wherever tile or stone abuts dissimilar materials or restraining surfaces.  
 Δ 4-XLT for use to install HYDRO BAN® Pre-Sloped Shower Pans to substrate only.  
<sup>^</sup> Floor Warming Thermostat and STRATA\_HEAT™ Thermostat sold by LATICRETE warrants parts and materials for one (1) year from the date of purchase. The sole remedy for the Floor Warming Thermostats and STRATA\_HEAT Thermostats is product replacement (see Data Sheet 230.13 for full details on the LATICRETE® Product Limited Warranty).  
 ††4-XLT with STRATA\_MAT Thermal Packs when used as a large & heavy tile adhesive mortar.

Consult our website at [www.laticrete.com](http://www.laticrete.com) for the most current versions of product data sheets, warranties, and SDS. Content of this brochure is for informational purposes only. Refer to individual product data sheets and warranties for complete information. Refer to individual product data sheets and warranties for complete information.  
<sup>^</sup>United States Patent No.: 6,784,229 B2 (and other Patents). <sup>Δ</sup>United States Patent No.: 6,881,768 (and other Patents).

**LATICRETE Offers a Complete System Solution for Virtually Every Tile and Stone Application.**  
 For more than half a century architects, engineers, and developers have trusted LATICRETE with their tile and stone installation needs. Let our experience, product quality, and technical support assist you on your next project — whatever the application.

LATICRETE has successfully provided the technology for innovative, permanent installations of tile and stone finishes. Architecturally specified and preferred by professional installers, LATICRETE provides solutions for virtually every application.

- LATICRETE® products are industry accepted, code approved, and backed by 100% labor and materials system warranties, thereby assuring a successful installation each and every time
- LATICRETE membranes, adhesives, grouts, and sealants are weather-resistant and freeze/thaw stable when cured

**SOUND CONTROL AND ANTI-FRACTURE**

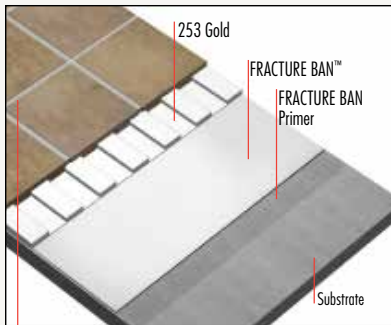

SPECTRALOCK® PRO Premium Grout† or PERMACOLOR® Select^

**WALLS AND FACADES**

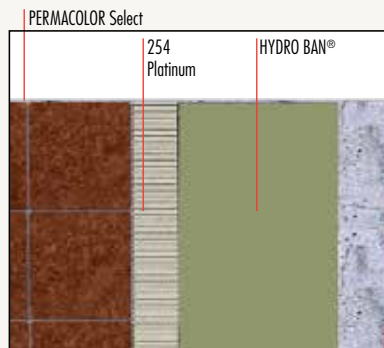

Properly prepared concrete, backer board, or masonry substrates (if substrate requires leveling, use 3701 Fortified Mortar)

**PREFORMED SHOWER**



4-XT HYDRO BAN Pre-Sloped Shower Pan

**COMMERCIAL AND INDUSTRIAL FLOORS AND WALLS**

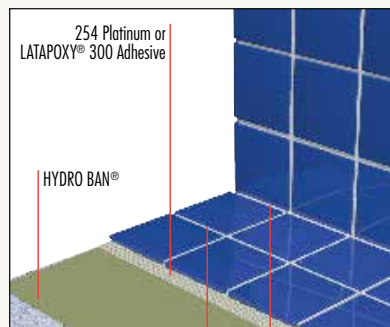

SPECTRALOCK® 2000 IG LATASIL™

**WET AREAS AND CONTINUOUS UNDERWATER SUBMERSION**

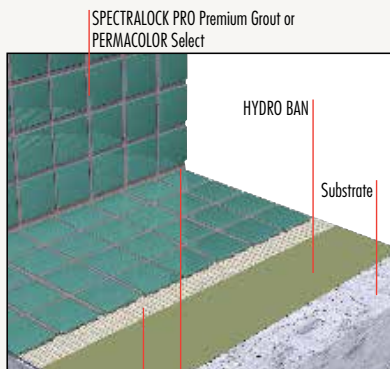

254 Platinum LATAFIL™

**PLAZA & DECK**

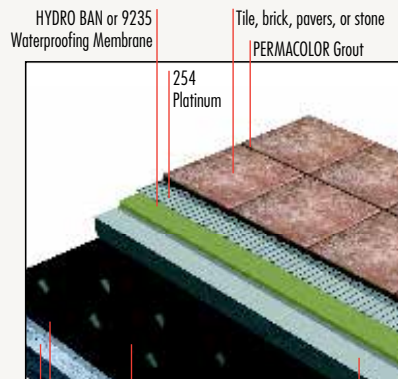

Tile Drain Mat 3701 Fortified Mortar with wire-reinforcing Primary roof waterproofing membrane Structural concrete deck, properly pitched

**UNCOUPLING MAT**

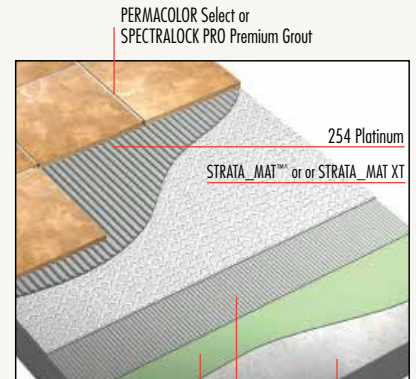

HYDRO BAN (if waterproofing is required) 254 Platinum Concrete

Consult our website at [laticrete.com](http://laticrete.com) for the most current versions of product data sheets, warranties, and SDS sheets. Content of this brochure is for informational purposes only. Refer to individual product data sheets and warranties for complete information. ^United States Patent No.: 6,784,229 B2 (and other Patents). †United States Patent No.: 6,881,768 (and other Patents). †NOTE: Not available for sale in Canada.

For over 65 years, LATICRETE has led the industry with pioneering advancements — developing high-performance building materials for architects and construction professionals worldwide. From time-tested to ground-breaking, our broad product portfolio provides superior quality and value. We are fully committed to innovation, growth, and a complete system component approach.



## **Tile & Stone Installation and Care Systems**

Ensure a successful installation each and every time with the most comprehensive assortment of innovative tile and stone installation materials available worldwide. LATICRETE® industry-leading products provide complete system solutions from the substrate up through the grout for virtually any type of tile or stone installation in commercial, industrial, and residential applications.

Product categories include surface preparation, waterproofing, sound control, anti-fracture, adhesives, grouts, sealers and cleaners, and shower system components — all designed to work together, providing a comprehensive installation.

**CSI Division 9**

## **Masonry Installation and Care Systems**

Keep up with the increasing popularity of adhered masonry veneers. Trust your installations to a complete productivity-boosting system designed to deliver superior, long-term performance on masonry projects of all types including residential, commercial, and industrial applications.

Unlike traditional methods and materials, the Masonry Veneer Installation System (MVIS™) is engineered to provide a permanent, high-strength installation that uses a revolutionary waterproofing air and water barrier membrane to provide a barrier against air and water penetration into the structure. The MVIS is designed for thin-brick, manufactured stone and natural stone veneers for interior and exterior applications. Complementary products include sealers and cleaners for stone and pavers.

**CSI Divisions 4 & 7**

## **Resinous/Decorative Finishes**

Offer unparalleled integral colors, textures, and finishes with high-performance coatings, overlayments, and restoration solutions that give owners exceptionally attractive, durable, decorative floors. LATICRETE decorative finishes allow you to deliver vivid color and gloss with high impact and wear resistance, quick turnaround, and low maintenance.

**CSI Divisions 3 & 9**



## Concrete Construction Chemicals

Improve the long-term durability, performance, and appearance of concrete surfaces with our complete line of protection and repair solutions. Curing and sealing treatments, floor hardeners and densifiers, polished concrete systems, and stain protection products work together to ensure your concrete floor is safe, resilient, and easy to maintain.

CSI Division 3

## Surface Preparation

A quality finished floor starts with a properly prepared surface—one that guarantees a long-lasting, durable installation. LATICRETE time-tested surface preparation products are formulated to preserve quality by protecting installations from water vapor transmission, sound transmission, and cracks. They provide a perfectly level substrate to accommodate a variety of floor finishes including vinyl, wood, carpet, and tile.

Our innovative products are engineered to ensure substrates will easily accept finishes with minimal time and maximum cost-effectiveness, no matter how challenging your subflooring project may be.

CSI Divisions 3 & 9

## SUPERCAP® System

The SUPERCAP® System is a time-saving, cost-effective method for finishing new concrete or capping existing slabs by combining a LEED-contributing, UL GREENGUARD Gold Certified, low-alkali, self-leveling, cement-based technology with a patented computer-controlled mobile blending unit (pump truck).

This proven Lean tool provides benefits right from the start of concrete placement in division 3 and flows through to division 9. With the ability to blend 30,000 pounds (13,608 kg) per hour and deliver material up to 50 stories high, this revolutionary system benefits the entire project by providing predictable results that save time and money, and while improving overall quality.

CSI Division 3 & 9

## Industry-Leading Training and Support

### UL GREENGUARD Gold Certification

LATICRETE® low-VOC products are independently certified. Our products help you contribute toward LEED certification.



### LEED Support

Our online project certification tool automatically generates required LATICRETE product information for your specific LEED project submittals. Additional LEED information and calculations are available at [laticrete.ecoscorecard.com](http://laticrete.ecoscorecard.com).



### LATICRETE Architectural Guidebook

Use this informative online tool to get complete specifications and details for your projects. You can access it at: [www.laticrete.com/ag](http://www.laticrete.com/ag)

### Training and Education

LATICRETE Training Classes and Continuing Education Classes are available through various platforms. Check our website regularly for the latest offerings and updates at: [www.laticrete.com/training](http://www.laticrete.com/training).

**LATICRETE provides you with online access to the latest in sales and marketing tools.**

Simply visit [www.laticrete.com](http://www.laticrete.com) to download the latest LATICRETE marketing support tools, and technical design manuals or request a hard copy at [www.laticrete.com/tools](http://www.laticrete.com/tools).



**Social Media**

Like and Follow LATICRETE on social media and...

- Be the first to know about product announcements
- Hear the latest industry news
- Discover installation tips
- Find product training near you
- Win great swag

Follow us on Facebook, Twitter, LinkedIn, Instagram



NOW AVAILABLE ONLINE



<p><b>PRODUCT AND PROCESS</b></p>	<p><b>CONTRACTORS</b></p>	<p><b>DISTRIBUTORS</b></p>
<p><b>INDUSTRY</b></p>		
<p><b>DESIGNERS</b></p>	<p><b>CHARITABLE</b></p>	<p><b>GREEN</b></p>



# Learn Industry Standards from Experts in the Field and from the Comfort of your Home or Office.

LATICRETE offers intensive training programs that were specifically developed for industry distributors, dealers and other industry professionals. Programs are offered through multiple platforms:

- LATICRETE Profit Through Knowledge (PTK) classes held at LATICRETE Technical Training Centers throughout the US (in person training classes through LATICRETE Technical Services)
- LATICRETE Profit Through Knowledge Webinars
- LATICRETE Connectados & Connectados PLUS Global Training Webinars
- LATICRETE University
- LATICRETE Product Knowledge (PK) seminars are available locally through your LATICRETE Technical Sales Representatives. Contact your local LATICRETE Technical Sales Representative for additional information.

Check [www.laticrete.com/training](http://www.laticrete.com/training) for more information.

## BENEFITS

- Expand knowledge of how to select and recommend the most suitable installation materials
- Increase knowledge of LATICRETE® products
- Learn trade definitions, performance requirements, and industry standards
- Learn how to solve and avoid job problems
- Participate in hands-on product demonstrations

## SEMINAR LOCATION

LATICRETE Technical Training Centers are located throughout the US at various LATICRETE office locations. Check our web site regularly for class information and locations.

## PROGRAM INCLUDES

Tile, Stone, Masonry Veneer Installation Systems, Resinous Flooring, Surface Preparation and Construction Chemical industry installation methodology and respective LATICRETE Product knowledge installation training conducted by the LATICRETE Technical Services Department. Experienced instructors use classroom instruction, hands-on product demonstrations and virtual tools to provide the latest LATICRETE installation and product training.

## LEARN ONLINE AT YOUR LEISURE

LATICRETE is proud to announce its new eLearning program, LATICRETE UNIVERSITY.

LATICRETE UNIVERSITY makes it possible for anyone within the industry to train on industry standards and Profit Through Knowledge (PTK) Technical Seminars from the comfort of their home or office. Training has become necessary to learn about new products and modern technology. Traveling and leaving your business behind to attend training is not always easy or possible. Now anyone in your company can receive the quality information, previously possible only during live training sessions, within a short period of time and without leaving the job for an extended period of time.

LATICRETE UNIVERSITY presents vital industry and product information in short, easy segments that can be taken at any time, 24/7.

Here's how it works:

1. You listen to and observe a short tutorial.
2. You take a short test that will measure your knowledge retention.
3. Upon the successful completion of a segment, you print a certificate or have it emailed to you for your employee training records.

Note – You can pause and resume your training at any time. You can re-take training to sharpen your knowledge.

To access the LATICRETE UNIVERSITY, go to [www.laticrete.com/training](http://www.laticrete.com/training), create a user profile and begin your training.



For further information, log onto [www.laticrete.com/training](http://www.laticrete.com/training), or contact LATICRETE at +1.203.393.0010, ext. 1235



# NEW PRODUCTS

## NXT® Level SP

This white cement-based, low-alkali material is designed to be installed as a corrective, decorative wear surface that is incredibly durable. Simply pump or pour this self-leveling product and polish the surface exposing the medium/course aggregate resulting in a beautiful floor with a salt and pepper appearance.



AnyColor™



## Pro-Mix Station

The Pro-Mix Station is a heavy-duty mobile cart that creates efficiencies on the job site by optimizing your productivity. Prep, mix and pour all-in-one station. The Pro-Mix Station can be used with an extensive array of LATICRETE® products such as self-leveling underlayment, overlays, and epoxies.



# STRATA\_HEAT™ Thermostats

The STRATA\_HEAT™ Floor Warming System receives an upgrade with two new Thermostats. The Wi-Fi Thermostat offers a digital readout with a minimalist design, while the Smart LCD Wi-Fi Thermostat provides a full-color, capacitive touch screen that works like smartphones and tablets. Both versions can be controlled through the STRATA\_HEAT app on your favorite smart device or most home automation hubs, providing real-time information for optimal control.



\* Wi-Fi Thermostat Only



## TRI-LITE™ Rapid

The popular TRI-LITE™ tri-purpose mortar is now available in a fast-setting version, TRI-LITE Rapid. This lightweight, high-performance mortar is designed for Large and Heavy Tile, thin-bed and wall installations with superior non-sag performance. TRI-LITE Rapid is packaged in a 27.5 lb (12.5 kg) bag, providing the same coverage as a 50 lb (22.7 kg) bag of standard mortar. TRI-LITE Rapid contains no respirable crystalline silica levels that exceed the OSHA action level\*.



\*OSHA action level set forth in OSHA's Respirable Crystalline Silica (RCS) standard for construction, 29 CFR 1926.1153, as tested by an independent laboratory to be below the OSHA action level for respirable crystalline silica – see [laticrete.com/silica](http://laticrete.com/silica)



*Natural*  
Calming  
and Sophisticated



*Earthy*  
Grounding  
and Charming



*Coastal*  
Dramatic  
and Tranquil

# NEW Grout and Sealant Colors

Inspired by the environment, the LATICRETE® grout color palette has been updated with new colors and categorized into three themes — Natural, Earthy and Coastal.

These seven NEW colors will be available in the following grouts and sealants:

- PERMACOLOR®
- PERMACOLOR Select
- SPECTRALOCK® PRO
- SPECTRALOCK PRO Premium
- SPECTRALOCK 1
- READY-TO-USE™
- LATASIL®
- Premium Acrylic Caulk

We will discontinue the following seven colors. These colors will remain available through the PERMACOLOR® Select AnyColor™ Program.

- 16 Siltstone
- 38 River Rock
- 41 Kashmir
- 43 Chocolate Truffle
- 50 Sea Glass
- 55 Tawny
- 92 Saltillo

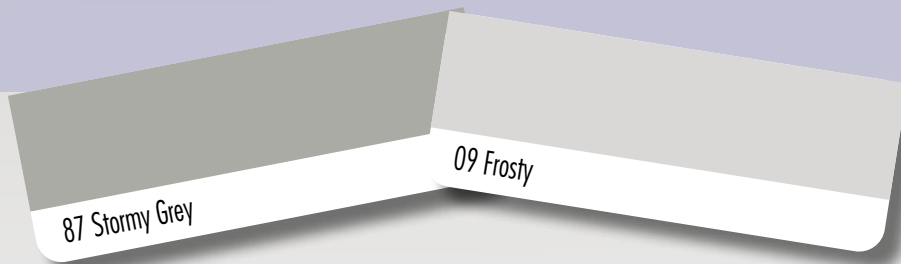

Color samples are guides only. LATICRETE does not warrant color matching to this brochure or to any color guide produced. Actual performance and appearance related characteristics as intended for use will depend on job site conditions, lighting, installation techniques and may vary from this brochure, color samples and color swatch on product packaging. Verify actual appearance and compatibility with a mock-up or field test area before installing. No claims for color shade variations will be honored.



**TILE DRAIN MAT**

Refer to Data Sheet 290.0

9100-0200-2

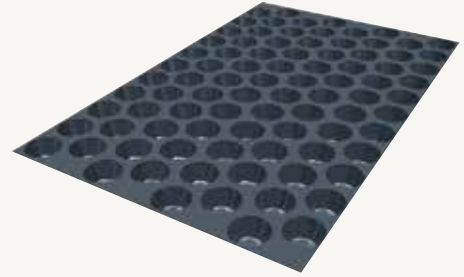

A component of the Plaza and Deck System, this lightweight subsurface mat drains infiltrated water and reduces the potential for mineral deposits.

**FEATURES/BENEFITS:**

- Provides three times the drainage rate of a conventional 2" (50 mm) crushed gravel bed
- Extra Heavy service rating per ASTM C627 (TCNA)

**PACKAGING:**

200 ft<sup>2</sup> (19 m<sup>2</sup>)

6 rolls per pallet

30 lbs/roll (13.6 kg/roll),

230 lbs/pallet (104.3 kg/pallet)

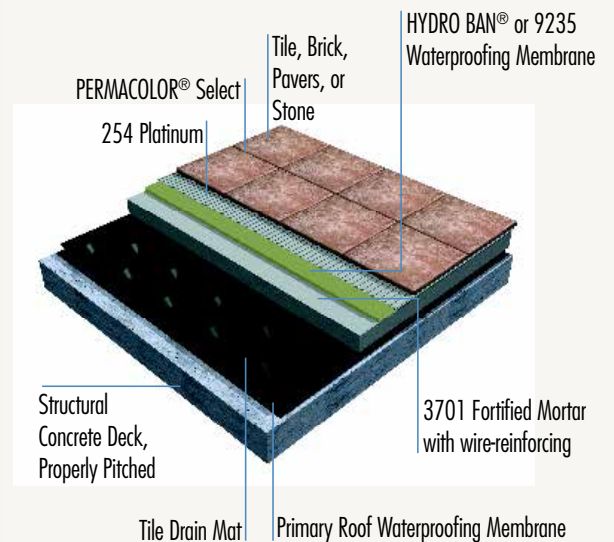

**STRATA\_MAT™**

Refer to Data Sheet 026.0

0177-0323-2 / 0177-0150-2 / 0177-1010-2



**STRATA\_MAT XT**

Refer to Data Sheet 028.0

0177-0150-XT



The Next Generation Uncoupling Mat for use under residential and commercial ceramic tile and stone installations, replacing traditional underlayment materials. Enhances the mechanical bond of adhesive mortar for faster drying and shorter wait times for grouting. Available in the standard STRATA\_MAT™ 1/8" (3 mm) version and STRATA\_MAT XT 5/16" (8 mm) thickness. Use STRATA\_MAT XT when installing typical 1/4" to 3/8" (6 to 9 mm) thick tile adjacent to 3/4" (19 mm) hardwood flooring.

**FEATURES/BENEFITS:**

- Eliminates transmission of in-plane substrate cracks of up to 1/8" (3 mm)
- Lightweight, easy to carry, and fast to install with standard tools
- Use the appropriate mortar for the tile; polymer modified or unmodified mortar
- Moisture Sensitive Tile and Stone, allows for installation of green marble and moisture sensitive stones with LATAPOXY® 300 thin-set mortar

**PACKAGING FOR STRATA\_MAT:**

- 323 ft<sup>2</sup> roll — 45" x 86' (30 m<sup>2</sup> — 1.1 m x 26.2 m)  
12 rolls per pallet
- 150 ft<sup>2</sup> roll — 45" x 40' (13.9 m<sup>2</sup> — 1.1 m x 12.2 m)  
20 rolls per pallet
- 10 ft<sup>2</sup> sheet — 10 ft<sup>2</sup> (0.9 m<sup>2</sup>) —  
45" x 32" (1.14 m x 0.8 m)

**PACKAGING FOR STRATA\_MAT XT:**

- 150 ft<sup>2</sup> roll — 45" x 40' (13.9m<sup>2</sup> — 1.1m x 12.2 m)  
6 rolls per pallet

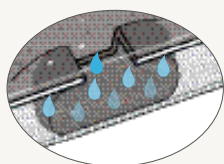

**Mortar Hydration Vents**

Accelerates thin-set curing for faster dry time of porcelain and larger format tiles — grout the next day

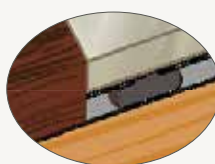

**STRATA\_MAT XT**

At 5/16" (8 mm) thick STRATA\_MAT XT creates an even transition between typical 1/4" to 3/8" (6 to 9 mm) thick tile and 3/4" (19 mm) thick hardwood flooring.

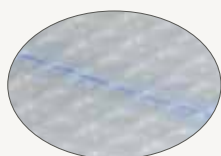

**Easy Layout**

Chalk lines are easily visible

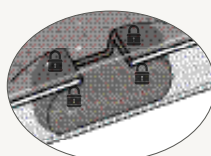

**Mechanical Bond**

Thin-set mortar forms a mechanical bond to STRATA\_MAT™ surface for greater strength



**Instant Coverage Verification**

Translucent color indicates proper mortar coverage



<sup>©</sup> United States Patent No.: 9,016,018B2 (and other Patents).







## Surface Preparation

A quality finished floor starts with a properly prepared surface — one that guarantees a long-lasting, durable installation. LATICRETE® time-tested surface preparation products are formulated to preserve quality. They provide a perfectly level substrate to accommodate a variety of floor finishes including vinyl, wood, carpet, and tile.

### NXT® LEVEL PLUS

Refer to Data Sheet 505.0

0902-0055-21



A high quality, cement-based, fiber reinforced, free-flowing underlayment for use in leveling wide variety of interior substrates including concrete, plywood, OSB and more. Rapid setting formula produces a flat, smooth and hard surface for the installation of finished flooring as soon as 12 hours.

#### FEATURES/BENEFITS:

- Suitable surface for most floor goods as soon as 12 hours
- Can be applied from 1/8" to 1-1/4" and tapered to zero at edges on concrete substrates
- Can be applied from 1/4" to 1-1/4" on wood substrates
- Can be applied over plywood, Gypsum and OSB without the use of a metal lath
- Low-shrinkage
- High compressive strengths 5300 psi (36.5 MPa)
- Suitable surface for most finished floor goods
- Can be applied directly over concrete at RH of 100% or less per ASTM F2170
- Pumpable

#### PACKAGING:

55 lb (25 kg) bag; 56 bags per pallet

#### Approximate Coverage

Thickness	Coverage
1/8" (3 mm)	49 ft <sup>2</sup> (4.6 m <sup>2</sup> )
1/4" (6 mm)	24 ft <sup>2</sup> (2.3 m <sup>2</sup> )
1/2" (12 mm)	12 ft <sup>2</sup> (1.1 m <sup>2</sup> )
3/4" (18 mm)	8.1 ft <sup>2</sup> (0.8 m <sup>2</sup> )
1" (25 mm)	6.1 ft <sup>2</sup> (0.6 m <sup>2</sup> )
1-1/4" (32 mm)	4.9 ft <sup>2</sup> (0.5 m <sup>2</sup> )



**NXT LEVEL**

Refer to Data Sheet 504.0  
0900-0050-21/0900-0050-21-DL\* /0900-2200-21



**NXT LEVEL FLOW**

Refer to Data Sheet 36623  
0903-0050-21



A cement-based underlayment for use in leveling interior substrates. Produces a flat, smooth, hard surface for installation of finished flooring.

**FEATURES/BENEFITS:**

- Can be placed from 1/8 – 3" (3 – 76 mm) in a single lift
- Pourable and pumpable
- Suitable surface for most floor goods as soon as 24 hours
- Inorganic; will not contribute to mold/mildew growth

**PACKAGING:**

50 lb (22.7 kg) bag; 56 bags per pallet  
2,200 (998 kg) Supersack

Approximate Coverage	
Thickness	Coverage
1/8" (3 mm)	44.0 ft <sup>2</sup> (4.1 m <sup>2</sup> )
1/4" (6 mm)	22.0 ft <sup>2</sup> (2.0 m <sup>2</sup> )
3/8" (10 mm)	14.7 ft <sup>2</sup> (1.4 m <sup>2</sup> )
1/2" (12 mm)	11.0 ft <sup>2</sup> (1.0 m <sup>2</sup> )
5/8" (16 mm)	8.8 ft <sup>2</sup> (0.8 m <sup>2</sup> )
3/4" (19 mm)	7.3 ft <sup>2</sup> (0.6 m <sup>2</sup> )
7/8" (22 mm)	6.3 ft <sup>2</sup> (0.6 m <sup>2</sup> )
1" (25 mm)	5.5 ft <sup>2</sup> (0.5 m <sup>2</sup> )
2" (51 mm)	2.7 ft <sup>2</sup> (0.3 m <sup>2</sup> )
3" (76 mm)	1.9 ft <sup>2</sup> (0.2 m <sup>2</sup> )

A cement-based, pump friendly, high flowing ,easy-to-use underlayment for use in leveling interior substrates. NXT® Level Flow produces a flat, smooth and hard surface for the installation of finished flooring.

**FEATURES/BENEFITS:**

- High flowing and easy-to-use
- Can be placed from 1/8" to 2"
- Pourable and pumpable
- Inorganic; will not contribute to mold/mildew growth
- Suitable surface for most finished floor goods as soon as 48 hours
- Can be applied directly over concrete testing at RH of 100% or less per ASTM F2170

**PACKAGING:**

50 lb (22.7 kg) bag; 56 bags per pallet

Approximate Coverage	
Thickness	Coverage
1/8" (3 mm)	44.0 ft <sup>2</sup> (4.1 m <sup>2</sup> )
1/4" (6 mm)	22.0 ft <sup>2</sup> (2.0 m <sup>2</sup> )
3/8" (10 mm)	14.7 ft <sup>2</sup> (1.4 m <sup>2</sup> )
1/2" (12 mm)	11.0 ft <sup>2</sup> (1.0 m <sup>2</sup> )
5/8" (16 mm)	8.8 ft <sup>2</sup> (0.8 m <sup>2</sup> )
3/4" (19 mm)	7.3 ft <sup>2</sup> (0.6 m <sup>2</sup> )
7/8" (22 mm)	6.3 ft <sup>2</sup> (0.6 m <sup>2</sup> )
1" (25 mm)	5.5 ft <sup>2</sup> (0.5 m <sup>2</sup> )
2" (51 mm)	2.7 ft <sup>2</sup> (0.3 m <sup>2</sup> )



\*NXT® Level is also available in version with new DUST LOCK™ Technology, dramatically reducing onsite dust during transportation of the product as well as while mixing. Special order item. Please contact your LATICRETE Technical Sales Representative.

**NXT® LEVEL SP**

Refer to Data Sheet 35609  
 Grey: 9600-0050-21  
 White: 9601-0050-22



**NXT LEVEL DL**

Refer to Data Sheet 029.2  
 Grey: 0907-0055-21/0907-2200-21  
 White: 0908-0055-22/0908-2200-22



NXT® Level SP is a pourable, high performing self-leveling concrete topping, primarily used to finish interior concrete slabs. As a high-strength wear surface when polished. NXT Level SP provides a low maintenance, durable solution with an attractive, coarse salt and pepper look. It is applied over concrete and other sound substrates. With an unmatched ability to level uneven floor surfaces, NXT Level SP can be used in the most challenging situations.

**FEATURES/BENEFITS:**

- Available in standard colors of Grey and White (vibrant white)
- Can be tinted to coordinate with interior finishes or branding designs through our – AnyColor™ custom color program
- Full system availability with L&M™ and STONETECH® products
- Provides a durable, attractive and low maintenance cementitious wear-surface grade concrete overlayment, suitable for polishing to various shine levels
- Transforms rough concrete to a flat and smooth surface perfect for a polished concrete look
- Polishable to a finished wear-surface in as little as 24 hours
- Self-leveling concrete overlayment formula is both pourable and pumpable

**PACKAGING:**

50 lb (22.7 kg) bag; 56 bags per pallet

Approximate Coverage	
Thickness	Coverage
1/4" (6.4 mm)	20 ft <sup>2</sup> (1.9 m <sup>2</sup> )
1/2" (12.7 mm)	10 ft <sup>2</sup> (0.9 m <sup>2</sup> )
3/4" (19.1 mm)	5.8 ft <sup>2</sup> (0.5 m <sup>2</sup> )
1" (25.4 mm)	4.7 ft <sup>2</sup> (0.4 m <sup>2</sup> )
2" (50.8 mm)	2.3 ft <sup>2</sup> (0.2 m <sup>2</sup> )

NXT Level DL (Decorative Leveler) is a polishable cement-based, high quality, fast drying, self-leveling, monolithic, interior wear surface topping that can be accented with a wide variety of coloring systems & finishes. Designed for use as a durable and attractive interior wear surface topping. Equipped with MICROBAN antimicrobial product protection to fight the growth of stain-causing mold and mildew on the surface.

**FEATURES/BENEFITS:**

- Available in standard colors of Grey and White
- Can be tinted to coordinate with interior finishes or branding designs through our – AnyColor custom color program
- Full system availability with L&M and STONETECH products
- Provides a durable, attractive and low maintenance cementitious wear-surface grade concrete overlayment, suitable for polishing to various shine levels
- Polishable to a finished wear-surface in as little as 24 hours
- Self-leveling concrete overlayment formula is both pourable and pumpable

**PACKAGING:**

55 lb (25 kg) bag; 56 bags per pallet  
 2,200 (998 kg) Supersack

Approximate Coverage		
Thickness	Coverage as a Wear Surface	Coverage as an Underlayment
1/4" (6 mm)	24 ft <sup>2</sup> (2.2 m <sup>2</sup> )	25 ft <sup>2</sup> (2.3 m <sup>2</sup> )
1/2" (12 mm)	12 ft <sup>2</sup> (1.1 m <sup>2</sup> )	12.5 ft <sup>2</sup> (1.2 m <sup>2</sup> )
3/4" (18 mm)	8 ft <sup>2</sup> (0.7 m <sup>2</sup> )	8.3 ft <sup>2</sup> (0.8 m <sup>2</sup> )
1" (25 mm)	6 ft <sup>2</sup> (0.6 m <sup>2</sup> )	6.3 ft <sup>2</sup> (0.6 m <sup>2</sup> )
1-1/4" (32 mm)	4.8 ft <sup>2</sup> (0.4 m <sup>2</sup> )	5 ft <sup>2</sup> (0.5 m <sup>2</sup> )



**NXT® PRIMER**

Refer to Data Sheet 502.0  
0905-0401-2/0905-0005-2/0905-0245-2



A concentrated water-based primer, applied before installing NXT® self-leveling underlayments. Penetrates deeply into substrates and maximizes bond strength.

**FEATURES/BENEFITS:**

- Multi-purpose and can be used on a wide range of substrates
- Broom, roller, or spray applied

**PACKAGING:**

1 gal (3.8 L) jug, 4 jugs per carton, 28 cartons per pallet  
5 gal (18.9 L) plastic pail, 36 per pallet  
245 gal (927.4 L) heavy-duty intermediate bulk container (IBC)

\* NXT® Primer is sold as a concentrate. To estimate quantity of primer for a job, select the type of SUITABLE SUBSTRATE from the table, then look up Approximate Coverage Per Gallon Concentrate. Divide Square Footage by Approximate Coverage Per Gallon Concentrate to estimate the number of gallons of primer that will be required.

NXT® Primer DILUTION / Approximate Coverage		
SUITABLE SUBSTRATES	Dilution Ratio = Primer: Water	Approximate Coverage Per Gallon Diluted with Water
<b>Normal Suction:</b> Concrete	1:3	100 ft <sup>2</sup> (9 m <sup>2</sup> )
<b>High-Suction:</b> Highly Porous Dry Concrete / NXT Underlayments / Cement Mortar Beds	1st Coat: 1:5 2nd Coat: 1:3	50 ft <sup>2</sup> (5 m <sup>2</sup> )
<b>Exterior Glue Plywood</b>	1:1	100 ft <sup>2</sup> (9 m <sup>2</sup> )
<b>Non-Suction:</b> Ceramic, Stone, Quarry Tile / VCT, Sheet Vinyl / Cement Terrazzo	1:1 with Slurry	100 ft <sup>2</sup> (9 m <sup>2</sup> )
<b>NXT® Vapor Reduction Coating</b>	1:1 with Slurry	100 ft <sup>2</sup> (9 m <sup>2</sup> )
<b>STRATA_MAT™</b> <b>STRATA_HEAT™ Mat*</b>	n/a	n/a



**NXT EPOXY PRIMER**

Refer to Data Sheet 029.3  
0909-0302-2/0909-0010-2



A two-component, high-solids epoxy primer applied with a sand broadcast for use with NXT Level DL, NXT Level SP or other decorative wear surfaces.

**FEATURES/BENEFITS:**

- Ultimate bond for decorative wear surfaces
- Easily roller applied
- Provides a barrier between decorative wear surfaces and substrate below
- Reduced pinholes in the decorative topping

**PACKAGING:**

2 gal (7.6 L) kit  
10 gal (38 L) kit

**Approximate Coverage**

**2 Gallon (7.6 L) Kit:**  
180–266 ft<sup>2</sup> (16.7–24.7 m<sup>2</sup>) at 12–18 mils (0.3–0.5 mm)

**10 Gallon (38 L) Kit:**  
900–1330 ft<sup>2</sup> (83.6–123.6 m<sup>2</sup>) at 12–18 mils (0.3–0.5 mm)

Yield/coverage may vary slightly depending on the surface profile and field conditions.

\* Do not use primer over STRATA\_MAT™ or STRATA\_HEAT™ Mat

**NXT® PATCH**

Refer to Data Sheet 501.0  
0904-0025-21



A fast-drying underlayment patch for use over most substrates. Cement-based formula is excellent for deep fills from 1/8" - 1 1/2" (3 - 38 mm) per lift.

**FEATURES/BENEFITS:**

- Easy to mix and apply
- Fast drying — apply finish floor goods in as soon as 40 minutes
- Interior and exterior applications

**PACKAGING:**

25 lb (11.3 kg) bag/64 bags per pallet

Approximate Coverage per 25 lb (11.3 kg) bag	
Thickness	Coverage
1/8" (3 mm)	32.5 ft <sup>2</sup> (3.0 m <sup>2</sup> )
1/4" (6 mm)	16.3 ft <sup>2</sup> (1.5 m <sup>2</sup> )
1/2" (13 mm)	8.1 ft <sup>2</sup> (0.8 m <sup>2</sup> )
1" (25 mm)	4.1 ft <sup>2</sup> (0.4 m <sup>2</sup> )
1-1/2" (38 mm)	2.7 ft <sup>2</sup> (0.3 m <sup>2</sup> )



**SKIM LITE**

Refer to Data Sheet 506.0  
0918-0008-21



Skim Lite is a premium quality, fast-drying, polymer modified, cement-based underlayment designed for skim coating, smoothing and leveling prior to the application of floor coverings.

**FEATURES/BENEFITS:**

- Rapid setting formula
- High coverage rate
- Castor wheel safe
- Fiber reinforced
- High polymer content
- Fantastic workability
- Moisture tolerate
- Light weight — 40% weight saving
- Apply from skim depth to 1" (25 mm)
- Ready for finished flooring in as soon as 20 minutes
- Contains no respirable crystalline silica levels that exceed the OSHA action level\*
- Direct replacement for NXT and SUPERCAP Skim Skimcoat, DRYTEK Skimcoat

**PACKAGING:**

8 lb (3.6 kg) bag

Approximate Coverage per 8 lb (3.6 kg) bag
Up to 380 ft <sup>2</sup> (35.3 m <sup>2</sup> ) at skim depth over smooth substrate (Slu/plwood/etc.)
Up to 190 ft <sup>2</sup> (26.9 m <sup>2</sup> ) at skim depth over rough substrate (Osb/concrete/etc.)



**NXT® EMBOSSING ADMIX**

Refer to Data Sheet 503.0  
0903-0401-2



A latex admixture for use with Skim Lite for embossing over non-cushion backed vinyl and VCT flooring.

**FEATURES/BENEFITS:**

- Increases bond strength of Skim Lite
- Easy to mix and apply when mixed with Skim Lite
- Smooth consistency

**PACKAGING:**

5 quarts (4.8 L) per jug, 4 jugs per carton,  
28 cartons per pallet

Approximate Coverage
Per 3.5 qts. (3.1 L) when mixed with 10 lb (4.5 kg) bag of NXT® Skim
Up to 300 ft <sup>2</sup> (27.9 m <sup>2</sup> ) Skim depth



**LATICRETE® PRO-MIX STATION**

7319-MIXER-CR



A successful job depends upon optimized mixing time, reduced spillage, and consistent results of the end-product, and the Pro-Mix Station provides an ideal and safe solution to meet these demands. As a pourable cart, the Pro-Mix Station contains the material, eliminates harmful dust, and provides combined batch consistency. The removable drill allows for the mixing of tile/stone adhesive and repair mortars. The Pro-Mix Station can be used with many LATICRETE products, such as self-leveling underlayments, overlayments, and epoxies.

3 bag capacity/14.5 amp/110 V drill/2- speed motor with 0-250 and 0-580 RPM/2 mixing paddles for SLU and mortars/Rotating caster wheels/Pourable and dust extractor/Steel frame

- 65 pounds
- 4 per pallet

**NXT® TOOL KIT**

7319-TOOL-CR



Be ready to tackle any NXT® and SUPERCAP® self-leveling underlayment/overlayment application with this high quality tool kit. Achieving smooth and consistent results on any project. No matter how big or small, LATICRETE has you covered.

**TOOL KIT\* INCLUDES:**

- 15 gallon (56.8 L) mixing barrel
- Slip-in spiked shoe — size large
- Gauge rake frame
- Gauge rake set
- Spiked roller with frame
- Oval mixing paddle
- Spreader smoother
- 2 quart (1.9 L) measuring container
- 3 piece pole

\*Kit is sold as a whole unit. Not available separately.



**LATICRETE® NIVCOMP™ DIGITAL LEVEL**

7317-NIVC-HS



This is a surveying tool to determine floor flatness and also helps you to calculate the correct amount of self leveling underlayment material needed for your job. This tool can be used with SUPERCAP® and NXT® products from LATICRETE.

**FEATURES/BENEFITS:**

- Rugged self-contained kit is light, portable, compact and easy to set up and use
- Single person operation
- Durable and easy to use hose reel — 157 ft (47.8 m) hose range is abrasion and crush resistant
- All-inclusive — requiring no tripods, transits, bubble levels or lasers
- Versatile and accurate [within  $\pm 5/64$ " (2 mm)] to work around corners — no line-of-sight required
- Measures height differences in "blind areas", flatness (level) and variable elevations

**LATICRETE NIVCOMP DIGITAL LEVEL INCLUDES:**

- Rugged, protective case
- Self-leveling device (reel, hose, handheld display unit)
- Rods
- Cradle
- Magnet attachment for overhead work
- End cap
- Operators manual

**LATICRETE ELEVATION PINS**

7316-LVPG-25



Customizable pins ensure your self-leveling underlayments pour will be to a specific, accurate depth. This tool can be used with SUPERCAP and NXT products from LATICRETE.

**FEATURES/BENEFITS:**

- Memory plastic snaps back — if bent, self-adhesive strip keeps pins in place
- Minimize waste by pouring self-leveling underlayments to a specific, accurate depth
- Dual measurement indicator marks in both inches and millimeters
- When used in conjunction with the NIVCOMP™, simply read the proper height on the NIVCOMP then cut the LEVELPEG to match
- Time saver — very fast and flexible to learn and use

**QUANTITY:**

1,000 pins per box

**SIZE:**

2-1/2" (64 mm)

**NXT® VAPOR REDUCTION COATING**

Refer to Data Sheet 507.0  
**PART A AND B - MINI UNIT 0906-0003-2**  
**PART A AND B - FULL UNIT 0906-0006-2**



A single-coat, 100% solids, liquid applied 2-part epoxy coating specifically designed for controlling the moisture vapor emission rate from new or existing concrete slabs prior to installing NXT underlayments. NXT Vapor Reduction Coating when applied at a minimum 12 mils thickness exceeds ASTM F3010 and will control moisture vapor emission rate up to 25 lbs/1,000 ft<sup>2</sup>/24 hr (1415 µg/(s • m))<sup>^</sup> per ASTM F1869/maximum<sup>^</sup> RH conditions per ASTM F2170.

**FEATURES/BENEFITS:**

- Exceeds ASTM F3010 standard
- Reduces MVER ≤25 to below 3lbs/1000 ft<sup>2</sup>/24 hrs (170 µg/(s • m<sup>2</sup>))
- Can be applied over new concrete in as little as 5 days
- UL GREENGUARD GOLD CERTIFIED
- Use on concrete up to 100% RH/14 pH

**PACKAGING:**

A: 0.75 gal/B: 1.74 gal (Kit/A: 2.8 L/B: 6.6 L)  
 2 steel pails

NXT® Vapor Reduction Coating is a kit of two pails. Individual pails (Part A or Part B) cannot be purchased separately, and cannot be returned separately.

Approximate Coverage	
Vapor Permeance µ	MVER/ RH
0.052 grains/h/ft <sup>2</sup> /in Hg (3 ng/sec • m <sup>2</sup> • Pa)	≤25 lbs (1415 µg)/100%
mil thickness	ft <sup>2</sup> /gal (m <sup>2</sup> /L)
12 mil (.3 mm)	133 ft <sup>2</sup> (3.2 m <sup>2</sup> )

\*\*Coverage is approximate and will vary depending on CSP (concrete surface profile), mil thickness, absorption, and other field conditions. <sup>^</sup>No visible water or condensation on the surface. µ Tested according to ASTM E96 Wet Method



**VAPOR BAN™ PRIMER ER**

Refer to Data Sheet 35222.0  
**PART A AND B - MINI UNIT 0913-0003-2**



A single-coat, ASTM F3010 approved, 100% solids, liquid applied 2-part epoxy coating specifically designed for controlling the moisture vapor emission rate from new or existing concrete slabs. It will also perform as a primer prior to installing NXT® and SUPERCAP® self-leveling underlayments. Can be used with multiple LATICRETE tile adhesives as well. It converts two steps into one. VAPOR BAN Primer ER reduces MVER ≤25 to below 3 lbs/1000 ft<sup>2</sup>/24 hrs (170 µg/(s•m<sup>2</sup>)).

**FEATURES/BENEFITS:**

- Exceeds ASTM F3010 standard
- Reduces MVER ≤25 to below 3 lbs/1000 ft<sup>2</sup>/24 hrs (170 µg/(s • m<sup>2</sup>))
- Moisture Barrier and Primer, ALL-IN-ONE
- Fast cure: ability to apply self-leveling underlayments and adhesives in as little as 3 to 4 hours
- Use on concrete up to 100% RH/14 pH
- Can be applied over new concrete in as little as 5 days

**PACKAGING:**

A: A .99 gal/B: 1.41 gal (Kit/A: 3.75 L/B: 5.34 L)  
 2 steel pails

Each mini unit will yield approximately 240 ft<sup>2</sup> (22.3 m<sup>2</sup>) VAPOR BAN™ Primer ER is a kit of two pails. Individual pails (Part A or Part B) cannot be purchased separately, and cannot be returned separately.

Approximate Coverage	
Vapor Permeance µ	MVER/ RH
0.094 grains/h/ft <sup>2</sup> /in Hg (5.4 ng/sec • m <sup>2</sup> • Pa)	≤25 lbs (170 µg)/100%
mil thickness	ft <sup>2</sup> /gal (m <sup>2</sup> /L)
16 mil (.4 mm)	100 ft <sup>2</sup> (9.3 m <sup>2</sup> )



**HYDRO BAN® SHOWER PANS**

Refer to Data Sheet 36588  
See Price Book



The HYDRO BAN® Shower Pan provides you with the convenience of a smaller, easier to handle multi-piece pre-fab shower pan for waterproofing shower applications.

**FEATURES/BENEFITS:**

- Pre-sloped shower pan eliminates the need for traditional mud bed installations
- Lightweight and durable, easy to transport and handle during shower installation
- Can quickly and easily be modified to size on site
- For peace of mind installs, the sheet membrane exceeds ANSI A118.10 requirements, is IAPMO approved and is tested to ASTM E96/E96M Procedure E-0.06 Perms — approved for steam showers/steam rooms as single membrane
- Membrane is pliable to conform easily to any substrate.
- Do it your way — allows installers to finish walls using HYDRO BAN Board or, HYDRO BAN liquid and HYDRO BAN Sheet Membrane over cement backer board

**PACKAGING:**

Carton Packaging — Varies per size

Available Sizes	Item Number
38" x 38" Center Drain Pan	9243-3838-CDP
48" x 48" Center Drain Pan	9243-4848-CDP
48" x 48" CDP Barrier-Free	9243-4848-CDP-BF
72" x 72" Center Drain Pan	9243-7272-CDP
48" x 72" Center Drain Pan	9243-4872-CDP
32" x 60" Center Drain Pan	9243-3260-CDP
32" x 60" Off-Center Drain Pan	9243-3260-OCDP

**HYDRO BAN SHOWER PAN KITS**

Refer to Data Sheet 36586  
See Price Book



The HYDRO BAN Shower Pan Kit provides a cost-effective solution for waterproofing shower applications. The shower installation kit includes all the key components for a waterproof shower.

**PACKAGING:**

Carton Packaging — Varies per size

Available Sizes	Item Number
38" x 38" Center Drain Kit	9243-3838-CDK
48" x 48" Center Drain Kit	9243-4848-CDK
72" x 72" Center Drain Kit	9243-7272-CDK
48" x 72" Center Drain Kit	9243-4872-CDK
32" x 60" Center Drain Kit	9243-3260-CDK



**HYDRO BAN®  
PRE-SLOPED SHOWER PAN**

Refer to Data Sheet 031.0

See Price Book



A component of the HYDRO BAN® line of products for rapid shower installations. Packaged with HYDRO BAN Preformed Curb and 1 tube of HYDRO BAN Adhesive and Sealant.

**FEATURES/BENEFITS:**

- Comes with a factory installed drain/waste line connection and drain assembly
- Pre-sloped, ready-to-tile pan — no need for traditional mud bed installations
- Can quickly be modified to size on site
- Factory installed, code-approved waterproofing meets ANSI A118.10 requirements
- Code approved; meets IAPMO-PS-106
- Available in custom sizes

HYDRO BAN® Drain Grates are sold separately in brushed, polished and oil rubbed bronze finishes. When ordering a HYDRO BAN Pre-Sloped Shower Pan, check with your local code official to determine whether a PVC, ABS or BRS (Brass) drain connection is required. Custom sizes available with a 4 week lead time from receipt of site drawing and Purchase Order. Contact your local LATICRETE Sales Rep for further information.

Available Sizes
36" x 60" (91 cm x 152 cm) PVC, ABS or BRS center drain
36" x 48" (91 cm x 122 cm) PVC, ABS or BRS center drain
48" x 60" (122 cm x 152 cm) PVC, ABS or BRS center drain
48" x 48" (122 cm x 122 cm) PVC, ABS or BRS center drain
38" x 66" (96 cm x 168 cm) PVC, ABS or BRS off center drain

Custom sizes available with 4 week lead time

**HYDRO BAN LINEAR  
PRE-SLOPED SHOWER PAN**

Refer to Data Sheet 085.0

See Price Book



A component of the HYDRO BAN line of products for rapid shower installations. Packaged with HYDRO BAN Preformed Curb and 1 tube of HYDRO BAN Adhesive and Sealant.

**FEATURES/BENEFITS:**

- Pairs with HYDRO BAN Linear Drains
- Pre-sloped, ready-to-tile pan — no need for traditional mud bed installations
- Length can quickly be modified to size on site
- Factory installed, code-approved waterproofing meets ANSI A118.10 requirements
- Code approved; meets IAPMO-PS-106
- Available in custom sizes

HYDRO BAN Linear Drains are sold separately.

Available Sizes	
LINEAR PRE-SLOPED SHOWER PAN SIZES	APPLICABLE LINEAR DRAIN SIZES
34" x 66" (86 cm x 168 cm)	32" (81 cm)
38" x 66" (97 cm x 168 cm)	36" (91 cm)
44" x 66" (112 cm x 168 cm)	42" (107 cm)
50" x 66" (127 cm x 168 cm)	48" (122 cm)

Custom sizes available with 4 week lead time



### HYDRO BAN® PREFORMED SEATS

Refer to Data Sheet 032.0

See Price Book



A component of the HYDRO BAN® line of waterproof products for rapid shower installations. All HYDRO BAN Preformed Seats are 20" (51 cm) high.

#### FEATURES/BENEFITS:

- High-density expanded polystyrene with a waterproof finish
- Lightweight and strong
- Ready-to-tile, waterproof surface
- Easy to install

### HYDRO BAN PREFORMED NICHES

Refer to Data Sheet 033.0

See Price Book



A component of the HYDRO BAN line of waterproof products for rapid shower installations. Custom sizes available with a 4 week lead time from receipt of site drawing and Purchase Order. Contact your local LATICRETE Sales Representative for further information.

#### FEATURES/BENEFITS:

- Lightweight, strong, high-density, expanded polystyrene
- Simple to install
- Ready-to-tile, waterproof surface
- Ideal for bathrooms and kitchens

Available Sizes
16" x 16" (41 cm x 41 cm) triangle
23" x 23" (58 cm x 58 cm) triangle
16" x 16" (41 cm x 41 cm) convex
All HYDRO BAN Preformed Seats are 20" (51 cm) high

Available Sizes
12" x 12" (30 cm x 30 cm) square
12" x 12" & 12" x 6" (30 cm x 30 cm & 30 cm x 15 cm)
8" x 12" (20 cm x 30 cm) and 8" x 6" (20 cm x 15 cm) narrow combo
12" x 20" (15 cm x 51 cm) mega



**HYDRO BAN® PREFORMED BENCH**

Refer to Data Sheet 067.0  
9305-3511-B



A component of the HYDRO BAN® line of products for rapid shower installations. Can be installed anywhere a tiled bench is needed.

All HYDRO BAN Preformed Benches are 20" (51 cm) in height. Custom sizes available with a 4 week lead time from receipt of site drawing and purchase order. Contact your local LATICRETE Sales representative for further information.

**FEATURES/BENEFITS:**

- Lightweight, high-density expanded polystyrene with a waterproof finish
- Simple to install; ready to tile
- Can be installed anywhere a tiled bench is needed

**HYDRO BAN BOARD**

Refer to Data Sheet 040.0  
See Price Book



A lightweight construction panel designed to be used in bonded tile or stone installations. Made with a high density extruded polystyrene core coated on both sides with a heavy duty waterproof layer for maximum performance. Tab washers are only required for ceiling installations.

**FEATURES/BENEFITS:**

- Lightweight, easy to carry — save on labor and freight
- Heavy duty waterproof membrane with XPS core — triple protection from water intrusion and ready to tile
- Low permeability — approved for steam rooms and steam showers
- No tab washers required for floors and walls — faster, less expensive installation

HYDRO BAN Board is priced by the sheet but sold by the bundle.

**Available Sizes**

35" x 11.5" (89 cm x 29 cm) rectangle

HYDRO BAN Preformed Bench is 20" (51 cm) high

Custom sizes available with a 4-week lead time

**Additional Sizes and Packaging  
3' x 5' (91 x 152 cm)**

THICKNESS	SHEETS PER PALLET	SHEETS PER BUNDLE
1/4" (6 mm)	84	21
1/2" (13 mm)	60	10
5/8" (16 mm)	50	10
1" (25 mm)	30	5
2" (50 mm)	15	3

**Additional Sizes and Packaging  
4' x 8' (122 x 244 cm)**

1/2" (13 mm)	55	5
--------------	----	---



## HYDRO BAN® BOARD ACCESSORIES

Refer to Data Sheet 040.0  
9450-0114-TW/9450-0158-S/9450-0300-S



Components of the HYDRO BAN® line of waterproof products for rapid shower installations.

### FEATURES/BENEFITS:

- Ceramic coated screws — pass 1000 hour salt spray testing
- Two tab washer for easier installation
- When installing HYDRO BAN Board 1 5/8" (41 mm) screw should be used with 1/4" (6 mm), 1/2" (12.7 mm) and 5/8" (16 mm) thick HYDRO BAN Board, 2" (50 mm) screw should be used with 1" (25 mm) thick board and a 3" (76 mm) screw with 2" (50 mm) thick board.

HYDRO BAN Board screws are priced and sold by the box.

## HYDRO BAN ADHESIVE & SEALANT

Refer to Data Sheet 108.0  
9909-0601-2/9099-2020-2



A one component, fast curing, hybrid elastomeric adhesive and sealant. This product is specifically formulated to meet today's Green Building Standards and has excellent adhesion on a wide variety of substrates.

### FEATURES/BENEFITS:

- Excellent adhesion on a variety of substrates
- For use with the HYDRO BAN line of shower system products including seams and penetrations for HYDRO BAN BOARD

Can be used with HYDRO BAN Board to join and cover seams, coves, corners and cover screw and tab washer penetrations.

### PACKAGING:

Cartridges available in 10.3 oz (305 ml) tubes, 6 tubes per carton. Sausage packs available in 20 oz (592 ml). Packed 20 sausage packs per carton

### Accessories

1-1/4" (32 mm) tab washer, 250 count

1-5/8" (41 mm) screw, 250 count

3" (150 mm) screw, 250 count



**HYDRO BAN® ACCESSORIES**

Refer to Data Sheet 065.0, 064.0, 061.0, 063.0  
See Price Book

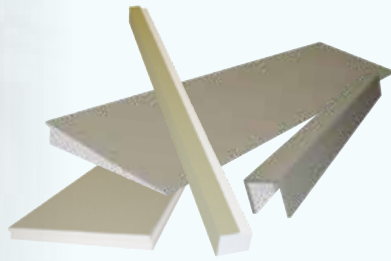

Components of the HYDRO BAN® line of waterproof products for rapid shower installations.

**FEATURES/BENEFITS:**

- Lightweight, high-density expanded polystyrene
- Waterproof finish
- Ready to tile

**HYDRO BAN PRE-SLOPED EXTENSION**

- Extension comes 24" x 48" (61 x 122 cm)
- Can be added onto the HYDRO BAN Pre-Sloped Shower Pan when a larger pan is required

**HYDRO BAN PRE-SLOPED RAMP**

- Ramp has a 1" in 8" (2.5 cm in 20 cm) slope and can be used for remodeling ADA compliant showers

**HYDRO BAN PREFORMED CURBS**

- 5' (152 cm) long, 3 3/4" (10 cm) high, 3.5" (9 cm) wide

**HYDRO BAN PREFORMED OVERLAY CURBS**

- Fits over a traditional 2" x 4" (5 x 10 cm) curb construction
- Available in 2 lengths:  
4' (122 cm)  
8' (244 cm)

**HYDRO BAN SHEET MEMBRANE**

Refer to Data Sheet 041.0  
9455-0108-2/9455-0323-2



Two convenient roll sizes for large and small installations. Can be used in steam showers as a vapor barrier/waterproofing membrane.

**FEATURES/BENEFITS:**

- Easy to cut and embed — conforms easily to irregular substrates
- Durable polypropylene surface fused to the core for optimal bond strength and integrity
- Allows for usage of polymer-modified or unmodified mortar — use proper mortar for the job
- Code approved; meets ANSI A118.10

**Available Sizes**

3'3" x 98'5" = 323 ft<sup>2</sup> (1 m x 30 m = 30 m<sup>2</sup>)  
38 rolls per pallet

3'3" x 33' = 108 ft<sup>2</sup> (1 m x 10 m = 10 m<sup>2</sup>)  
120 rolls per pallet





### HYDRO BAN® SEALING TAPE

Refer to Data Sheet 041.0  
9211-3750-2/9212-5625-2/9455-0516-2/9455-0598-2



Two convenient widths — 5" (125 mm) and 7.25" (185 mm) to meet any job requirement. Each available in two roll lengths. Use in combination with HYDRO BAN® Board for Steam Showers.

#### FEATURES/BENEFITS:

- Easy to cut and embed — conforms easily to irregular substrates
- Durable polypropylene surface fused to the core for optimal bond strength and integrity
- Allows for usage of polymer-modified or unmodified mortar — use proper mortar for the job
- Code approved; meets ANSI A118.10

### HYDRO BAN PREFORMED CORNERS

Refer to Data Sheet 041.0  
9455-0002-1C/9455-0002-0C



HYDRO BAN Prefomed Corners make waterproofing fast, easy and reliable. Use in conjunction with HYDRO BAN Sheet Membrane, Sealing Tape and Collars. Use in combination with HYDRO BAN Board for steam showers.

#### FEATURES/BENEFITS:

- Sturdy and pliable, conforms easily

#### PACKAGING:

Inside Corners: 2 per package — 12 per carton  
Outside Corners: 2 per package — 12 per carton

#### Available Sizes

5" x 16'5" (125 mm x 5 m)  
individually packaged — 12 per carton

5" x 98'5" (125 mm x 30 m)  
individually packaged — 1 per carton

7.25" x 16'5" (185 mm x 5 m)  
individually packaged — 12 per carton

7.25" x 98'5" (185 mm x 30 m)  
individually packaged — 1 per carton



**HYDRO BAN® COLLARS  
AND MIXING VALVE SEAL**

Refer to Data Sheet 041.0  
9455-0034-PC/9455-0938-MV

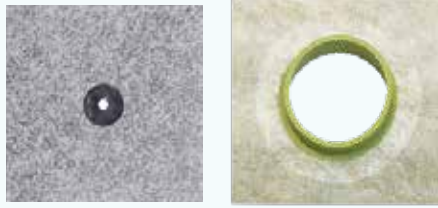

Pipe Collar

Mixing Valve

Pre-formed to ensure an easier and more secure installation. (Can also be used with HYDRO BAN® liquid applied waterproofing membrane.) Use in combination with HYDRO BAN Board for steam showers.

**FEATURES/BENEFITS:**

- Interior applications
- Showers or tub surrounds
- Complete line of accessories — single source supply

**PACKAGING:**

3/4" (20 mm) Pipe Collar — 1 per bag  
4-1/2" (114 mm) Mixing Valve, 10 per carton

**Available Sizes**

3/4" (20 mm) Pipe Collar for use with 1/2" - 3/4" pipe (12.7 - 20 mm) packaged individually, 12 per carton

4-1/2" (114 mm) Mixing Valve Collar packaged individually, 10 per carton



**HYDRO BAN DRAIN COLLARS**

Refer to Data Sheet 080.7  
9455-0034-DC/9455-0112-DC



The HYDRO BAN Deep Drawn Drain Collars are available in 3/4" (19 mm) and 1-1/2" (38 mm) depths and a 17" (43 cm) diameter.

Preformed drain collars are designed to use with HYDRO BAN Sheet Membrane when a shower pan is installed using 3701 Fortified Mortar Bed or similar materials. The HYDRO BAN Drain Collar enables the installer to easily waterproof a shower pan when using a divot method with mortar around a clamping ring drain assembly.

**FEATURES/BENEFITS:**

- Interior applications
- Topically waterproofed shower pans
- Easily conforms around clamping ring assembly

**PACKAGING:**

HYDRO BAN Deep Drawn Drain Collars 3/4" (19 mm), 10 per carton

HYDRO BAN Deep Drawn Drain Collars 1 1/2" (38 mm), 10 per carton



### HYDRO BAN® LINEAR DRAINS

Refer to Data Sheet 034.0  
See Price Book

Grate and trough sold separately.

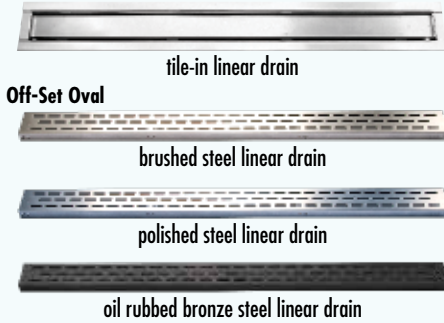

#### Wedge Wire

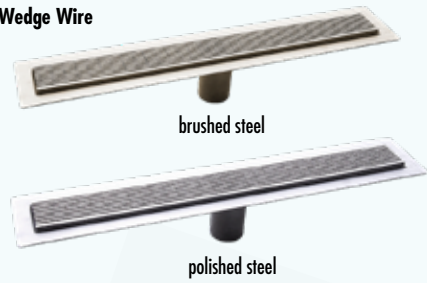

#### Side Outlet Linear Drain



All Sold Separately

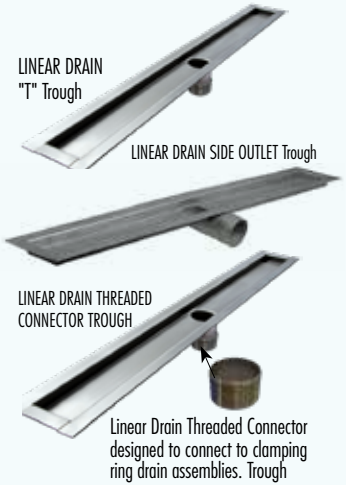

HYDRO BAN® Linear Drains are available in a tile-in version providing a seamless continuous tiled floor appearance — virtually making the drain disappear and an attractive brushed, polished or oil rubbed bronze finish offset oval design. Also, available in the HYDRO BAN Linear Drain line is the wedge wire in brushed and polished finishes. Ideal for large format tile or stone installations for shower floors installed along the wall or at intermediate locations. The HYDRO BAN Linear Drain is a two piece drain with a trough and removable grate **sold separately**. These linear drains are available with a standard vertical waste line a horizontal side outlet or a with a threaded connector (to connect to a clamping ring assembly) in eight standard lengths.

#### FEATURES/BENEFITS:

- Allows for use of large format tile and a single slope to the drain
- Tile in grate available to match floor tile
- Eliminates pre-slope and primary shower pan for a faster installation
- Made from heavy duty 304 stainless steel provides for long lasting performance
- HYDRO BAN waterproofing membrane bonds directly to stainless steel flange edge allowing for faster, easier installation

#### HYDRO BAN® Linear Drain Sizes

24" (61 cm)
30" (76 cm)
32" (81 cm)
36" (91 cm)
42" (107 cm)
48" (122 cm)
54" (137 cm)
60" (152 cm)
Custom sizes also available

Offset oval grate comes in brushed, polished, or oil-rubbed bronze finish. Wedge Wire grate is available in brushed and polished finish. Available with a vertical outlet, or a side outlet as a special order.

Custom sizes are available with a 4 week lead time from receipt of site drawing and purchase order. Contact your local LATICRETE Sales Representative for further information.



### HYDRO BAN® BONDING FLANGE DRAINS

Refer to Data Sheet 035.0  
See Price Book



HYDRO BAN® Bonding Flange Drain and the HYDRO BAN Bonding Flange Tile Drain are low profile floor drains specifically designed for bonded waterproofing installations with HYDRO BAN waterproofing membrane, the grates are 4" x 4" (10 x 10 cm) to match most common tile sizes.

**FEATURES/BENEFITS:**

- Grates are 4" x 4" (10 x 10 cm) to match most common tile sizes
- Attaches to 2" (50 mm), 3" (76 mm) and 4" (102 mm) waste lines
- Tile-in grate available to match floor tile
- Eliminates pre-slope and primary shower pan for a faster installation
- Made from heavy duty PVS or ABS and 304 stainless steel to provide long lasting performance
- HYDRO BAN waterproof membrane bonds directly to PVC or ABS flange
- Integrates seamlessly with portland cement mortar beds waterproofed with HYDRO BAN

**PACKAGING:**

Carton packaging

Bonding Flange	Item Number
Brushed Steel PVC 4" x 4"	9246-0404-BS-PVC
Brushed Steel ABS 4" x 4"	9246-0404-BS-ABS
Polished Steel PVC 4" x 4"	9246-0404-PS-PVC
Polished Steel ABS 4" x 4"	9246-0404-PS-ABS
Oil-Rubbed Bronze PVC 4" x 4"	9246-0404-ORB-PVC
Oil-Rubbed Bronze ABS 4" x 4"	9246-0404-ORB-ABS
Tile-In PVC 4" x 4"	9246-0404-TI-PVC
Tile-In ABS 4" x 4"	9246-0404-TI-ABS

### HYDRO BAN DRAIN GRATES

Refer to Data Sheet 069.0

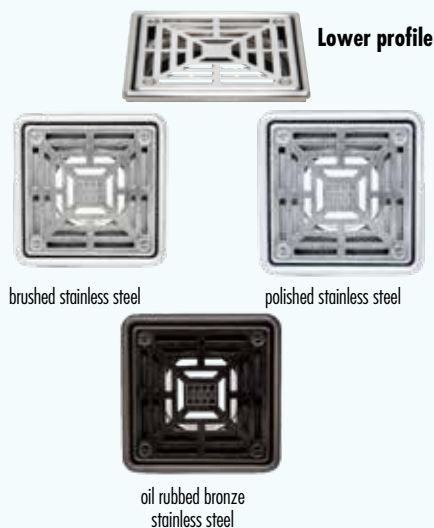

**FEATURES/BENEFITS:**

- Available in multiple finishes to match your other plumbing fixtures
- Grates are 4" x 4" (10 x 10 cm) to match most common tile sizes
- Code approval per ASME A 112.18-2/CSA B125.2.05 (US and Canada)
- Component of LATICRETE Lifetime Tile & Stone System Warranty\*. Single source responsibility
- Works in conjunction with HYDRO BAN Pre-Sloped Shower Pan and other clamping ring style drains

**PACKAGING:**

Carton packaging

Drain Grate	Item Number
Brushed Steel 4" x 4"	9248-0404-BS
Polished Steel 4" x 4"	9248-0404-PS
Oil-Rubbed Bronze 4" x 4"	9248-0404-ORB

Bonding Flange	Item Number
Bonding Flange SS	9248-0BFD-SS
Bonding Flange PVC	9248-0BFD-PVC
Bonding Flange ABS	9248-0BFD-ABS







**HYDRO BAN® XP**

Refer to Data Sheets DS-36642 and 10003  
9250-0401-2/9250-0005-2/9250-1275-2



A premium thin, load bearing waterproofing/crack isolation membrane that does not require the use of fabric in field areas, coves and corners††. It can be used in both interior and exterior as well as residential and commercial applications.

**FEATURES/BENEFITS:**

- Flood test in 2 hours after fully cured†
- No fabric required††
- IAPMO and ICC approved
- Anti-fracture protection of up to 1/8" (3 mm)
- Meets ANSI A118.10 and A118.12
- Steam shower and steam room rated

**Approximate Coverage**

1 gal pail	50 ft <sup>2</sup> (4.7 m <sup>2</sup> )
5 gal pail	250 ft <sup>2</sup> (23.2 m <sup>2</sup> )
275 gal tote	13,750 ft <sup>2</sup> (1,277 m <sup>2</sup> )



^ See Data Sheet 230.05 for complete warranty information. \* Interior application (non-wet areas only) \*\* If skim coated with a LATICRETE® latex thin-set mortar. \*\*\* Consult cement backer board manufacturer for specific installation recommendations and to verify acceptability for exterior use. † HYDRO BAN® XP can be flood tested in 2 hours when the waterproofing membrane is cured and the substrate is 70°F (21°C) and 50% RH or greater for 2 hours. The 2 hour period starts when the HYDRO BAN color has changed from a sage green to a dark olive green color indicating a cured membrane. If the substrate and the air temperature are lower than 70°F (21°C) and 50% RH, flood testing can not be performed until the HYDRO BAN XP color has changed from a sage green to dark olive green color and then 24 hours has lapsed.

**HYDRO BAN®**

Refer to Data Sheet 663.0 and 663.5  
9255-0005-2/9255-0401-2/9255-1275-2



A thin waterproofing anti-fracture membrane that combines optimum performance and unmatched productivity. HYDRO BAN® is rapid drying allowing for a faster tiling time and flood testing in just 2 hours\* after final cure. Save yourself time and money, and complete your installations faster with greater ease.

**FEATURES/BENEFITS:**

- Flood test in 2 hours\*
- Bonds directly to metal and plastic plumbing fixtures
- No fabric required\*
- Anti-fracture protection up to 1/8" (3 mm)
- IAPMO and ICC approved



In addition to the conventional means of applying HYDRO BAN®, the airless spraying technique can be used as an alternate means of application. HYDRO BAN can be effectively sprayed to increase productivity up to three times or four times on large projects. Any airless sprayer can be used that will deliver up to 3300 PSI (22.8 MPa) using a maximum tip size of 0.031" (0.79 mm). See TDS 410 for further information on the application of HYDRO BAN with an airless sprayer.

**PACKAGING:**

Commercial Unit: 5 gal (18.9 L) pail liquid 36 units per pallet  
Mini Unit:  
4 x 1 gal (3.8 L) pails of liquid packed in a carton  
30 cartons per pallet

Approximate Coverage	
Per Commercial Unit	250 ft <sup>2</sup> (23.2 m <sup>2</sup> )
Per Mini Unit	50 ft <sup>2</sup> (4.7 m <sup>2</sup> )

**HYDRO BAN QUICK CURE WATERPROOFING**

Refer to Data Sheets 670.4  
9266-0001-2



A rapid, thin, liquid applied ready-to-use waterproofing membrane that is ANSI A118.10 Compliant. Featuring Wet-Cure technology, this allows curing even in humid, cold and damp environments. HYDRO BAN Quick Cure allows for flood testing in as soon as 30 minutes\* allowing contractors to install a shower system all in one day.

**FEATURES/BENEFITS:**

- Interior
- Shower pans, stalls and tub surrounds
- Thin; only 0.012" (0.3 mm) thick when cured
- Wet-Cure Technology — Can be used in humid, cold and damp environments.
- Allows for flood testing in 30 min. at 70°F (21°C) or higher\*
- Bonds directly to metal, PVC and ABS plumbing fixtures
- Exceeds ANSI A118.10
- Non-flammable
- Eco-friendly, low VOC

**PACKAGING:**

1 gal (3.8 L) Pail

Approximate Coverage	
1 Gallon Unit:	134 ft <sup>2</sup> /gal (12.4 m <sup>2</sup> /3.8 L)



**MICROBAN**



ICC  
E-3



UPC



LOW VOC



**25 YEAR**  
Warranty



**MICROBAN**



MADE IN USA



**LIFETIME**  
Warranty



MADE IN USA



**25 YEAR**  
Warranty



UPC



**MICROBAN**

\* See Data Sheet 663.0 for complete product information. HYDRO BAN® can be flood tested in 2 hours when cured at 70°F (21°C) or above and 50% R.H. It can be flood tested in 24 hours when cured at 50 - 69°F (10 - 20.6°C) and up to 70% R.H. The time to flood testing starts when the second coat has completely cured from a light sage green to a darker olive green color.  
Antimicrobial technology protects the treated article against mold and mildew deterioration. Antimicrobial technology is not designed to replace normal cleaning practices or protect users.

**HYDRO BAN® CEMENTITIOUS WATERPROOFING MEMBRANE**

Refer to Data Sheet 628.7  
9259-0030-2



A one component, polymer fortified, cement based waterproofing material that mixes only with water. HYDRO BAN® Cementitious Waterproofing Membrane handles negative and positive hydrostatic pressure up to 2 BARS (29 PSI (.2 MPa) when applied at 40 mils (1 mm) thick. Flood test within 2 hours. Passes ANSI A118.10 Waterproofing and ANSI A118.12 Crack Isolation (with mesh/fabric up to 1/8" (3 mm).

**FEATURES/BENEFITS:**

- Exterior
- Swimming pools, fountains, water features, spas and hot tubs
- Flood testing in 2 hours at 70°F (21°C) or higher\*
- Can be used under pool plasters
- Bonds directly to metal, PVC and ABS plumbing fixtures
- Anti-fracture protection of up to 1/8" (3 mm)
- Exceeds ANSI A118.10 and A118.12 (with mesh) ISO 13007-5 CMP

**PACKAGING:**

30 lb (13.6 kg) Bag

**Approximate Coverage**

At 40 mil (1 mm) Thick - 120 ft<sup>2</sup> (11.2 m<sup>2</sup>)



**9235 WATERPROOFING MEMBRANE**

Refer to Data Sheets 236.0 and WPAF.5  
9235-0001-2/9235-0401-2



A thin, load-bearing waterproofing designed specifically for the special requirements of ceramic tile, stone and brick installations. A self-curing liquid rubber polymer and a reinforcing fabric are quickly applied to form a flexible, seamless waterproofing membrane that bonds to a wide variety of substrates.

**FEATURES/BENEFITS:**

- Industry approved as a shower pan liner
- Provides anti-fracture protection up to 1/8" (3 mm)
- Can be installed using a paint roller or brush
- Meets LEED and VOC requirements
- Interior and exterior

**PACKAGING:**

Full Unit:

- 6 gal (22.7 L) pail of liquid
- 1 carton Waterproofing/Anti-Fracture Fabric, packed separately; 36 units per pallet

Mini Unit:

- 2 gal (7.6 L) jug of liquid and Waterproofing/Anti-Fracture Fabric, packed together in one pail 48 pails per pallet

**Approximate Coverage**

Per Full Unit	300 ft <sup>2</sup> (27.9 m <sup>2</sup> )
Per Mini Unit	75 ft <sup>2</sup> (7 m <sup>2</sup> )



\* at 70°F (21°C) or higher.



**HYDRO BARRIER™ PLUS**



Refer to Data Sheet 36640  
9265-0005-2/9265-0401-4  
9265-0035-2/9265-1275-2

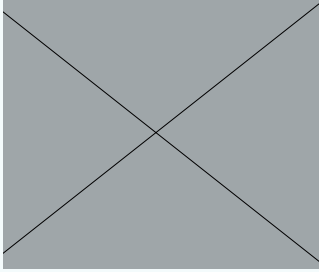

A thin, load-bearing, self-curing, liquid rubber polymer easily applied to form a flexible, seamless waterproofing, anti-fracture membrane.

**FEATURES/BENEFITS:**

- Approved by IAPMO for use as shower pan liner
- No fabric required††
- Allows for flood testing in 12 hours<sup>†</sup>
- Anti-fracture protection up to 1/8" (3 mm)
- Meets ANSI A118.10 and A118.12
- IAPMO and ICC approved

**PACKAGING:**

Full Unit:  
3.5 gal (13.2 L) pail liquid; 48 full units per pallet  
  
Commercial Unit:  
5 gal (18.9 L) pail liquid 36 units per pallet

Approximate Coverage	
Per Full Unit	175 ft <sup>2</sup> (16.2 m <sup>2</sup> )
Per Commercial Unit	250 ft <sup>2</sup> (23.2 m <sup>2</sup> )

**LATAPOXY®  
WATERPROOF FLASHING MORTAR**

Refer to Data Sheet 070.0  
0024-0001-2



A 3-component epoxy-based flashing mortar to waterproof seams, gaps, or joints between a substrate, metal and PVC pipes, drains, and flashing.

**FEATURES/BENEFITS:**

- For use under ceramic tile, stone, or brick
- For rapid installations that require a fast-curing waterproof flashing
- Easy to apply using a trowel

**PACKAGING:**

3.5 gal (13.2 L) pail with 2 Part A 1.4 lbs. (0.65 kg),  
2 Part B 1.15 lbs (0.5 kg) and 2 Part C 5.5 lbs. (2.5 kg);  
48 units per pallet  
  
Unit contains LATAPOXY® Waterproof Flashing Mortar Part A 2.7 lbs (1.2 kg),  
LATAPOXY Waterproof Flashing Mortar Part B liquids 2.3 lbs (1.0 kg), and  
LATAPOXY Waterproof Flashing Mortar Part C filler powder 11 lbs (5.0 kg) conveniently  
packed in a 3.5 gal (13.2 L) mixing pail.

Approximate Coverage	
45 ft <sup>2</sup> /unit (4.2 m <sup>2</sup> ) at 1/8" (3 mm) thick, depending on application	



† Allow HYDRO BARRIER™ Plus to cure fully before flood testing, typically 12 hours at 70°F (21°C) and 50% RH. Cold and/or wet conditions will require a longer curing time. For temperatures 45 – 69°F (7 – 21°C) allow 3 days prior to flood testing.

**LATICRETE® FLASHING SEALANT**

Refer to Data Sheet 36617  
9270-2020-2



LATICRETE® Flashing Sealant is a single component, fast curing, hybrid elastomeric adhesive that is specifically formulated to meet today's Green Building Standards. Offering excellent adhesion on a wide variety of substrates, it simplifies air and watertight details in both new and existing construction allowing for same day installations.

**FEATURES/BENEFITS:**

- Excellent bond strength — will not peel, chip or bubble from substrates
- Contribute to overall building energy efficiency — Helps maintain heating and cooling requirements for the building structure
- Meets ASTM D 1970 Nail Sealability requirements — Helps prevent infiltration of air and moisture
- Safe — no solvents and non-flammable
- No harmful VOC's

**PACKAGING:**

20 oz (592 ml) Sausage Pack

**Approximate Coverage**

Approximately 49 lineal feet (14.9 m) per sausage pack at 1/4" x 1/4" (6 x 6 mm) joint width

**BLUE 92 ANTI-FRACTURE MEMBRANE AND CRACK SUPPRESSION KIT**

Refer to Data Sheets 647.0, 648.0, and WPAF.5  
9200-0001-2/9200-0001-2-4



A 2-part system that forms a flexible, full-coverage membrane that reduces crack transmission from the substrate to floor finishes.

**FEATURES/BENEFITS:**

- Easy to install; cleans up with water
- EXTRA heavy service rating per ASTM C627 (TCNA)
- Passes ANSI A118.12 anti-fracture performance up to 1/8" (3 mm)

**PACKAGING:**

Kit: 2 gallon (7.6 L) jug of liquid, 1 each 15" (38 cm) wide roll of Waterproofing/Anti-Fracture Fabric packed together in one carton; 36 cartons per pallet.

Full Unit: 5 gallon (19 L) pail liquid; 1 carton Waterproofing/Anti-Fracture Fabric, packed separately, 36 units per pallet.

**Approximate Coverage**

75 linear ft/unit (23 m) at 15" (37.5 cm) wide  
300 ft<sup>2</sup> (28 m<sup>2</sup>) per full unit



**FRACTURE BAN™ SC**

Refer to Data Sheet 544.0  
9209-0035-2/9209-0401-2



FRACTURE BAN™ SC is a thin, load bearing, self-curing liquid rubber polymer that can be easily applied in a single coat to form a flexible seamless anti-fracture membrane.

**FEATURES/BENEFITS:**

- Exceeds ANSI A118.12
- Anti-fracture protection of up to 1/8" (3 mm) over shrinkage and other non-structural cracks
- Rapid drying for a faster time to tile
- Single coat application

**PACKAGING:**

3.5 gal (13.2 L) pail  
36 units per pallet

**125 TRI MAX®**

Refer to Data Sheet 024.0  
0125-0025-21



125 TRI MAX® provides incredible sound isolation protection while simultaneously protecting the tile or stone finish from any cracking by reducing the transmission of stresses in the substrate through to the tile or stone finish.

**FEATURES/BENEFITS:**

- Anti-fracture and sound reduction in one step — install tile fast reducing labor and material cost by 15 to 20%
- Single component (just add water) making it easy to mix, spread and use
- Lightweight, 50 lb (22.7 kg) coverage in a 25 lb (11.3 kg) bag
- 36% post-consumer recycled content contributes to LEED
- Fiber reinforced producing a stronger bond
- Heavy per ASTM C627 Robinson Floor Test — TCNA so you can use it in high traffic areas

**PACKAGING:**

25 lb (11.3 kg) bags

**COVERAGE:**

73-82 ft<sup>2</sup> (6.8-7.6 m<sup>2</sup>) per bag with 1/4" x 1/4" (6 mm x 6 mm) trowel  
49-54 ft<sup>2</sup> (4.6-5.0 m<sup>2</sup>) per bag with 1/4" x 3/8" (6 mm x 9 mm) trowel  
37-41 ft<sup>2</sup> (3.4-3.8 m<sup>2</sup>) per bag with 1/2" x 1/2" (12 mm x 12 mm) trowel

**Approximate Coverage**

175 ft<sup>2</sup> (16.2 m<sup>2</sup>)/unit at wet coat thickness  
30 - 44 mils (0.8-1.2 mm)



**170.3 SOUND & CRACK ISOLATION MAT**

Refer to Data Sheet 170.0  
0170-0150-2



A 1/8" (3 mm) thick underlayment membrane that provides sound reduction and anti-fracture protection for tile or stone installations.

**FEATURES/BENEFITS:**

- Isolates cracks up to 1/8" (3 mm)
- ΔIIC rating — 16 per ASTM E2179
- LIGHT RATING per ASTM C627 (TCNA)
- Contains 88.5% post-consumer recycled content

**PACKAGING:**

150 ft<sup>2</sup> (13.9 m<sup>2</sup>) roll, 20 rolls per pallet

**170.5 SOUND & CRACK ISOLATION MAT**

Refer to Data Sheet 35615.0  
0176-0120-2

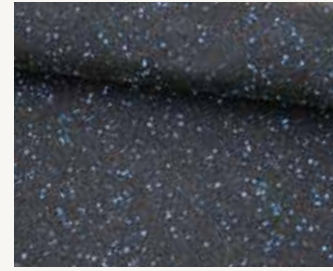

A high performance anti-fracture/sound and crack isolation membrane designed to be used under thin-bed adhesive for interior floor installations of ceramic tile, marble, stone and brick to reduce the transmission of impact noise and help provide soundproofing between floors and isolate cracks in the substrate.

**FEATURES/BENEFITS:**

- Delta IIC rating of 22 per ASTM 2179 Delta Impact Insulation Class exceeds code requirement through independent testing
- With an ΔIIC rating of 50, it is approved for Commercial Use per the International Building Code
- Anti-fracture membrane/sound and crack isolation eliminates transmission of cracks up to 1/8" (3 mm) from transferring to the finished floor helping to protect the tile installation from unsightly crack disfiguration
- ASTM C-627 "Moderate" Robinson floor rating allows this durable floor underlayment to be used in interior, dry, commercial and light industrial applications
- Meets ANSI A118.12 specifications
- Comprised of 89% post-consumer recycled content, it contributes to LEED credits, is eco-friendly and GREENGUARD certified
- It's easy and quick to install with a suitable LATICRETE® thin-set mortar and standard tools

**PACKAGING:**

4 ft x 30 ft (120 ft<sup>2</sup>), [1.2 m x 9.1 m (11.1 m<sup>2</sup>)] roll



**FRACTURE BAN™**

Refer to Data Sheet 155.0  
0178-0040-2/0178-0090-2



A high performance, pliable, light weight peel and stick membrane designed for use under ceramic tile, stone and other hard surface installations. Anti-Fracture: helps to prevent the transmission of horizontal in plane cracks from the substrate, up to 3/8" (9.5 mm), transmitting up through the tile and stone.

Sound control: FRACTURE BAN™ 40 has a  $\Delta$ IIC of 14 and FRACTURE BAN 90 a  $\Delta$ IIC of 18 through independent ASTM E2179 testing.

**FEATURES/BENEFITS:**

- Hot-applied polymer modified asphaltic adhesive coated on a 100% polyester non-woven with a 60# release liner paper
- Has a white non-woven surface for easy chalk line identification
- Acts as a water resistive barrier

**PACKAGING:**

One roll of FRACTURE BAN 40 is 40 mils (1 mm) thick  
39.25 in. x 69 ft (1 m x 21 m)  
24 rolls per pallet.

One roll of FRACTURE BAN 90 is 90 mils thick (2.3 mm)  
39.25 in. x 30.6 ft (1 m x 9.33 m)  
24 rolls per pallet.

**Approximate Coverage**

One roll of FRACTURE BAN 40 covers 225 ft<sup>2</sup> (20.9 m<sup>2</sup>)  
One roll of FRACTURE BAN 90 covers 100 ft<sup>2</sup> (9.3 m<sup>2</sup>)

**FRACTURE BAN PRIMER**

Refer to Data Sheet 156.0  
0178-0401-2/0178-0005-2/0178-0245-2



A concentrated premium quality, water-based primer designed to be applied prior to the installation of FRACTURE BAN membrane. FRACTURE BAN Primer penetrates deeply into substrates and maximizes bond strength of the FRACTURE BAN peel and stick membrane to the substrate.

FRACTURE BAN Primer is formulated as a concentrate and must be diluted 1:1 with clean potable water. When diluted, one gallon of concentrate will cover approximately 285 ft<sup>2</sup> (26.5 m<sup>2</sup>).

**FEATURES/BENEFITS:**

- Multi-purpose and can be used on a wide range of substrates
- May be broom, roller, or spray applied
- Penetrates deeply into substrates and maximizes bond strength

Do not allow FRACTURE BAN primer to freeze.

**PACKAGING:**

4 x 1 gal (4 x 3.8 L) carton, 48 per pallet  
5 gal (18.9 L) plastic pail, 28 per pallet  
245 gal (927.4 L) heavy-duty intermediate bulk container (IBC)

**Approximate Coverage**

When diluted, one gal (3.8 L) of concentrate will cover approximately 285 ft<sup>2</sup> (26.5m<sup>2</sup>).









# STRATA\_HEAT™

The most advanced floor heating system in the world!



Wi-Fi thermostat for total control from your smartphone.

## STRATA\_HEAT™ Thermal Pack

Combine with thin-set to provide uniform warmth virtually eliminating cold spots.

## STRATA\_HEAT Spliceless Wire

Allows multiple wire spacing combinations.

## STRATA\_HEAT Mat

Uncoupling mat for easy and secure wire placement.

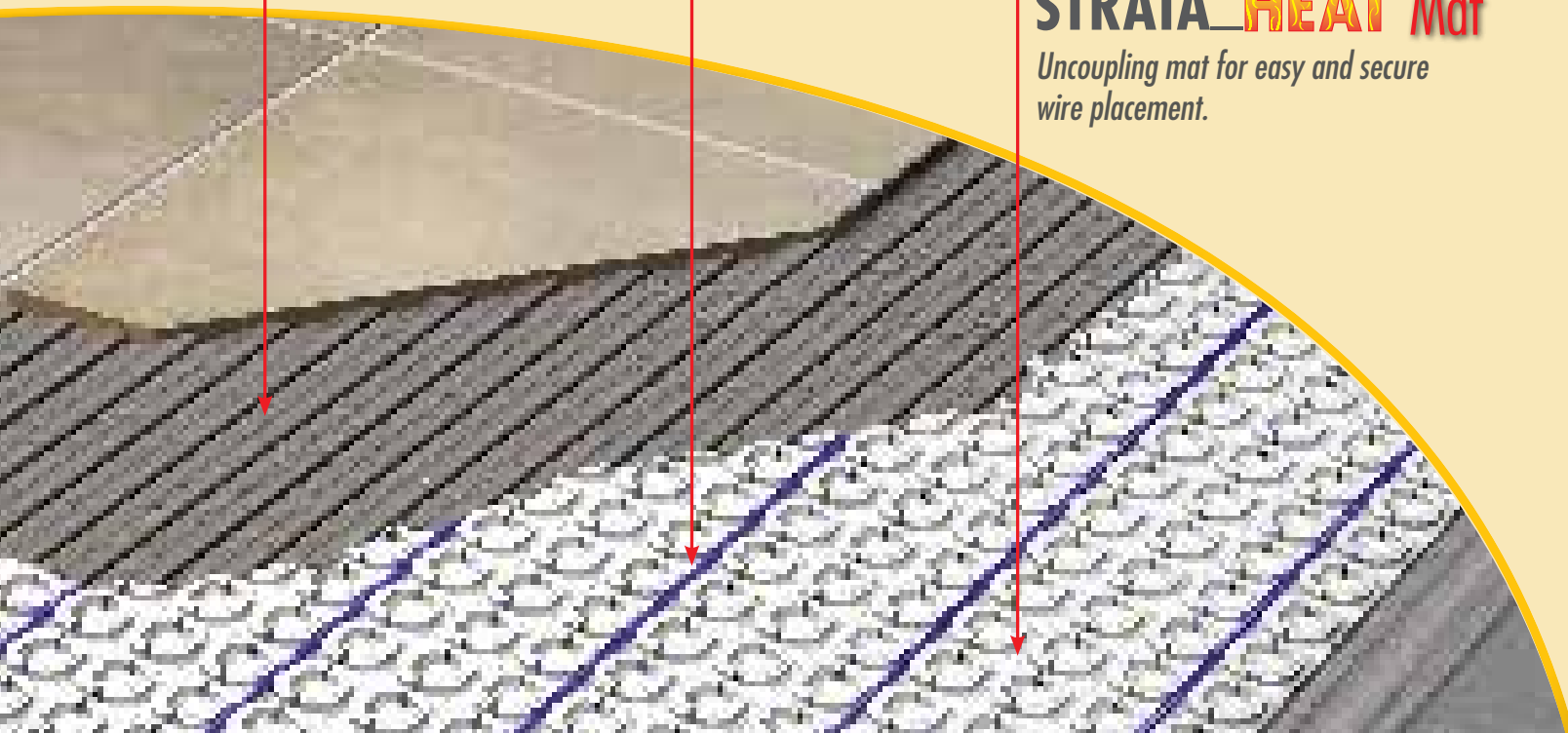



### STRATA\_HEAT™ MAT

Refer to Data Sheet 026.1  
 Installation Instructions Data Sheet 026.1  
 0179-0161-H/0179-1082-H/0179-5082-H

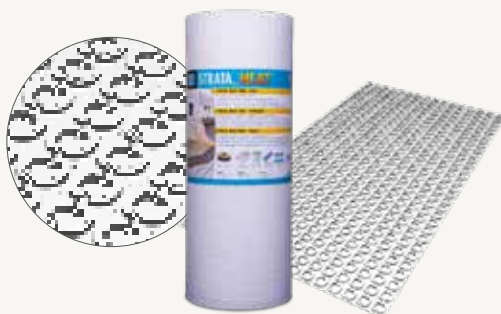

STRATA\_HEAT™ Mat combines the comfort of floor heating wire with the advantages associated with an uncoupling membrane. Warm your tile floor and enhance the mechanical bond to the substrate. STRATA\_HEAT Mat will provide faster drying of the mortar while allowing for shorter time to grout. At the same time it will easily hold the STRATA\_HEAT Wire in 3 or 4 peg positions for floor heating or warming installations. Just like our other uncoupling membranes it is specifically designed for use with both modified and unmodified mortars, you can use the appropriate mortar for the installations.

#### FEATURES/BENEFITS:

- U.S. Patented Nos. 9,777,931; 10,006,644; 10,215,423; D806,280; and patents pending. mortar hydration vents accelerate thin-set curing for faster dry time of porcelain and larger format tiles — grout the next day
- STRATA\_HEAT Mat design maximizes thin-set to wire contact producing a faster heat-up time with even heat distribution
- STRATA\_HEAT Spliceless Wire installs easily in mat — lays flat and secure
- Optical coverage verification — translucent features allows for easy determination of mortar coverage

#### PACKAGING:

3'3" x 46'2" (1 m x 14 m) roll  
 30.3" x 3'3" (0.7 m x 1 m) per sheet, 10 sheets per box  
 30.3" x 3'3" (0.7 m x 1 m) per sheet, 50 sheets per pack

#### Roll

161 ft<sup>2</sup> (15 m<sup>2</sup>) roll — 39" W x 49' 6" L (1 m x 15 m)

#### Sheet

10 Sheets: 8.6 ft<sup>2</sup> (0.79 m<sup>2</sup>)  
 Each sheet: 39"W x 31" L (1 m x .79 m)  
 50-Sheet Pack: 43 ft<sup>2</sup> (3.95 m<sup>2</sup>)  
 Each sheet: 39"W x 31" L (1 m x .79 m)

### STRATA\_HEAT SPLICELESS WIRE

Refer to Data Sheet 026.2  
 Installation Instructions Data Sheet 044.6  
 See Price Book



STRATA\_HEAT SPLICELESS WIRE is a versatile floor heating wire designed for use under tile and stone to provide luxury and comfort. STRATA\_HEAT SPLICELESS WIRE can be used with the STRATA\_HEAT Mat or STRATA\_HEAT Spacing Strips to meet all of your floor heating needs. It is available in 120 or 240V and fifteen convenient lengths.

#### FEATURES/BENEFITS:

- Can be used as primary heat source — allows multiple wire spacing combinations Heavy duty construction, outer jacket provides exceptional performance and durability Produces virtually zero electromagnetic field
- No minimum on a straight run length like other systems — easier to layout
- Highly conductive copper wiring provides maximum heat transfer
- Easy to install, lays flat and secure in STRATA\_HEAT Mat or STRATA\_HEAT Spacing Strips
- Spliceless design, single diameter throughout the length of the wire
- No need to cut out the mat and/or the sub-floor to bury the cold lead

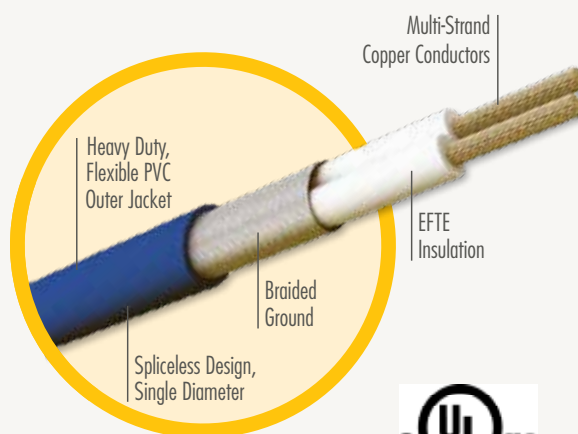

**STRATA\_HEAT™ WIRE SPACING STRIPS**

Refer to Data Sheet 026.1  
 Installation Instructions DS 044.6  
 0802-4012-1

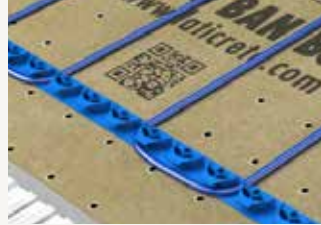

STRATA\_HEAT™ Wire Spacing Strips are a 12" (30.5 cm) long interlocking plastic strip to hold the STRATA\_HEAT Spliceless Wire. The spacing strips can be adhered to any subfloor to provide the correct wire spacing for the STRATA\_HEAT Spliceless Wire. STRATA\_HEAT Wire Spacing Strips are sold 40 per box.

**FEATURES/BENEFITS:**

- Simple to install; saving time and money
- Low-profile wire makes it undetectable under tile and stone floors

**PACKAGING:**

40 Spacing Strips, 12" (30.5 cm) long each



**STRATA\_HEAT THERMOSTATS**

Refer to Data Sheets DS-36649  
 Refer to Data Sheets DS-36648  
 0804-0403-TW/0804-0404-TW



**STRATA\_HEAT SMART LCD WIFI THERMOSTAT**

The STRATA\_HEAT Smart LCD Thermostat is a dual voltage 120V/240V thermostat that used both traditionally and through our favorite Smart device; it features a capacitive LCD touch-screen, a single-set up set process and number of other customizable settings that focus on functional and efficiency.

- Smartphone compatible — WiFi enabled
- High resolution capacitive LCD touch screen
- Reduced Wi-Fi load pull
- Customizable interface
- Single step set-up through QR code
- Smart home compatibility

**STRATA\_HEAT WIFI THERMOSTAT**

The STRATA\_HEAT WiFi Thermostat is a dual voltage 120V/240V thermostat that used both traditionally and through our favorite Smart device; it features a touch-panel LCD display, a single-set up set process and number of other customizable settings that focus on functional and efficiency

- Smartphone compatible — WiFi enabled
- Reduced Wi-Fi load pull
- Customizable display
- Single step set-up through QR code
- Smart home compatibility

**PACKAGING:**

Smart LCD WiFi 120V/240V  
 WiFi Thermostat 120V/240V



## STRATA\_HEAT™ THERMAL PACK

Refer to Data Sheet 107.7  
0802-0003-2



Available only from LATICRETE, STRATA\_HEAT™ Thermal Pack is a patent pending additive designed exclusively for use in select LATICRETE® adhesives. Utilizing Thermal Diffusion Technology™, heat generated from the STRATA\_HEAT Spliceless Wire is uniformly distributed throughout the adhesive, providing faster floor heat-up and a more comfortable and energy efficient installation.

### FEATURES/BENEFITS:

- Eliminates cold spots between wires — thermal heat diffusion is increased by 20% — providing uniform warmth for more comfort
- Reduces energy costs by 15% — since heat is transferred faster and more uniformly to achieve desired floor temp — number of heating cycles are reduced, saves money
- Economical and energy efficient — STRATA\_HEAT Thermal Pack† pays for itself in months by lowering electrical utilization costs

### PACKAGING:

3 lb (1.36 kg) Bag contains (2) Thermal Packs



STRATA\_HEAT™  
Thermal Pack

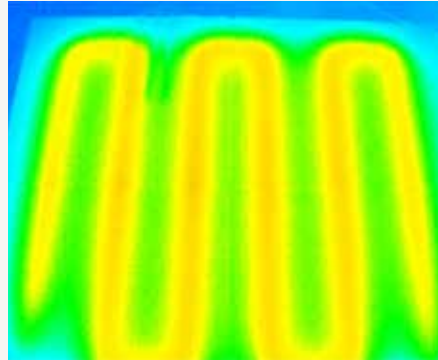

Infrared image using standard tile adhesive shows cold spots between wires

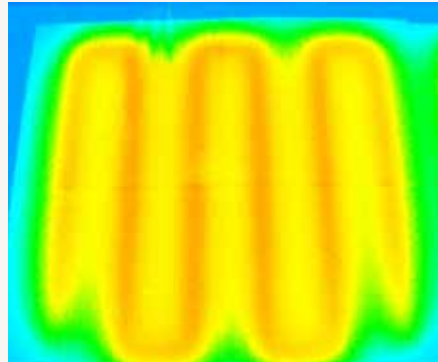

Infrared image using STRATA\_HEAT™ Thermal Pack† diffuses heat uniformly throughout — no cold spots

**LATAPOXY® 310 STONE ADHESIVE**

Refer to Data Sheets 679.0 and 679.3  
See Price Book



A strong, two-component epoxy adhesive for spot-bonding large format tile and stone on vertical surfaces. Easier and faster than traditional methods of veneer installation.

**FEATURES/BENEFITS:**

- For interior or approved exterior applications
- Both standard and rapid version for faster curing
- No drilling, cutting kerfs, or setting pins
- Allows for quick plumb adjustment while stone is in place to compensate for uneven walls and stone thickness variations
- Won't deteriorate over time
- ANSI A118.3 and ISO 13007-1 R2T classification

**PACKAGING:**

**Full Unit Kit:** 2.6 gal (10 L):  
All components packed in one carton  
1.3 gal (5 L) Part A pail, 1.3 gal (5 L) Part B pail  
40 cartons per pallet, Available in standard and rapid version  
**Mini Unit Kit:** 2 gal (8 L): units packed in one carton  
8 mini jars of Part A 0.5 qt (0.5 L), 8 mini jars of Part B 0.5 qt (0.5 L), 40 cartons per pallet  
Available in standard and rapid versions  
**Cartridge Packs:** 2.3 gal (9 L) Cartridge Pack (for use in LATAPOXY® 310 Cordless Mixer):  
15 x 20 oz (600 ml) cartridge packs of Part A and Part B per carton, 27 cartons per pallet  
Available in standard and rapid versions

**MIXING:**

Combine equal volumes of Part A and Part B (1:1).

Approximate Coverage		
Inches (or millimeters) Out of Plumb	LATAPOXY 310 Stone Adhesive Thickness	2.6 gal (10 L) Full Units
Plumb Wall (3 mm)	1/8" Thick (3 mm)	300 - 325 ft <sup>2</sup> (27 - 30 m <sup>2</sup> )
1/4" (6 mm)	1/4" Thick (6 mm)	150 - 170 ft <sup>2</sup> (14 - 16 m <sup>2</sup> )
1/2" (12 mm)	1/2" Thick (12 mm)	75 - 80 ft <sup>2</sup> (7 - 7.5 m <sup>2</sup> )

**LATAPOXY 310 CORDLESS MIXER**

Refer to Data Sheet 683.0  
RT8480310/RT8480500



This dual-component mixer quickly dispenses LATAPOXY 310 Stone Adhesive onto tile, porcelain, and stone veneers.

**FEATURES/BENEFITS:**

- Triples productivity of vertical stone and tile installations
- Install hundreds of square feet per day
- Design and gear systems allow speed and dosing control
- No mixing — just insert the dual component cartridge, screw on the mixing nozzle, and pull the trigger

**PACKAGING:**

1 LATAPOXY 310 Cordless Mixer per carton;  
24 cartons per pallet



**LATAPOXY® BIOGREEN™ 300 ADHESIVE**

Refer to Data Sheet 023.0  
0304-0001-2



A high strength, chemical resistant, 100% solids epoxy adhesive made with bio-based, sustainable material.

**FEATURES/BENEFITS:**

- Made with bio-based, sustainable materials
- Prevents curling of moisture-sensitive marbles and agglomerates
- For mesh mount glass mosaics and resin-backed tile and stone
- Will not stain white or light colored marble
- Meets ANSI A118.3 and ISO 13007-1 R2 classification

**PACKAGING:**

All components packed in one pail; 48 pails per pallet  
Makes 1.9 gal (7.2 L) of mortar

SHIPPING LIMITATION: All shipments via ground only, no air shipment allowed.

**LATAPOXY 300 ADHESIVE**

Refer to Data Sheet 633.0  
0300-0001-2



A high-strength, three-part, 100% solids epoxy adhesive formulated for chemical-resistant installations of quarry tile, brick, and packing house tile.

**FEATURES/BENEFITS:**

- Prevents curling of moisture-sensitive marbles and agglomerates
- For mesh mount glass mosaics and resin-backed tile and stone
- Will not stain white or light colored marble
- Meets ANSI A118.3 and ISO 13007-1 R2 classification

**PACKAGING:**

All components packed in one pail; 48 pails per pallet  
Makes 1.8 gal (6.8 L) of mortar

SHIPPING LIMITATION: All shipments via ground only, no air shipment allowed.

**Approximate Coverage**

NOTCH TROWEL	COVERAGE
1/16" (1.5 mm) V-notch	125 - 135 ft <sup>2</sup> (11.6 - 12.5 m <sup>2</sup> )
1/8" x 1/8" (3 x 3 mm) Square	60 - 70 ft <sup>2</sup> (5.6 - 6.5 m <sup>2</sup> )
3/16" (4 mm) V-notch	40 - 50 ft <sup>2</sup> (3.7 - 4.6 m <sup>2</sup> )
1/4" x 1/4" (6 x 6 mm) Square	30 - 35 ft <sup>2</sup> (2.8 - 3.3 m <sup>2</sup> )

**Approximate Coverage**

NOTCH TROWEL	COVERAGE
1/16" (1.5 mm) V-notch	125 - 135 ft <sup>2</sup> (11.6 - 12.5 m <sup>2</sup> )
1/8" x 1/8" (3 x 3 mm) Square	60 - 70 ft <sup>2</sup> (5.6 - 6.5 m <sup>2</sup> )
3/16" (4 mm) V-notch	40 - 50 ft <sup>2</sup> (3.7 - 4.6 m <sup>2</sup> )
1/4" x 1/4" (6 x 6 mm) Square	30 - 35 ft <sup>2</sup> (2.8 - 3.3 m <sup>2</sup> )







**PRIME-N-BOND™**

Refer to Data Sheet 307.0  
0095-0401-2/0095-0035-2



PRIME-N-BOND™ is a versatile, ready-to-use, single coat, low VOC primer designed to enhance the adhesion of mortars to many smooth and non-absorptive substrates that can be difficult to bond to. PRIME-N-BOND also improves bonding of self-leveling underlayments (SLUs).

**FEATURES/BENEFITS:**

- Multi-purpose and can be used on a wide range of substrates
- One component, ready to use, no mixing required
- Single coat application
- Formulated with aggregate for an enhanced mechanical bond
- Improves bonding of cement self-leveling products (SLUs)
- Low VOC, low odor, Ideal for interior and occupied areas
- White color will not darken the back of light colored stone

**PACKAGING:**

1 gal (3.78 L) pail, 4 pails per carton  
3.5 gal (13.3 L) plastic pail

**257 TITANIUM™**

Refer to Data Sheet 292.0  
0257-0025-21/0257-0025-22



The ultimate, lightweight, polymer fortified, thin-set mortar that is ideal for the installation of Gauged Porcelain Tile Panels/Slabs (GPTP), porcelain and glass tile as well as exterior and submerged applications. 257 TITANIUM™ is designed with key features to facilitate the installation of Gauged Porcelain Tile Panels including long open time, superior transfer for maximum coverage, easy to spread creamy consistency and a lightweight formula for easier handling. 257 TITANIUM contains no respirable crystalline silica levels that exceed the OSHA action level\*.

**FEATURES/BENEFITS:**

- Optimal performance for Gauged Porcelain Panels/Slabs
- Equipped with anti-microbial technology
- Lightweight- 25 lb (11.3 kg) bag has coverage of 50 lb (22.7 kg) traditional mortar
- Exceeds ANSI A118.4, A118.11 and ANSI A118.15

\* OSHA action level set forth in OSHA's Respirable Crystalline Silica (RCS) standard for construction, 29 CFR 1926.1153, as tested by an independent laboratory to be below the OSHA action level for respirable crystalline silica - see [laticrete.com/silica](http://laticrete.com/silica)

**PACKAGING:**

25 lb (11.3 kg) bag  
56 bags per pallet  
Colors: grey or white

**MIXING:**

Mix approximately 4.6 to 4.8 qts (4.4 to 4.5 L) of water per bag

Approximate Coverage
(varies depending on substrate)
1 gal (3.78 L) pail: 150 – 300 ft <sup>2</sup> (13.9 – 27.9 m <sup>2</sup> )
3.5 gal (13.3 L) pail: 525 – 1050 ft <sup>2</sup> (48.8 – 97.5 m <sup>2</sup> )

Approximate Coverage	
NOTCH TROWEL	COVERAGE
1/4" x 1/4" (6 x 6 mm)	80 – 95 ft <sup>2</sup> (7.4 – 8.8 m <sup>2</sup> )
1/4" x 3/8" (6 x 9 mm)	60 – 70 ft <sup>2</sup> (5.6 – 6.5 m <sup>2</sup> )





**254 PLATINUM**

Refer to Data Sheet 677.0

0254-0050-21/0254-0050-22/0254-0050-22-DL



Premium one-step, polymer-fortified, thin-set mortar that provides unsurpassed strength and versatility. Ideal for interior, exterior, thin porcelain tile and thin porcelain tile panels, and submerged applications on virtually all substrates and applications. For interior and exterior use.

**FEATURES/BENEFITS:**

- Ideal for gauged (thin) porcelain tile panels
- Exceptional bond strength
- Superior for exterior and submerged applications
- Great for difficult-to-bond porcelain tiles, glass mosaics, large format glass, and large, thin porcelain tile
- Easy to trowel; assures proper coverage on both the substrate and the veneer
- Long open time, allowing flexibility on the jobsite
- Exceeds ANSI A118.15 and ANSI A118.11 requirements
- Meets ISO 13007-1 C2TES1P1 classification

**PACKAGING:**

50 lb (22.7 kg) bag  
56 bags per pallet  
Colors: grey or white

**MIXING:**

Mix approximately 5.5 qt/50 lbs  
(5.2 L/22.7 kg) of water per bag

Approximate Coverage
80 – 95 ft <sup>2</sup> / 50 lb bag (7.4 – 8.8 m <sup>2</sup> /22.7 kg bag) with 1/4" x 1/4" (6 x 6 mm) notched trowel.
60 – 70 ft <sup>2</sup> / 50 lb bag (5.6 – 6.5 m <sup>2</sup> /22.7 kg bag) with 1/4" x 3/8" (6 x 9 mm) notched trowel.
35 – 40 ft <sup>2</sup> / 50 lb bag (3.2 – 3.7 m <sup>2</sup> /22.7 kg bag) with 1/2" x 1/2" (12 x 12 mm) notched trowel.

**254R PLATINUM RAPID**

Refer to Data Sheet 729.0

0254-0025-21-1/0254-0025-22-1



One-step, polymer-fortified, thin-set mortar for applications requiring rapid setting. Excellent for exterior applications that require rapid setting, 254R has unsurpassed adhesion and workability.

**FEATURES/BENEFITS:**

- Strong adhesion to exterior glue plywood (interior use only), concrete and porcelain tiles
- Mix with water only
- Can be grouted in 2 to 4 hours
- Superior adhesion for submerged applications
- Exceeds ANSI A118.4 requirements and ANSI A118.11

**PACKAGING:**

25 lb (11.3 kg) bag  
104 bags per pallet  
Colors: grey or white

**MIXING:**

Mix approximately 3 qt/25 lbs  
(2.8 L/11.3 kg) of water per bag

Approximate Coverage	
NOTCH TROWEL	COVERAGE
1/4" x 1/4" (6 x 6 mm)	40 – 47 ft <sup>2</sup> (3.7 – 4.4 m <sup>2</sup> )
1/4" x 3/8" (6 x 9 mm)	25 – 30 ft <sup>2</sup> (2.3 – 2.8 m <sup>2</sup> )
1/2" x 1/2" (12 x 12 mm)	20 – 23 ft <sup>2</sup> (1.9 – 2.1 m <sup>2</sup> )



Special order only will take 4-6 weeks. Contact your local LATICRETE Sales Rep for further information. \* Also available in DUST LOCK™ Technology version, dramatically reducing respirable silica dust while mixing. Special order only will take 4-6 weeks. Contact your local LATICRETE Sales Rep for further information.

**GLASS TILE ADHESIVE LITE**

Refer to Data Sheet 36628  
0296-0125-22



This high performance, lightweight, non-sag, polymer fortified adhesive mortar is specifically formulated for use in glass tile applications. Glass Tile Adhesive Lite is ultra-white in color and non-sanded with a smooth easy-to-trowel consistency and extended open time for ease of installation.

**FEATURES/BENEFITS:**

- Meets ANSI A118.15 ET, the highest ANSI standard for submerged applications
- Lightweight - half the weight of traditional mortars
- Optimal bond strength with minimal shrinkage
- Superior non-sag performance
- Contains no respirable crystalline silica levels that exceed the OSHA action level\*

**PACKAGING:**

12.5 lb (5.7 kg) bag  
104 bags per pallet  
Colors: white

**MIXING:**

Mix approximately 2.4 qt (2.3 L) of water per 12.5 lb (5.7 kg) bag

**253 GOLD**

Refer to Data Sheet 296.0  
0253-0050-21/0253-0050-22



253 Gold is a superior polymer fortified bagged cementitious thin-set powder to be mixed with water to install ceramic tile and natural stone using the thin-set method of installation.

**FEATURES/BENEFITS:**

- For use in interior and exterior floor and wall installations
- Can be used with all types of ceramic tiles, porcelain tile, and stone over concrete
- Can also be used with exterior glue plywood\* and other substrates
- Exceeds ANSI A118.4 and A118.11 requirements

\*Interior only

**PACKAGING:**

50 lb (22.7 kg) bag  
56 bags per pallet  
Colors: grey or white

**MIXING:**

Mix approximately 5.5 qt/50 lbs (5.2 L/ 22.7 kg) of water per bag

\* OSHA action level set forth in OSHA's Respirable Crystalline Silica (RCS) standard for construction, 29 CFR 1926.1153, as tested by an independent laboratory to be below the OSHA action level for respirable crystalline silica - see [laticrete.com/silica](http://laticrete.com/silica)

Approximate Coverage Per 12.5 lb (5.7 kg) bag	
NOTCH TROWEL	COVERAGE
1/4" x 1/4" (6 mm x 6 mm)	38 - 42 ft <sup>2</sup> (3.5 - 3.9 m <sup>2</sup> )
1/4" x 3/8" (6 mm x 9 mm)	25 - 30 ft <sup>2</sup> (2.3 - 2.8 m <sup>2</sup> )
1/8" x 3/16" (3 mm x 4.5 mm)	75 - 85 ft <sup>2</sup> (7.0 - 7.9 m <sup>2</sup> )

Approximate Coverage Per 50 lb (22.7 kg) bag	
NOTCH TROWEL	COVERAGE
1/4" x 1/4" (6 mm x 6 mm)	80 - 95 ft <sup>2</sup> (7.4 - 8.8 m <sup>2</sup> )
1/4" x 3/8" (6 mm x 9 mm)	60 - 70 ft <sup>2</sup> (5.6 - 6.5 m <sup>2</sup> )





**253R GOLD RAPID**

Refer to Data Sheet 296.3  
0253-0050-21-1/0253-0050-22-1



An excellent solution for both interior and exterior applications that require a mortar with rapid setting characteristics.

**FEATURES/BENEFITS:**

- For use in interior and exterior floor and wall installations
- Can be used with all types of ceramic tiles, porcelain tile, and stone over concrete
- Can also be used with exterior glue plywood\* and other substrates
- Ready for grouting in 2 to 4 hours
- Exceeds ANSI A118.4 and ANSI A118.11 requirements

\*Interior only

**PACKAGING:**

50 lb (22.7 kg) bag  
56 bags per pallet  
Colors: grey or white

**MIXING:**

Mix approximately 6 qts/50 lb (5.7 L/22.7 kg) of water per bag

Approximate Coverage Per 50 lb (22.7 kg) bag	
NOTCH TROWEL	COVERAGE
1/4" x 1/4" (6 x 6 mm)	80 - 94 ft <sup>2</sup> (7.4 - 8.8 m <sup>2</sup> )
1/4" x 3/8" (6 x 9 mm)	60 - 70 ft <sup>2</sup> (5.6 - 6.6 m <sup>2</sup> )



**252 SILVER**

Refer to Data Sheet 676.0  
0252-0050-21/0252-0050-22



Economical solution for interior and exterior installations. Mixes with water for a strong bond.

**FEATURES/BENEFITS:**

- Interior and exterior
- Exceeds ANSI A118.4 shear bond strength requirements
- Bonds to most surfaces

**PACKAGING:**

50 lb (22.7 kg) bag  
56 bags per pallet  
Colors: grey or white

**MIXING:**

Mix approximately 5 qt/50 lbs (4.7 L/ 22.7 kg) of water per bag

Approximate Coverage Per 50 lb (22.7 kg) bag	
NOTCH TROWEL	COVERAGE
1/4" x 1/4" (6 x 6 mm)	80 - 95 ft <sup>2</sup> (7.4 - 8.8 m <sup>2</sup> )
1/4" x 3/8" (6 x 9 mm)	60 - 70 ft <sup>2</sup> (5.6 - 6.5 m <sup>2</sup> )



**272 MORTAR**

Refer to Data Sheet 259.0  
0272-0050-22



A non-modified, cementitious powder for ceramic tile and stone installations.

**FEATURES/BENEFITS:**

- Can be mixed with either water or latex additive
- For increased performance and flexibility, mix with 333 Flexible Additive
- Meets ANSI A118.1 strength requirements

**PACKAGING:**

50 lb (22.7 kg) bag  
56 bags per pallet  
Color: white

**MIXING:**

Per 50 lb (22.7 kg) bag, mix 2 gal (7.6 L) of 333 Flexible Additive or 1.7 gal (6.5 L) of 3701 Mortar Admix or water

**317 MORTAR**

Refer to Data Sheet 317.0  
0317-0050-21/0317-0050-22



A smooth, creamy, sanded, non-modified thin-set mortar for interior and exterior use.

**FEATURES/BENEFITS:**

- For use on floors and walls over masonry, concrete, cement backer board, mortar beds, and gypsum wallboard\*
- For increased performance and flexibility, mix with 333 Flexible Additive
- For exterior applications, mix with 3701 Mortar Admix
- Meets ANSI A118.1 strength requirements
- 317 Mortar mixed with 333 Flexible Additive meets ISO 13007-1 C2ES2

\*Interior only

**PACKAGING:**

50 lb (22.7 kg) bag  
56 bags per pallet  
Colors: grey or white

**MIXING:**

Mix 2 gal (7.6 L) of 333 Flexible Additive per 50 lb (22.7 kg) bag

Approximate Coverage Per 50 lb (22.7 kg) bag	
NOTCH TROWEL	COVERAGE
1/4" x 1/4" (6 x 6 mm)	75 - 90 ft <sup>2</sup> (7.0 - 8.4 m <sup>2</sup> )
1/4" x 3/8" (6 x 9 mm)	55 - 65 ft <sup>2</sup> (5.1 - 6 m <sup>2</sup> )

Approximate Coverage Per 50 lb (22.7 kg) bag	
NOTCH TROWEL	COVERAGE
1/4" x 1/4" (6 x 6 mm)	75 - 90 ft <sup>2</sup> (7 - 8.4 m <sup>2</sup> )
1/4" x 3/8" (6 x 9 mm)	55 - 65 ft <sup>2</sup> (5.1 - 6m <sup>2</sup> )



**333 FLEXIBLE ADDITIVE**

Refer to Data Sheet 266.0  
0333-0302-2/0333-0005-2



This liquid additive creates flexible thin-set mortars with superior bond strength.

**FEATURES/BENEFITS:**

- Mixes with all LATICRETE® pre-bagged, non-fortified, thin-set mortars for installation over concrete, brick, block, cement backer board, existing ceramic tile, cement terrazzo, exterior glue plywood\*, gypsum wallboard\*, vinyl tile\*, linoleum\*, plastic laminates\*, and non-water soluble cut back adhesives\*
- Ideal for remodeling projects
- Extra Heavy service rating per ASTM C627 (TCNA)

\*Interior only

**PACKAGING:**

2 gal (7.6 L) jug:  
3 jugs per carton  
40 cartons per pallet

5 gal (19 L) pail:  
36 pails per pallet

**MIXING:**

2 gal (7.6 L) of 333 Flexible Additive mixes with approximately 50 lbs (22.7 kg) of LATICRETE thin-set mortars

**15 PREMIUM MASTIC**

Refer to Data Sheet 286.0  
0015-0035-22/0015-0401-2



A white, non-flammable, pre-mixed latex adhesive for interior installations of ceramic tile and stone, on both floors and walls.

**FEATURES/BENEFITS:**

- Creamy and smooth
- For installations over cement backer board\*\*, gypsum wallboard, and exterior glue plywood^
- Water-resistant
- Exceeds ANSI A136.1 Type 1 and Type 2 requirements

\*\*Consult cement backer board manufacturer for specific installation recommendations ^Floors only

**PACKAGING:**

3.5 gal. (13.2 L) pail  
48 pails per pallet

1 gallon (3.8 L) pail  
4 pails per carton; 30 cartons per pallet

**Approximate Coverage Per gal (3.5 L) pail**

NOTCH TROWEL	COVERAGE
1/8" (3 mm) V-notch	50 - 60 ft <sup>2</sup> (4.6 - 5.6 m <sup>2</sup> )
3/16" (5 mm) V-notch	30 ft <sup>2</sup> (2.8 m <sup>2</sup> )
1/4" x 1/4" (6 x 6 mm)	20 ft <sup>2</sup> (1.9 m <sup>2</sup> )



**MULTIMAX™ LITE**

Refer to Data Sheet 328.0  
0289-0025-21/0289-0025-22



The ultimate lightweight, versatile, high performance non-sag Large and Heavy Tile mortar.

**FEATURES/BENEFITS:**

- Exceeds ANSI A118.15
- Lightweight — easy to trowel formula. A 25 lb (11.3 kg) bag provides the same coverage as a 50 lb (22.7 kg) bag of standard mortar
- Contains no respirable crystalline silica levels that exceed the OSHA action level\*
- Maximum non-sag, non-slump performance
- Build up to 3/4" (19 mm) without shrinkage, or slump
- 40 minute Open Time
- Smooth and creamy consistency
- One mortar for large and heavy tile, thin-bed and wall installations of tile and stone.
- High strength; fiber reinforced
- Meets ISO 13007-C2TES1P1

\* OSHA action level set forth in OSHA's Respirable Crystalline Silica (RCS) standard for construction, 29 CFR 1926.1153, as tested by an independent laboratory to be below the OSHA action level for respirable crystalline silica - see [laticrete.com/silica](http://laticrete.com/silica)

**PACKAGING:**

25 lb (11.3 kg) bag  
56 bags per pallet  
Colors: grey or white



**MIXING:**

Approximate water required per 25 lb (11.3 kg)  
Wall and Large and Heavy Format Tile 4.8 – 5.0 qts (4.5 – 4.7 L)  
Thin-set 5.2 – 5.4 qts (4.9 – 5.1 L)

Approximate Coverage Per 25 lb (11.3 kg) bag		
NOTCH TROWEL	ft <sup>2</sup>	m <sup>2</sup>
FOR WALL APPLICATION 1/4" x 3/8" (6 x 9 mm)	50 – 60	4.6 – 5.5
FOR LARGE HEAVY TILE 1/2" x 1/2" (12 x 12 mm)	40 – 50	3.7 – 4.6
FOR THIN BEDS 1/4" x 1/4" (6 x 6 mm)	85 – 95	7.9 – 8.8
1/4" x 3/8" (6 x 9 mm)	60 – 70	5.5 – 6.5



**TRI-LITE™ RAPID**

Refer to Data Sheet 36639  
0279-0275-22-1



A fast setting, lightweight, high performance tri-purpose mortar designed for Large and Heavy Tile, for wall installations. A 27.5 lb (12.5 kg) bag provides the same coverage as a 50 lb (22.7 kg) bag of standard mortar. TRI-LITE RAPID contains no respirable crystalline silica levels that exceed the OSHA action level\*

**FEATURES/BENEFITS:**

- Exceeds ANSI A118.15 FHT / ISO 13007-C2F5T1P1
- Lightweight — easy to trowel formula
- Non-sanded, easy-to trowel
- Excellent non-sag, non-slump performance

**PACKAGING:**

27.5 lb (12.5 kg) bag  
Colors: white

**MIXING:**

Approximate water required per 27.5 lb (12.5 kg) bag

Application	Water
Wall and Large and Heavy Format Tile	3.8 – 4.1 qts (3.6 – 3.9 L)
Thin-Bed	4.4 – 4.5 qts (4.2 – 4.3 L)

Approximate Coverage Per 50 lb (22.7 kg) bag	
NOTCH TROWEL	COVERAGE
1/4" x 1/4" (6 x 6 mm)	80 – 95 ft <sup>2</sup> (7.4 – 8.8 m <sup>2</sup> )
1/4" x 3/8" (6 x 9 mm)	60 – 70 ft <sup>2</sup> (5.6 – 6.5 m <sup>2</sup> )
1/2" x 1/2" (12 x 12 mm)	40 – 47 ft <sup>2</sup> (3.7 – 4.4 m <sup>2</sup> )



\*OSHA action level set forth in OSHA's Respirable Crystalline Silica (RCS) standard for construction, 29 CFR 1926.1153, as tested by an independent laboratory to be below the OSHA action level for RESPIRABLE CRYSTALLINE SILICA - SEE [LATICRETE.COM/SILICA](http://LATICRETE.COM/SILICA)

**TRI-LITE™**

Refer to Data Sheet 320.0  
0279-0030-21/0279-0030-22



A lightweight, high performance tri-purpose mortar designed for large and heavy tile, thin-bed and wall installations. Lighter to transport, easier to trowel. A 30 lb (13.6 kg) bag provides the same coverage as a 50 lb (22.7 kg) bag of standard mortar.

**FEATURES/BENEFITS:**

- Lightweight
- Smooth creamy consistency
- Superior non-sag, non-slump performance
- Exceeds ANSI A118.15
- Interior and exterior applications

**PACKAGING:**

30 lb (13.6 kg) bag  
56 bags per pallet  
Colors: grey or white

**MIXING:**

Approximate water required per 30 lb (13.6 kg) bag

Application	Water
Wall and Large and Heavy Format Tile	4.6 – 4.8 qts (4.4 – 4.5 L)
Thin-Bed	5.0 – 5.2 qts (4.8 – 4.9 L)

Approximate Coverage Per 50 lb (22.7 kg) bag	
NOTCH TROWEL	COVERAGE
1/4" x 1/4" (6 x 6 mm)	80 – 90 ft <sup>2</sup> (7.4 – 8.8 m <sup>2</sup> )
1/4" x 3/8" (6 x 9 mm)	60 – 70 ft <sup>2</sup> (5.6 – 6.5 m <sup>2</sup> )
1/2" x 1/2" (12 x 12 mm)	40 – 47 ft <sup>2</sup> (3.7 – 4.4 m <sup>2</sup> )

**4-XLT**

Refer to Data Sheet 080.0  
0259-0050-21/0259-0050-22/0259-0050-21-DL/0259-0050-22-DL



A multi-use, polymer-fortified adhesive mortar for non-sag wall installations, large and heavy format tile build-up, and thin-set applications on floors. This formula offers superior workability.

**FEATURES/BENEFITS:**

- Best for build-ups to 3/4" (19 mm)
- Exceeds ANSI A118.4, A118.11 and A118.15 standards
- Meets ISO 13007-1 C2T classification

**PACKAGING:**

50 lb (22.7 kg) bag  
56 bags per pallet  
Colors: grey or white

**MIXING:**

Approximate water required per 50 lb (22.7 kg) bag

Application	Water
Wall and Large, Heavy Tile	4.5 - 4.75 qts/50 lbs (4.3 - 4.5 L/ 22.7 kg)
Thin-Set	5 qts (4.7 L)

Approximate Coverage Per 50 lb (22.7 kg) bag	
NOTCH TROWEL	COVERAGE
1/4" x 1/4" (6 x 6 mm)	80 - 95 ft <sup>2</sup> (7.4 - 8.8 m <sup>2</sup> )
1/4" x 3/8" (6 x 9 mm)	60 - 70 ft <sup>2</sup> (5.6 - 6.5 m <sup>2</sup> )
1/2" x 1/2" (12 x 12 mm)	40 - 47 ft <sup>2</sup> (3.7 - 4.4 m <sup>2</sup> )



Special order only will take 4-6 weeks. Contact your local LATICRETE Sales Rep for further information. \* Also available in DUST LOCK™ Technology version, dramatically reducing respirable silica dust while mixing. Special order only will take 4-6 weeks. Contact your local LATICRETE Sales Rep for further information.



**4-XLT RAPID**

Refer to Data Sheet 081.0  
0259-0050-21-1/0259-0050-22-1



**LHT™ PLUS**

Refer to Data Sheet 109.0  
0231-0050-21/0231-0050-22



A fast-setting, multi-use, polymer-fortified adhesive mortar for large, heavy tile installations.

**FEATURES/BENEFITS:**

- For non-sag wall installations, large and heavy tile build-up, and thin-set applications on floors
- LATICRETE® Water Dispersion Technology™ disperses water in the mix for best consistency
- LATICRETE DUST LOCK™ Technology reduces mess during transportation and mixing
- Meets ISO 13007-1 C2FT classification

**PACKAGING:**

50 lb (22.7 kg) bag  
56 bags per pallet  
Colors: grey or white

**MIXING:**

Approximate water required per 50 lb (22.7 kg) bag

Application	Water
Wall and Large, Heavy Tile	5.0 - 5.5 qt (4.7 - 5.2 L)
Thin-Set	5.5 - 6 qt (5.2 - 5.7 L)

Approximate Coverage Per 50 lb (22.7 kg) bag	
NOTCH TROWEL	COVERAGE
1/4" x 1/4" (6 x 6 mm)	80 - 95 ft <sup>2</sup> (7.4 - 8.8 m <sup>2</sup> )
1/4" x 3/8" (6 x 9 mm)	60 - 70 ft <sup>2</sup> (5.6 - 6.5 m <sup>2</sup> )
1/2" x 1/2" (12 x 12 mm)	40 - 47 ft <sup>2</sup> (3.7 - 4.4 m <sup>2</sup> )

A polymer modified large and heavy tile mortar for installation of large format tile and stone on floors and walls. For use over most common substrates including exterior glue plywood.

**FEATURES/BENEFITS:**

- Can be used over Exterior Glue Plywood (EGP) without the use of an additive
- Smooth and creamy consistency
- Superior bond that meets the demands of challenging installations involving large and/or heavy tile
- Excellent large heavy tile performance, 3/4" (19 mm) thick without shrinkage
- Interior and exterior floor and wall installations
- For use with large format ceramic tile, porcelain tile and stone
- Meets ANSI A118.4 and ANSI A118.11 requirements

**PACKAGING:**

50 lb (22.7 kg) bag  
56 bags per pallet  
Colors: grey or white

**MIXING:**

Approximate water required per 50 lb (22.7 kg) bag  
4.6 to 4.9 qts (4.4 to 4.6 L) of water

Approximate Coverage Per 50 lb (22.7 kg) bag	
NOTCH TROWEL	COVERAGE
1/2" x 1/2" (12 x 12 mm)	40 - 47 ft <sup>2</sup> (3.7 - 4.4 m <sup>2</sup> )



WATER DISPERSION TECHNOLOGY™

DUST LOCK



**LHT™**

Refer to Data Sheet 180.0  
0230-0050-21/0230-0050-22



A polymer modified large and heavy tile mortar specifically formulated to provide a one-step installation for large format ceramic tile, porcelain tile, marble and stone on floors.

**FEATURES/BENEFITS:**

- Smooth and creamy consistency
- Superior bond that meets the demands of challenging installations involving large and/or heavy tile
- Excellent medium bed/large heavy tile performance, 3/4" (19 mm) thick without shrinkage
- Interior and exterior floor installations
- For use with large format ceramic tile, porcelain tile and stone
- Meets ANSI A118.4 requirements

**PACKAGING:**

50 lb (22.7 kg) bag  
56 bags per pallet  
Colors: grey or white

**MIXING:**

Approximate water required per 50 lb (22.7 kg) bag  
4.6 to 4.9 qts (4.4 to 4.6 L)

Approximate Coverage Per 50 lb (22.7 kg) bag	
NOTCH TROWEL	COVERAGE
1/2" x 1/2" (12 x 12 mm)	40 - 47 ft <sup>2</sup> (3.7 - 4.4 m <sup>2</sup> )



**LATICRETE® SELECT-BOND™ ADHESIVE**

Refer to Data Sheet 36579  
2700-0025-21/ 2700-0025-22



A polymer modified tile and stone adhesive that can be used for both thin bed and Large Heavy Tile applications. Designed to be used alone or mixed with one of three optional LATICRETE® Adhesive System Kits for additional performance enhancements — Non-Sag, Rapid and High Performance (ANSI A118.15).

When used alone (without an additional LATICRETE SELECT-BOND™ system Kit) LATICRETE Adhesive Base provides a one-step installation for ceramic tile, porcelain tile, marble and stone on floors and walls. Approved for use over exterior glue plywood for interior installations.

**FEATURES/BENEFITS:**

- For both thin bed and Large and Heavy Tile applications
- Exceeds ANSI A118.4 H and ANSI A118.11
- Exceeds ISO/EN 13007-2 requirements for C1
- For interior and exterior floor and wall applications
- "Extra Heavy" rating per ASTM C627

**PACKAGING:**

25 lb (11.3 kg) bag  
104 bags per pallet  
Colors: grey or white

**MIXING:**

Approximate water required per 50 lb (22.7 kg) bag

Approximate Coverage Per 50 lb (22.7 kg) bag	
NOTCH TROWEL	COVERAGE
1/2" x 1/2" (12 x 12 mm)	40 - 47 ft <sup>2</sup> (3.7 - 4.4 m <sup>2</sup> )



**LATICRETE® SELECT-BOND™ KITS**

Refer to Data Sheet 36580  
27NS-1001-2

27R-1001-2

27HP-1001-2



**RAPID**



**NON-SAG**



**HIGH PERFORMANCE (A118.15)**

Designed to be mixed with the LATICRETE® SELECT-BOND™ Adhesive to provide a fast setting adhesive for the installation of tile and stone.

**FEATURES/BENEFITS:**

- Rapid setting
- Ready for grouting in 3 to 4 hours.
- Exceeds ANSI A118.4 HF and A118.11 requirements

Designed to be mixed with the LATICRETE SELECT-BOND Adhesive to provide superior non-sag performance for installation of tile and stone on walls.

**FEATURES/BENEFITS:**

- Excellent non-sag performance on walls
- Extended Open Time
- Exceeds ANSI A118.4 EHT and A118.11

Designed to be mixed with LATICRETE SELECT-BOND Adhesive to provide superior bond to most substrates as well as non-sag performance for installation of tile and stone on floors and walls.

**FEATURES/BENEFITS:**

- High performance ANSI A118.4, A118.11 and A118.15 HT formula
- Excellent non-sag performance on walls
- Extended Open Time

**LATICRETE SELECT-BOND KIT FEATURES/BENEFITS:**

- Replaces a warehouse full of adhesives with a modular adhesive system that takes up of a fraction of the space and cost
- Use LATICRETE SELECT-BOND adhesive as your versatile, every day thin-bed and large heavy tile adhesive
- Versatile, easy-to-use systems
- Pre-measured packets
- Water soluble

**PACKAGING:**

Each kit packaged in a resealable plastic bag containing two packets. Use one packet per 25 lb (11.3 kg) bag of LATICRETE Select-Bond Adhesive.

**MIXING:**

Packets are premeasured (.25-.33 lb [.11-.14 kg]) and water soluble. Simply drop mix in water — No measuring no mess

LATICRETE SELECT-BOND SYSTEM COMPONENTS

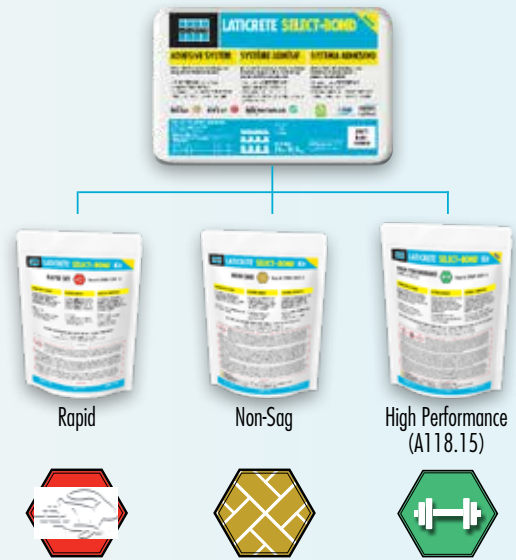

### 3701 LITE MORTAR

Refer to Data Sheet-36590  
1060-0030-21



### 3701 LITE MORTAR R (RAPID)

Refer to Data Sheet 36603  
2060-0030-21-1



Contains carefully selected polymers, Portland cement and light weight aggregates. 3701 Lite Mortar contains no detectable respirable crystalline silica and does not require the use of latex admix. You will only need to add water to produce thick bed mortar or a vertical repair mortar/screed.

#### FEATURES/BENEFITS:

- Light weight - half the weight of conventional mortars but with the same coverage
- Excellent for vertical and overhead applications
- Contains no detectable respirable crystalline silica
- Freeze-thaw compliant
- Ease of mixing and application — can be applied up to 3/4" (1.9 cm) on a vertical surface
- Polymer fortified — no need for latex additives

#### PACKAGING:

30 lb (13.6 kg) bag; 56 bags per pallet

#### MIXING:

Mixing ratios vary depending on installation method. Please refer to DS-36590.

Contains carefully selected polymers, Portland cement and light weight aggregates. This Rapid mortar can be used in many different projects, decreasing the cure time significantly. 3701 Lite Mortar R contains no detectable respirable crystalline silica and does not require the use of latex admix. You will only need to add water to produce thick bed mortar or a vertical repair mortar/screed.

#### FEATURES/BENEFITS:

- Rapid formula — cure time between 1.5 to 2 hours
- Light weight — half the weight of conventional mortars but with the same coverage
- Excellent for vertical and overhead applications
- Contains no detectable respirable crystalline silica
- Freeze-thaw compliant
- Ease of mixing and application — can be applied up to 3/4" (1.9 cm) on a vertical surface
- Polymer fortified — no need for latex additives

#### PACKAGING:

30 lb (13.6 kg) bag; 56 bags per pallet

#### MIXING:

Mixing ratios vary depending on installation method. Please refer to DS-36603.

Approximate Coverage		
Render/Repair	Mortar Bed	Depth
12 ft <sup>2</sup> (1.1 m <sup>2</sup> )	10 ft <sup>2</sup> (0.93 m <sup>2</sup> )	0.5" (13 mm)
6 ft <sup>2</sup> (0.56 m <sup>2</sup> )	5 ft <sup>2</sup> (0.46 m <sup>2</sup> )	1" (25 mm)
4 ft <sup>2</sup> (0.37 m <sup>2</sup> )	3 ft <sup>2</sup> (0.28 m <sup>2</sup> )	1.5" (38 mm)
3 ft <sup>2</sup> (0.28 m <sup>2</sup> )	2 ft <sup>2</sup> (0.19 m <sup>2</sup> )	2" (51 mm)

Approximate Coverage		
Render/Repair	Mortar Bed	Depth
12 ft <sup>2</sup> (1.1 m <sup>2</sup> )	10 ft <sup>2</sup> (0.93 m <sup>2</sup> )	0.5" (13 mm)
6 ft <sup>2</sup> (0.56 m <sup>2</sup> )	5 ft <sup>2</sup> (0.46 m <sup>2</sup> )	1" (25 mm)
4 ft <sup>2</sup> (0.37 m <sup>2</sup> )	3 ft <sup>2</sup> (0.28 m <sup>2</sup> )	1.5" (38 mm)
3 ft <sup>2</sup> (0.28 m <sup>2</sup> )	2 ft <sup>2</sup> (0.19 m <sup>2</sup> )	2" (51 mm)





**QUICK CURE MORTAR BED**

Refer to Data Sheet 1004.0  
0229-0060-21-1



A rapid setting, polymer fortified, blend of carefully selected polymers, portland cement and graded aggregates.

**FEATURES/BENEFITS:**

- Ready for foot traffic in as soon as 60 minutes
- No need for latex additives, just add water
- No need for job site measuring and mixing of sand and cement
- High compressive strengths (4000 psi/27.6 MPa)
- Use with HYDRO BAN® Quick Cure for faster shower system installs

**PACKAGING:**

60 lb (27.2 kg) bag; 56 bags per pallet

**MIXING:**

Mixing ratios vary depending on installation method. Please refer to DS-1004.0.

Approximate Coverage
14 ft <sup>2</sup> at 1/2" (1.3 m <sup>2</sup> at 12 mm)
7 ft <sup>2</sup> at 1" (0.7 m <sup>2</sup> at 25 mm)
3.5 ft <sup>2</sup> at 2" (0.3 m <sup>2</sup> at 50 mm)

**3701 FORTIFIED MORTAR**

Refer to Data Sheet 100.0  
0229-0060-21/0229-2000-21



A one-step polymer-fortified blend of raw materials, Portland cement, and graded aggregates.

**FEATURES/BENEFITS:**

- No need for latex admix
- Add water for a thick bed mortar or render
- No need for job site measuring and mixing of sand and cement
- Polymer fortified – no need for latex additives
- Superior compressive strengths (5000 psi/34.5 MPa)
- An alternative to 3701 Mortar Admix combined with 226 Thick Bed Mortar

**PACKAGING:**

60 lb (27.2 kg) bag; 56 bags per pallet  
2000 lb. (907 kg), 1 per pallet, 18 pallet per load

**MIXING:**

Mixing ratios vary depending on installation method. Please refer to DS-100.0.

Approximate Coverage
12 ft <sup>2</sup> at 1/2" (1.1 m <sup>2</sup> at 12 mm)
6 ft <sup>2</sup> at 1" (0.56 m <sup>2</sup> at 25 mm)
3 ft <sup>2</sup> at 2" (0.3 m <sup>2</sup> at 50 mm)



### 3701 MORTAR ADMIX AND 226 THICK BED MORTAR

Refer to Data Sheets 231.0 and 239.1  
3701-0005-2/0226-0060-21



When mixed together, these products form a thick-bed mortar that is strong and resistant to weather, frost, thermal, and physical shock.

#### FEATURES/BENEFITS:

- Can be used to build concrete patches, stucco, and plaster mortars
- Can be used to level, ramp or slope

#### PACKAGING:

**3701 Mortar Admix:**  
5 gal (18.9 L) pail  
36 pails per pallet

**226 Thick Bed Mortar:**  
60 lb (27.2 kg) bag  
56 bags per pallet

#### MIXING:

For use as a thick-set mortar: Mix approximately 5 gal (18.9 L) of Admix per 7 x 60 lb (27.2 kg) bags of mortar

### 209 FLOOR MUD

Refer to Data Sheet 209.0  
0209-0060-21/0209-2000-21



Mixes with 3701 Mortar Admix to provide a conventional floor mortar bed.

#### FEATURES/BENEFITS:

- Pre-mixed, economical alternative to 226 Thick Bed Mortar
- For interior applications such as shower pan fills in bathrooms

#### PACKAGING:

60 lb (27.2 kg) bag; 56 bags per pallet  
2000 lb. (907 kg), 1 per pallet, 18 pallet per load

#### MIXING:

Mix approximately 0.7 gal (2.7 L) 3701 Mortar Admix or water per 60 lb (27.2 kg) bag

#### Approximate Coverage As thick bed mortar

45 ft<sup>2</sup> (4.2 m<sup>2</sup>) at 1" (25 mm) thick per 1 x 5 gal (18.9 L) pail of Admix and 7 x 60 lb (27.3 kg) bags of mortar

#### Approximate Coverage

6 ft<sup>2</sup> (0.56 m<sup>2</sup>) at 1" (25 mm) thickness per 60 lb (27.3 kg) bag









**PERMACOLOR® SELECT COLOR KIT**

Refer to Data Sheet 281.0  
See Price Book



**PERMACOLOR SELECT – BASE**

Refer to Data Sheet 281.0  
2600-0125-2/2600-0025-2/2600-0125-2-DL/2600-0025-2-DL



PERMACOLOR® Select is an advanced high performance cement grout that offers the industry's first dispersible dry pigment solution. PERMACOLOR Select is designed for virtually all types of residential and commercial installations and offers optimum performance on the most demanding exterior or interior applications. Easy to mix, grout, and clean, PERMACOLOR Select is fast setting and is suitable for joints 1/16" to 1/2" (1.5 mm - 12 mm) wide on floors or walls.

**FEATURES/BENEFITS:**

- Exceeds ANSI A118.7 and achieves ISO 13007-3 CG2WAF
- No sealing required — equipped with STONETECH® Sealer Technology
- Vibrant consistent color — resists efflorescence
- High strength; fiber reinforced — crack and shrink-resistant
- Fast setting — ready for foot traffic in as little as 3 hours

**Introducing thousands of customizable color options with PERMACOLOR® Select<sup>^</sup> ANYCOLOR™!**

With PERMACOLOR® Select AnyColor™, we can now color-match almost any color you can imagine including the vast Pantone®, BEHR®, Benjamin Moore® or Sherwin-Williams® palettes. Visit [laticrete.com/ANYCOLOR](http://laticrete.com/ANYCOLOR) for more details

Each PERMACOLOR® Select Color Kit contains two Color Packets.

Use 2 Color Packets when mixing with 25 lb (11.3 kg) PERMACOLOR Select  
Use 1 Color Packet when mixing with 12.5 lb (5.7 kg) PERMACOLOR Select

**COLORS:**

PERMACOLOR Color Kit: Available in all 40 LATICRETE colors (10 x carton) plus the top competitor colors! Each PERMACOLOR Select Color Kit contains 2 Color Packets. See Grout and Sealant Color Chart on page 84.

**PACKAGING:**

PERMACOLOR Select Grout Base:  
25 lb (11.3 kg) and 12.5 lb (5.6 kg) plastic bags



**Approximate Coverage**

Refer to page 85 for grout coverage.

**Easy to Mix**



Simply select a Color Kit from 80 PERMACOLOR Select stocked colors, then mix with PERMACOLOR Select Base, and you're ready to grout.



\* Also available in DUST LOCK™ Technology version, dramatically reducing respirable silica dust while mixing.

**PERMACOLOR® SELECT NS GROUT BASE**

Refer to Data Sheet 116.0  
26NS-0408-2



An ultra premium, factory prepared, polymer fortified unsanded portland cement base grout designed for highly-delicate surfaces, such as high polish marble and soft glass. PERMACOLOR® Select NS Grout Base should be mixed with water and LATICRETE® COLOR KITS – the industry’s first dispersible dry pigment solution. Formulated from a blend of high strength portland cement, polymers and achieves ANSI 118.7. Provides a grout joint that is dense, hard and durable in a multitude of colors. Use on joints up to 1/4" (6 mm) between soft bisque glazed wall tile, non-vitreous clay tile, marble, stone and porcelain or glass.

**FEATURES/BENEFITS:**

- Mix with water and desired PERMACOLOR Select Color Kit
- Equipped with STONETECH Sealer Technology
- Excellent for wet and dry areas
- Non-dusting, non-spalling and non-yellowing
- Non-shrinking
- Easy maintenance

**COLORS:**

See Grout and Sealant Color Chart on page 84 for a list of available colors

**PACKAGING:**

8 lb (3.6 kg) box, 4 per carton, 44 cartons per pallet

PERMACOLOR Color Kit: Available in all 40 LATICRETE colors (10 x carton) plus the top competitor colors! Each PERMACOLOR Select Color Kit contains 2 Color Packets.



Each PERMACOLOR® Select Color Kit contains two Color Packets.

Use 1 Color Packet when mixing with 8 lb (3.6 kg) PERMACOLOR Select NS

**Approximate Coverage**

Refer to page 85 for grout coverage.



**PERMACOLOR® GROUT**

Refer to Data Sheet 250.0  
25XX-0025-2/25XX-0408-2



One of the best performing cement-based grouts, for both floors and walls, and joint widths of 1/16" (1.5 mm) to 1/2" (12 mm).

**FEATURES/BENEFITS:**

- Consistent color
- High strength; fiber reinforced
- Easy to install; just mix with water — no additive required
- For both interior and exterior applications
- Meets ANSI A118.7
- Meets ISO classification CG2WA

**COLORS:**

Available in 40 LATICRETE colors. See Grout and Sealant Color Chart on page 84 for a list of available colors.

**PACKAGING:**

25 lb (11.3 kg) bag;  
104 bags per pallet

**Approximate Coverage**

Refer to page 85 for grout coverage.



**1500 SANDED GROUT**

Refer to Data Sheet 256.0  
15XX-0025-2/1544-0025-2



**1600 UNSANDED GROUT**

Refer to Data Sheet 258.0  
16XX-0408-2 /See Price Book

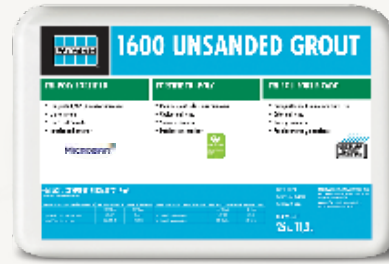

For dense, durable grout joints between 1/16" (1.5 mm) and 3/8" (9 mm).

For dense, durable grout joints 1/8" (3 mm) wide or less.

**FEATURES/BENEFITS:**

- Meets ANSI A118.6 specification

**FEATURES/BENEFITS:**

- Can be used on soft or polished stones and glass

**COLORS:**

See Grout and Sealant Color Chart on page 70 for a list of available colors.

**COLORS:**

See Grout and Sealant Color Chart on page 84 for a list of available colors.

**PACKAGING:**

25 lb (11.3 kg) bag:  
104 bags per pallet

**PACKAGING:**

8 lb (3.6 kg) box:  
4 per carton  
44 cartons per pallet

25 lb (11.3 kg) bag: (only in Bright White 44)  
104 bags per pallet

**Approximate Coverage**

Refer to page 86 for grout coverage.

**Approximate Coverage**

Refer to page 87 for grout coverage.



**SPECTRALOCK® PRO PREMIUM TRANSLUCENT GROUT†**

Refer to Data Sheet 681.0  
S-218P1-NS-02/S-218CQ-NS-00



SPECTRALOCK® PRO Premium TRANSLUCENT Grout† is a patented, extreme high performance epoxy grout that offers a unique opaque color that diffuses light and makes any design look more vibrant. It also has increased durability and stain resistance with superior ease of use and cleaning.

**FEATURES/BENEFITS:**

- Very durable
- Unique glass beads transfer light
- Stainproof‡ and easy to install
- Never needs sealing
- Use interior or exterior
- Exceeds ANSI A118.3 standards

**PACKAGING (all-in-one kits):**

**Mini Unit:**

Liquid components, Part "G" glass beads (2lbs.), gloves, sponge, and cleaning packets packed in one pail 4 units per carton/45 cartons per pallet

**Full Unit:**

Equals four SPECTRALOCK PRO Premium Grout Mini Units  
Liquid components, gloves, sponge, and cleaning packets packed in one pail/80 pails per pallet

**SPECTRALOCK PRO PREMIUM GROUT**

Refer to Data Sheet 681.0  
S-225CQ-NS-00/S-225P1-NS-02/S-225P4-NS-03



SPECTRALOCK PRO Premium Grout is a patented, high performance epoxy grout that offers color uniformity, durability and stain resistance with extraordinary ease of use.

**FEATURES/BENEFITS:**

- Improved non-sag formula
- Durable; maintains color uniformity
- Stainproof‡ and easy to install; never needs sealing
- Can be used on floors and walls
- Working time = 80 minutes
- Exceeds ANSI A118.3 standards

**COLORS:**

SPECTRALOCK Grout Part C powders are available in 40 colors. See Grout and Sealant Color Chart on page 84 for a list of available colors

**PACKAGING (liquids only kits):**

**Mini Unit:**

Liquid components, gloves, sponge, and cleaning packets packed in one pail  
4 units per carton/45 cartons per pallet

**Full Unit:**

Equals four SPECTRALOCK PRO Premium Grout Mini Units  
Liquid components, gloves, sponge, and cleaning packets packed in one pail/80 pails per pallet

**Commercial Unit:**

Equals four SPECTRALOCK PRO Premium Grout Full Units  
Liquid components, gloves, sponge, and cleaning packets packed in one carton/44 cartons per pallet

Note: SPECTRALOCK® Grout Part C filler powder required; sold separately

**Approximate Coverage**

Refer to page 86 for grout coverage.

**Approximate Coverage**

Refer to page 86 for grout coverage.



SHIPPING LIMITATION: All shipments via ground only, no air shipment allowed.

† United States Patent No.: 6881768 (and other Patents). ‡ Stainproof (residential installation only) to common household cleaners, liquids, and other goods. Clean up all spills immediately.

**SPECTRALOCK® DAZZLE™**

Refer to Data Sheet 256.0

See Price Book



Adds colorful metallic and “glow-in-the-dark” enhancements to all SPECTRALOCK® Grouts\*.

\*Does not include SPECTRALOCK 2000 IG

**FEATURES/BENEFITS:**

- Unlimited imaginative applications!
- Accentuates interior and exterior walls and floors, plain tile and stone, metallic tiles, glass tiles, mosaics, stone and listellos, pools and spas, bathrooms, hallways, and entryways



**COLORS:**

- |                       |                      |
|-----------------------|----------------------|
| 1295 Gold             | 1296 Silver          |
| 1297 Copper           | 1298 Mother-of-Pearl |
| 1299 Glow-in-the-Dark | 1270 Lemonade        |
| 1272 Pretty In Pink   | 1271 Limeade         |
| 1273 Tangerine        | 1276 Ruby Slippers   |
| 1274 Blue Hawaii      | 1277 Candied Apple   |
| 1275 Purple Haze      |                      |

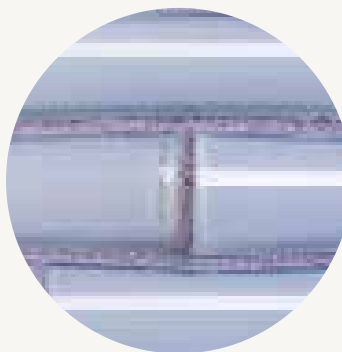

**PACKAGING:**

1 x jar DAZZLE™; 2 per carton

Mixing	
SPECTRALOCK® PRO Premium Grout† or SPECTRALOCK PRO Grout Liquids	Amount of SPECTRALOCK DAZZLE Required
Mini Unit	1 x jar DAZZLE
Full Unit	4 x jar DAZZLE
Commercial Unit	16 x jar DAZZLE
SPECTRALOCK 1 (1 gal unit)	2 x jar DAZZLE

**SPECTRALOCK® PRO GROUT<sup>1</sup>**

Refer to Data Sheet 685.0  
S-216P1-NS-02/S-216P4-NS-03



For use on floors and walls for color uniformity, durability, and stain resistance.

**FEATURES/BENEFITS:**

- Easy to use
- Never needs sealing
- Working time = 80 minutes
- Meets ANSI A118.3 standards

**COLORS:**

SPECTRALOCK® Grout Part C powders are available in 40 colors. See Grout and Sealant Color Chart on page 84 for a list of available colors

**PACKAGING (liquid only kits):**

**Mini Unit:**

Liquid components, gloves, sponge, and cleaning packets packed in one pail  
4 units per carton/45 cartons per pallet

**Full Unit:**

Equals four SPECTRALOCK PRO Grout Mini Units  
Liquid components, gloves, sponge, and cleaning packets packed in one pail / 80 pails per pallet

**Commercial Unit:**

Equals four SPECTRALOCK PRO Grout Full Units  
Liquid components, gloves, sponge, and cleaning packets packed in one carton / 44 cartons per pallet

Note: SPECTRALOCK® Grout Part C filler powder required; sold separately

**Approximate Coverage**

Refer to page 86 for grout coverage.

**SPECTRALOCK GROUT PART C POWDERS**

Refer to Data Sheet 685.0  
12XX-0402-2/12XX-0409-2



For use with SPECTRALOCK PRO Premium Grout AB liquids, SPECTRALOCK PRO Grout Part AB liquids, and SPECTRALOCK 2000 IG Part AB. **Liquids required; sold separately.**

**FEATURES/BENEFITS:**

- Excellent color uniformity
- Never needs sealing

**COLORS:**

Available in 40 colors. See Grout and Sealant Color Chart on page 84 for a list of available colors

**PACKAGING:**

**Mini Unit:**

2 lb (0.9 kg) container  
4 containers per carton  
126 cartons per pallet

**Full Unit:**

9 lb (4.1 kg) container  
4 containers per carton  
44 cartons per pallet

Note: SPECTRALOCK PRO Premium Grout Part AB Liquids, SPECTRALOCK PRO Grout Part AB Liquids, and SPECTRALOCK 2000 IG Part AB Liquids required; sold separately.

**Approximate Coverage**

Refer to page 86 for grout coverage.





**SPECTRALOCK® 1**

Refer to Data Sheet 36589  
31XX-0001-2  
See Price Book



SPECTRALOCK® 1 is a patent pending, professional grade pre-mixed grout that offers all the benefits of SPECTRALOCK epoxy grout without the hassle of mixing. It provides exceptional durability, extreme versatility, and excellent color consistency – even in the most demanding applications.

**FEATURES/BENEFITS:**

- Locks in color and blocks out stains
- Strongest pre-mixed grout on the market (meets ANSI A118.3)\*
- No mixing required
- Resealable package
- No sealing required
- Low VOC and low odor – contains no epoxy resins

**COLORS:**

Available in 40 LATICRETE colors. See Grout and Sealant Color Chart on page 84 for a list of available colors.

**PACKAGING**

1 gal (3.8 L) pail, 14 lb (6.3 kg)

**READY-TO-USE™ GROUT**

Refer to Data Sheet 027.0  
23XX-0014-2  
See Price Book



READY-TO-USE™ Grout is an advanced professional-grade, ready-to-use premixed grout that delivers superior color consistency combined with excellent stain resistance.

**FEATURES/BENEFITS:**

- Easy to use and clean
- No mixing required
- No sealing required
- Maximum stain resistance
- Inhibits the growth of stain-causing mold and mildew in the grout joints
- Tough, durable and crack resistant
- Non-sag formula for walls and floors
- For maximum stain resistance use SPECTRALOCK® PRO Premium Grout\*

**COLORS:**

Available in 40 LATICRETE colors. See Grout and Sealant Color Chart on page 84 for a list of available colors.

**PACKAGING**

1 gal (3.8 L) pail, 14 lb (6.3 kg)

**Approximate Coverage**

Refer to page 87 for grout coverage.

**Approximate Coverage**

Refer to page 87 for grout coverage.



\*Meets or exceeds ANSI A118.3 specific test designation 5.6.

**SPECTRALOCK® 2000 IG**

Refer to Data Sheet 030.0  
See Price Book



Three-part, 100% solids epoxy grout for maximum chemical, stain, and temperature resistance. Recommended for industrial and commercial food processing applications, dairies, breweries, meat packing plants, clean-in-place rooms, veterinary hospitals, kennels, and commercial kitchens.

**FEATURES/BENEFITS:**

- Easy to install and clean
- Unaffected by many acids, corrosives, and solvents
- Fast curing — ideal for same-day installations
- Exceeds ANSI A118.3, ANSI A118.5 requirements
- Exceeds ISO 13007-3 RG requirements

**COLORS:**

See Grout and Sealant Color Chart on page 84 for a list of available colors

**PACKAGING:**

**#2 Unit Pail Kit (complete unit):**

Unit net weight 28.5 lb (12.9 kg)  
48 pails per pallet

**#2 Unit Pail (liquid only):**

Unit net weight 10.5 lb (4.8 kg)  
48 pails per pallet

**#4 Unit Carton (liquid only):**

Unit net weight 16 lb (7.3 kg)  
56 cartons per pallet

**MIXING:**

Use SPECTRALOCK® Grout Part C Powders

**PREMIUM ACRYLIC CAULK**

Refer to Data Sheet 6257.0  
72XX-0601-2 & 71XX-0601-2



A siliconized acrylic latex sealant for interior use on ceramic tile and stone. For use in bathrooms, kitchens, and floors.

**FEATURES/BENEFITS:**

- Resists staining, mold, mildew
- Cleans up easily with water
- Matches all LATICRETE® grout colors
- Available in sanded and unsanded finishes

**COLORS:**

See Grout and Sealant Color Chart on page 84 for a list of available colors

**PACKAGING:**

10.5 oz (310 ml) cartridges  
6 cartridges per carton  
240 cartons per pallet

**SPECTRALOCK 2000 IG #2 Unit Pail with #22 Midnight Black (2000-SL0001-21)**

This product is recommended and designed for use in installations where the highest chemical resistance is necessary. These would include areas where there is heavy use of no-rinse cleaners, commonly known as "back-of-house" installations such as commercial kitchens. This product uses SPECTRALOCK #22 Midnight Black Part C Powder only (Included in pail).

**SPECTRALOCK 2000 IG Grey #2 Unit Pail (2000- SL0001-23) and #4 Commercial Unit liquids (S-2000C- SL-03 / S-2000P-SL-03)**

These products are recommended to be used within applications such as; commercial "front-of-house" and other general commercial and industrial type projects. These products can be used with ALL LATICRETE SPECTRALOCK Grout Part C Powders (except #44 Bright White).

**Approximate Coverage**

Refer to page 87 for grout coverage.



**Approximate Coverage Per cartridge**

THICKNESS

COVERAGE

1/4" x 1/4" (6 x 6 mm)

25 linear ft (7.62 m)



**LATASIL™**

Refer to Data Sheet 6200.1  
62XX-0120-2



A 100% silicone sealant for use in coves, corners, changes in plane, and expansion joints in exterior and interior applications of tile and stone.

**FEATURES/BENEFITS:**

- Can be used in swimming pools and other wet areas
- Conforms to ASTM C920 and ASTM C794 adhesion properties
- Ideal for bathrooms, kitchens, floors and other areas where sealant (caulk) is needed

**COLORS:**

Available in 40 colors plus Clear. See Grout and Sealant Color Chart on page 84 for a list of available colors

**PACKAGING:**

10.3 oz (305 ml) cartridges  
6 cartridges per carton, 240 cartons per pallet  
5 Gal. (18.9 L) pails

Contact your LATICRETE Representative or Distributor for more information.

**LATASIL 9118 PRIMER**

Refer to Data Sheet 6528.1  
9118-0601-2



Increases adhesion for porous stone, submerged, and permanent wet areas.

**FEATURES/BENEFITS:**

- Ultimate bond for decorative wear surfaces
- Easily roller applied
- Provides a barrier between decorative wear surfaces and substrate below
- Required for applications where LATASIL™ will be used with porous stone, submerged and permanent wet areas

**PACKAGING:**

8 oz (240 ml) bottle; 5 bottles per carton;  
50 cartons per pallet

Approximate Coverage Per cartridge	
THICKNESS	COVERAGE
1/4" x 1/4" (6 x 6 mm)	25 linear ft (7.62 m)
3/8" x 3/8" (9 x 9 mm)	11 linear ft (3.35 m)

Approximate Coverage Per cartridge	
THICKNESS	COVERAGE
1/4" x 1/4" (6 x 6 mm)	350 linear ft (106 m)



Introducing thousands of customizable color options with PERMACOLOR® Select ANYCOLOR™!

With PERMACOLOR® Select AnyColor™, we can match THOUSANDS of colors, including the vast Pantone(R), Benjamin Moore® or Sherwin-Williams® color palettes! Visit [www.laticrete.com/ANYCOLOR](http://www.laticrete.com/ANYCOLOR) for more details.



Scan for thousands of customizable color options with AnyColor

LATICRETE® and LATAPOXY® Grout and Sealant Selection Key

AVAILABLE IN ALL 40 COLORS:

- SPECTRALOCK® PRO Premium Grout†
- SPECTRALOCK PRO Grout†
- SPECTRALOCK 1
- PERMACOLOR® Select
- PERMACOLOR Select NS
- PERMACOLOR Grout\*
- Premium Acrylic Caulk Sanded

▲ LATAFIL™ Also available in Clear

RTU READY-TO-USE™ Also available in Translucent

SPECTRALOCK Dazzle™ (Gold, Silver, Copper, and Mother-of-Pearl) can be mixed with all 40 colors of SPECTRALOCK PRO Premium Grout or SPECTRALOCK PRO Grout.

AVAILABLE IN SELECTED COLORS:

- SL SPECTRALOCK PRO Premium Translucent Grout
- 1500 1500 Sanded Grout 25 lbs (11.3 kg)
- 1600 1600 Unsanded Grout 8 lbs (3.62 kg) #44 Bright White also available in 25lb (11.3 kg) bag
- 2KIG SPECTRALOCK 2000 IG Not available in #44 Bright White. SPECTRALOCK 2000 IG #2 ONLY available in 22 MIDNIGHT BLACK
- PACU Premium Acrylic Caulk Unsanded

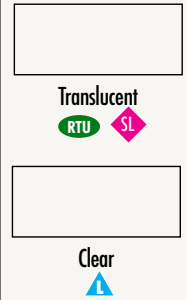

New Color



09 Frosty

New Color

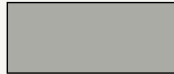

87 Stormy Grey

New Color



93 Fossil

New Color



94 Walnut

New Color



95 Mink

New Color

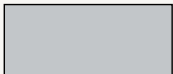

96 Steamship

New Color



97 Iron

44 Bright White

1500 1600 PACU



39 Mushroom

1500 1600 PACU

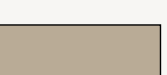

40 Latte

1500 1600 PACU



57 Hot Cocoa

2KIG

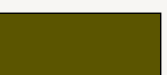

67 Autumn Green

2KIG



89 Smoke Grey

1500 1600 PACU



60 Dusty Grey

2KIG PACU



18 Sauterne

PACU



81 Butter Cream

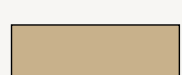

61 Parchment

PACU

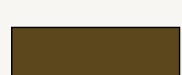

66 Chestnut Brown

2KIG

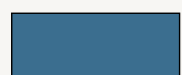

53 Twilight Blue

2KIG

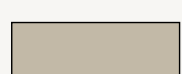

90 Light Pewter

1500 1600 PACU

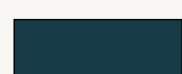

45 Raven

2KIG PACU



85 Almond

PACU

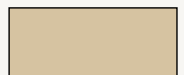

52 Toasted Almond

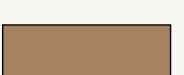

30 Sand Beige

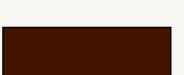

59 Espresso

2KIG

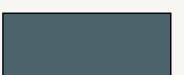

42 Platinum

2KIG PACU

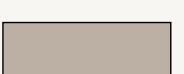

78 Sterling Silver

1500 1600 PACU

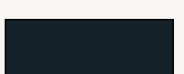

22 Midnight Black

2KIG PACU

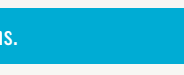

NOTE: Grout color availability subject to change. Visit [www.laticrete.com](http://www.laticrete.com) for the most current color selections.

**PERMACOLOR® Select Base/PERMACOLOR Grout**

United States Patent No.: 6,784,229 (and other Patents).

Tile Size	1/16"	1/8"	1/4"	3/8"	1/2"
1 x 1 x 1/4"	105	54	29	21	17
2 x 2 x 1/4"	207	105	54	38	29
4-1/4 x 4-1/4 x 5/16"	349	176	89	60	46
6 x 6 x 1/2"	308	155	78	53	40
12 x 12 x 3/8"	818	410	206	138	104
13 x 13 x 3/8"	886	444	223	149	113
16 x 16 x 3/8"	1090	546	274	183	138
18 x 18 x 3/8"	1226	614	308	206	155

Tile Size	1.5 mm	3 mm	6 mm	9 mm	12 mm
25 x 25 x 6 mm	10.8	5.6	3.0	2.1	1.7
50 x 50 x 6 mm	21.2	10.8	5.6	3.8	3.0
106 x 106 x 7.5 mm	35.7	18.0	9.1	6.2	4.7
150 x 150 x 12 mm	31.5	15.8	8.0	5.4	4.1
300 x 300 x 9 mm	83.8	42.0	21.1	14.1	10.7
325 x 325 x 9 mm	90.7	45.5	22.8	15.3	11.5
400 x 400 x 9 mm	111.6	55.9	28.1	18.8	14.1
425 x 425 x 9 mm	118.6	59.4	29.8	19.9	15.0

Approximate ft<sup>2</sup> (m<sup>2</sup>) coverage per 25 lb (11.3 kg) unit.

**PERMACOLOR Select NS Base**

United States Patent No.: 6,784,229 (and other Patents).

Tile Size	Joint Width			
	1/16"	1/8"	3/16"	1/4"
1 x 1 x 1/4"	34	17	12	9
2 x 2 x 1/4"	66	34	23	17
4-1/4 x 4-1/4 x 5/16"	111	56	37	28
6 x 6 x 5/16"	156	79	53	40
12 x 12 x 3/8"	261	131	87	66
24 x 24 x 3/8"	520	261	173	131

Tile Size	1.5 mm	3 mm	4.5 mm	6 mm
25 x 25 x 6 mm	3.4	1.8	1.2	0.9
50 x 50 x 6 mm	6.8	3.4	2.3	1.8
106 x 106 x 7.5 mm	11.4	5.7	3.8	2.9
150 x 150 x 7.5 mm	13.4	6.7	4.5	3.4
300 x 300 x 9 mm	26.7	13.4	8.9	6.7
600 x 600 x 9 mm	53.3	26.7	17.8	13.4

Approximate ft<sup>2</sup> (m<sup>2</sup>) coverage per 8 lb unit.

**1500 SANDED & 1600 UNSANDED:**

- 44 - BRIGHT WHITE    40 - LATTE    78 - STERLING SILVER    89 - SMOKE GREY    88 - SILVER SHADOW  
 90 - LIGHT PEWTER    39 - MUSHROOM    24 - NATURAL GREY    17 - MARBLE BEIGE    23 - ANTIQUE WHITE

**Grout and sealant Color Guidelines**

Grout and sealant samples are guides only. LATICRETE does not warrant color matching to this color chart or to any color guide produced. Actual shade and texture will depend on job site conditions, lighting, installation techniques and types of tile or stone used, and may vary from this grout color chart, grout color channel kits and grout color swatch on product packaging. Verify actual appearance and compatibility with a test area before installing. Blend grouts with different control numbers. Follow ANSI A108.10/MMSA Bulletin #9 grouting practices. No claims for color shade variations will be honored.

Calculated coverage indicated is approximate, based on "nominal" tile size and is provided for purposes of estimation only. Actual coverage will vary depending on job site conditions, actual tile size and installed grout joint size. Add 10% for waste, spillage and clean-up, and another 10% - 15% when grouting unglazed quarry tile. Expanded coverage tables at [www.laticrete.com/coverage](http://www.laticrete.com/coverage).

**SPECTRALOCK® PRO Premium Grout/SPECTRALOCK PRO Grout**

United States Patent No.: 6881768 (and other Patents).

Tile Size	Joint Width				
	1/16"	1/8"	1/4"	3/8"	1/2"
1 x 1 x 1/4"	41	21	11	8	7
2 x 2 x 1/4"	81	41	21	15	11
4-1/4 x 4-1/4 x 5/16"	136	69	35	24	18
6 x 6 x 1/2"	120	60	31	21	16
12 x 12 x 3/8"	320	160	81	54	41
13 x 13 x 3/8"	347	174	87	58	44
16 x 16 x 3/8"	426	214	107	72	54
18 x 18 x 3/8"	480	240	121	81	61
Tile Size	1.5 mm	3 mm	6 mm	9 mm	12 mm
25 x 25 x 6 mm	4.2	2.2	1.2	0.8	0.7
50 x 50 x 6 mm	8.3	4.2	2.2	1.5	1.2
106 x 106 x 7.5 mm	14.0	7.0	3.6	2.4	1.8
150 x 150 x 12 mm	12.3	6.2	3.1	2.1	1.6
300 x 300 x 9 mm	32.8	16.4	8.3	5.5	4.2
325 x 325 x 9 mm	35.5	17.8	8.9	6.0	4.5
400 x 400 x 9 mm	43.7	21.9	11.0	7.3	5.5
450 x 450 x 9 mm	49.1	24.6	12.3	8.3	6.2

Approximate ft<sup>2</sup> (m<sup>2</sup>) coverage per full unit.

**1500 Sanded Grout**

Tile Size	Joint Width				
	1/16"	1/8"	1/4"	3/8"	1/2"
1 x 1 x 1/4"	98	51	27	20	16
2 x 2 x 1/4"	194	98	51	35	27
4-1/4 x 4-1/4 x 5/16"	326	164	83	56	43
6 x 6 x 1/2"	287	144	73	49	37
12 x 12 x 3/8"	764	383	193	129	97
13 x 13 x 3/8"	828	415	208	140	105
16 x 16 x 3/8"	1018	510	256	171	129
18 x 18 x 3/8"	1145	574	288	193	145
Tile Size	1.5 mm	3 mm	6 mm	9 mm	12 mm
25 x 25 x 6 mm	10.1	5.2	2.8	2.0	1.6
50 x 50 x 6 mm	19.8	10.1	5.2	3.6	2.8
106 x 106 x 7.5 mm	33.3	16.8	8.5	5.8	4.4
150 x 150 x 12 mm	29.4	14.8	7.5	5.0	3.8
300 x 300 x 9 mm	78.3	39.2	19.7	13.2	10.0
325 x 325 x 9 mm	84.8	42.5	21.3	14.3	10.8
400 x 400 x 9 mm	104.3	52.2	26.2	17.5	13.2
425 x 425 x 9 mm	110.8	55.5	27.8	18.6	14.0

Approximate ft<sup>2</sup> (m<sup>2</sup>) coverage per 25 lb (11.3 kg) unit.

**1600 Unsanded Grout**

Tile Size	Joint Width	
	1/16"	1/8"
4-1/4 x 4-1/4 x 5/16"	144	72
6 x 6 x 5/16"	202	102
Tile Size	1.5 mm	3 mm
106 x 106 x 7.5 mm	14.7	7.4
150 x 150 x 7.5 mm	21.0	10.7

Approximate ft<sup>2</sup> (m<sup>2</sup>) coverage per 8 lb (3.6 kg) unit.

**SPECTRALOCK® 2000 IG**

Tile Size	Joint Width		
	1/4"	3/8"	1/2"
4 x 8 x 1-3/16"	29	19	15
6 x 6 x 1/2"	77	52	39
Tile Size	6 mm	9 mm	12 mm
100 x 200 x 30 mm	2.8	1.9	1.4
150 x 150 x 12 mm	8.2	5.6	4.3

Approximate ft<sup>2</sup> (m<sup>2</sup>) coverage per #2 unit.

**SPECTRALOCK 1/READY-TO-USE™ Grout**

Tile Size	Joint Width					
	1/16"	1/8"	3/16"	1/4"	3/8"	1/2"
1 x 1 x 1/4"	53	27	19	15	11	9
2 x 2 x 1/4"	104	53	36	27	19	15
6 x 6 x 1/4"	310	156	104	79	53	40
8 x 8 x 3/8"	275	138	92	70	47	35
12 x 12 x 3/8"	412	206	138	104	70	52
18 x 18 x 3/8"	617	309	206	155	104	78
24 x 6 x 3/8"	329	165	110	83	55	42
24 x 12 x 3/8"	549	275	183	138	92	69
Tile Size	1.5 mm	3 mm	4.5 mm	6 mm	9 mm	12 mm
25 x 25 x 6 mm	5.4	2.8	1.9	1.5	1.1	0.9
50 x 50 x 6 mm	10.7	5.4	3.7	2.8	1.9	1.5
150 x 150 x 6 mm	31.7	15.9	10.7	8.0	5.4	4.1
200 x 200 x 9 mm	28.1	14.1	9.5	7.1	4.8	3.6
300 x 300 x 9 mm	42.2	21.1	14.1	10.6	7.1	5.4
460 x 460 x 9 mm	64.6	32.4	21.6	16.2	10.9	8.2
610 x 150 x 9 mm	33.8	16.9	11.3	8.5	5.7	4.3
610 x 300 x 9 mm	56.5	28.3	18.9	14.2	9.5	7.1

Approximate ft<sup>2</sup> (m<sup>2</sup>) coverage per 1 Gallon (3.8 L) unit.

**Grout and sealant Color Guidelines**

Grout and sealant samples are guides only. LATICRETE does not warrant color matching to this color chart or to any color guide produced. Actual shade and texture will depend on job site conditions, lighting, installation techniques and types of tile or stone used, and may vary from this grout color chart, grout color channel kits and grout color swatch on product packaging. Verify actual appearance and compatibility with a test area before installing. Blend grouts with different control numbers. Follow ANSI A108.10/MMSA Bulletin #9 grouting practices. No claims for color shade variations will be honored.

Calculated coverage indicated is approximate, based on "nominal" tile size and is provided for purposes of estimation only. Actual coverage will vary depending on job site conditions, actual tile size and installed grout joint size. Add 10% for waste, spillage and clean-up, and another 10% – 15% when grouting unglazed quarry tile. Expanded coverage tables at [www.laticrete.com/coverage](http://www.laticrete.com/coverage).

# Worry Less & Enjoy Life More



Tile & Stone Care & Maintenance



*Protect surfaces against stains and continuously fight the growth of bacteria, mold and mildew with STONETECH® BulletProof® Sealer enhanced with Microban Antimicrobial Technology.*



**STONETECH® BULLETPROOF® SEALER**



The premium, water-based penetrating sealer, designed to provide maximum protection against the toughest oil and water-based stains and antimicrobial protection on the most porous natural stone, tile, masonry, and grout surfaces.

**RECOMMENDED SURFACES:**

For porous natural stone, tile, masonry and grout such as Marble, Granite, Basalt, Limestone, Bluestone, Travertine, Sandstone, Flagstone, Quartzite, and Saltillo Tile. Best suited for the most porous stone surfaces.

**FEATURES/BENEFITS:**

- Offers maximum stain protection
- Built with Microban antimicrobial technology
- Continuously inhibits the growth of bacteria, mold and mildew on the sealed surface
- Best protection for the most porous natural stone, tile, masonry and grout
- Breathable, penetrating natural look sealer preserves the original look of the surface
- Preserves the original look of the surface
- Water-based formula - better for you and the environment
- For interior and exterior use
- Professional grade

US ITEM #	PACKAGE SIZE	CASE
ST302-1216	pint 16 oz (473 ml)	12
ST302-0632	quart 32 oz (946 ml)	6
ST302-0401	gal (3.8 L)	4
ST302-0105	5 gal (18.9 L)	1
ST302-1202	2 oz (59 ml)	12
ST302-0155*	55 gal (208 L) drum	1



See your LATICRETE Sales Representative for approved Canadian item numbers. See data sheet 230.30ST for warranty information  
 \*Available in 3 weeks or less. Ask your customer service representative.

**STONETECH HEAVY DUTY SEALER**



The heavy duty, water-based penetrating sealer that provides advanced stain and antimicrobial protection on a variety of stones, all while preserving the natural look of the stone.

**RECOMMENDED SURFACES:**

Natural stone and masonry surfaces such as Marble, Granite, Limestone, Slate, Bluestone, Quartzite, Travertine, Sandstone, Flagstone, and Saltillo Tile.

**FEATURES/BENEFITS:**

- Offers advanced stain protection
- Built with Microban antimicrobial technology
- Continuously inhibits the growth of bacteria, mold and mildew on the sealed surface
- Breathable, penetrating natural look sealer preserves the original look of the surface
- Protects natural stone, tile, masonry, and grout
- Preserves the original look of the surface
- Water-based formula - better for you and the environment
- For internal and exterior use
- Professional grade

US ITEM #	PACKAGE SIZE	CASE
ST309-1216	pint 16 oz (473 ml)	12
ST309-0632	quart 32 oz (946 ml)	6
ST309-040	gal (3.8 L)	4
ST309-0105	5 gal (18.9 L)	1
ST309-1202	2 oz (59 ml)	12



See data sheet 230.25ST for warranty information

## STONETECH STONE, TILE & GROUT SEALER



The water-based, penetrating sealer that protects against stains on natural stone, tile, masonry and grout.

### RECOMMENDED SURFACES:

Natural stone such as Polished Marble, Homogeneous Granite, Polished Limestone, Slate, and Polished Travertine.

### FEATURES/BENEFITS:

- Stain protection
- Protects natural stone, tile, masonry, and grout
- Preserves the original look of the surface
- Water-based formula
- For internal and exterior use

US ITEM #	PACKAGE SIZE	CASE
ST335-0632	quart 32 oz (946 ml)	6
ST335-0401	gal (3.8 L)	4
ST335-1202	2 oz (59 ml)	12



See data sheet 230.10ST for warranty information

**STONETECH® IMPREGNATOR PRO® SEALER**



The solvent based, penetrating sealer that provides advanced stain protection on natural stone, tile, masonry, and grout surfaces.

**RECOMMENDED SURFACES:**

Natural stone such as Granite, Limestone, Slate, Bluestone, Travertine, and Sandstone.

**FEATURES/BENEFITS:**

- Advanced stain protection
- Protects natural stone, tile, masonry, and grout
- Preserves the original look of the surface
- Solvent-based formula
- For interior and exterior use
- Professional grade

US ITEM #	PACKAGE SIZE	CASE
ST317-1216	pint 16 oz (473 ml)	12
ST317-0632	quart 32 oz (946 ml)	6
ST317-0401	gal (3.8 L)	4
ST317-0105	5 gal (18.9 L)	1
ST317-1202	2 oz (59 ml)	12

**STONETECH QUARTZ & PORCELAIN TILE SEALER**



The water-based sealer, designed to protect quartz, porcelain tile and medium to dense surfaces from oil and water based stains, all while preserving the natural look of the surface.

**RECOMMENDED SURFACES:**

Quartz, engineered stone and tile surfaces such as: Quartz, Polished Marble, Polished Granite, Porcelain Tile, and Ceramic Tile.

**FEATURES/BENEFITS:**

- Provides oil, water, and stains protection
- Built with Microban antimicrobial technology
- Continuously inhibits the growth of bacteria, mold and mildew on the sealed surface
- Designed for quartz, tile, and engineered stone
- Preserves the original look of the surface
- Water-based formula - better for you and the environment
- For internal and exterior use
- Suitable for food areas

US ITEM #	PACKAGE SIZE	CASE
ST314-0632	quart 32 oz (946 ml)	6
ST314-1202	2 oz (59 ml)	12



May be subject to Volatile Organic Compound sales restrictions at the state, county and/or city level. Please see [www.laticrete.com](http://www.laticrete.com) for further guidance. See your LATICRETE Sales Representative for approved Canadian item numbers. See data sheet 230.25ST for warranty information

**STONETECH  
SALT WATER-RESISTANT SEALER**



The water-based, penetrating sealer formulated to protect exterior surfaces from salt degradation due to salt water and de-icing salt exposure.

**RECOMMENDED SURFACES:**

Best suited for porous substrates. Treatment around salt water pools: Natural Stone, Porous Tile, Concrete Pavers, Terracotta, and Grout. Protection against de-icing salts: Poured Concrete, Aggregate, Pavers, and Flagstone. Not intended for use on surfaces that have previously been exposed to salt water and/or de-icing salts.

**FEATURES/BENEFITS:**

- Maximum protection against salt water and de-icing salt damage
- Protects porous natural stone, masonry and grout
- Weather and UV-resistant
- Water-based formula - better for you and the environment
- For exterior use

US ITEM #	PACKAGE SIZE	CASE
ST334-0401	gal (3.8 L)	4
ST334-0105	5 gal (18.9 L)	1
ST334-1202	2 oz (59 ml)	12

**STONETECH HEAVY DUTY EXTERIOR SEALER**



The solvent based sealer designed for exterior surfaces offers advanced stain protection and weather resistance on natural stone, masonry and grout.

**RECOMMENDED SURFACES:**

Natural stone and masonry surfaces such as Granite, Slate, Travertine, Sandstone, Tumbled Stone, and Concrete.

**FEATURES/BENEFITS:**

- Advanced protection against water-based stains
- Protects natural stone, masonry, and grout
- Minimizes efflorescence and repels water
- Provides weather resistance
- Solvent-based formula
- For exterior use

US ITEM #	PACKAGE SIZE	CASE
ST308-0632	quart 32 oz (473 ml)	6
ST308-0401	gal (3.8 L)	4
ST308-0105	5 gal (18.9 L)	1
ST308-1202	2 oz (59 ml)	12



May be subject to Volatile Organic Compound sales restrictions at the state, county and/or city level. Please see [www.laticrete.com](http://www.laticrete.com) for further guidance.

**STONETECH® HEAVY DUTY GROUT SEALER**

The water-based, penetrating sealer designed for cement-based grouts that offers advanced protection against oil and water-based stains.

**RECOMMENDED SURFACES:**

Cement-based grout for Natural Stone, Ceramic, and Porcelain Tile.

**FEATURES/BENEFITS:**

- Offers advanced protection against oil and water based stains
- Keeps grout looking newer longer
- Improves clean-ability
- Water-based formula - better for you and the environment
- For interior and exterior use

US ITEM #	PACKAGE SIZE	CASE
ST306-0624	24 oz (709 ml) spray	6
ST306-0632	quart 32 oz (946 ml)	6
ST306-0401	gal (3.8 L)	4
ST306-1202	2oz (59 ml)	12



See data sheet 230.10ST for warranty information

**STONETECH GROUT RELEASE**



The easy-to-use, pre-grout coating that offers maximum protection on natural stone and masonry to prevent grout stains and haze, making grout installation clean-up quick and easy.

**RECOMMENDED SURFACES:**

Natural stone, masonry and concrete such as Marble, Limestone, Travertine, Slate, Sandstone, and Tumbled Stone. Not recommended for use on ceramic and porcelain tile or dense (low absorbency) stone.

**FEATURES/BENEFITS:**

- Maximum protection on natural stone and masonry
- Makes grout installation clean-up easier
- Prevents grout staining and grout haze
- Water-based formula - better for you and the environment
- For interior and exterior use

**STONETECH STAIN PROTECTING GROUT ADDITIVE**



STONETECH® Stain Protecting Grout Additive allows you to grout and seal in one easy step and ensure a lasting stain-resistant finish.

**RECOMMENDED SURFACES:**

For use with cement based sanded and unsanded grouts which allow for use of latex additives.

**FEATURES/BENEFITS:**

- Grout and seal in one easy step
- Offers protection against oil and water based stains
- Simply replaces water when mixing grout
- Will not alter grout color
- Water-based formula - better for you and the environment

US ITEM #	PACKAGE SIZE	CASE
ST305-0401	gal (3.8 L)	4

US ITEM #	PACKAGE SIZE	CASE
ST339-0627	27 oz (798 ml)	6
ST339-0464	64 oz (1.9 L)	4
ST339-0103	2.5 gal (9.5 L)	1



**STONETECH® REVITALIZER®  
CLEANER & PROTECTOR**



STONETECH® Revitalizer® Cleaner & Protector is an all-in-one formula that cleans everyday messes, all while reinforcing protection.

**RECOMMENDED SURFACES:**

Natural stone and grout such as Marble, Granite, Limestone, Travertine, Quartzite, Slate, Sandstone, and Flagstone.

**FEATURES/BENEFITS:**

- 3-in-1 Cleans, reseals and defends
- Built-in sealer reinforces stain protection
- Microban® antimicrobial technology continuously defends against the growth of bacteria, mold and mildew<sup>®</sup>
- Gentle water based formula
- Makes surfaces easier to clean
- Leaves a pleasant fragrance — in citrus or cucumber scent
- Available in ready-to-use or concentrate formulas

US ITEM #	PACKAGE SIZE	CASE
<b>CITRUS READY-TO-USE</b>		
ST328-0624-11	24 oz (709 ml) spray	12
ST328-0401-11	gal (3.8 L)	4
ST328-1202-11	2 oz (59 ml)	12
T328-0632-21	2 oz (59 ml)	12
<b>CITRUS CONCENTRATED</b>		
T328-0632-21	quart 32 oz (946 ml)	12
ST328-0401-21	gal (3.8 L)	4
ST328-0105-21	5 gal (18.9 L)	1
<b>CUCUMBER READY-TO-USE</b>		
ST328-0624-12	24 oz (709 ml) spray	12
ST328-0401-12	gal (3.8 L)	4

**STONETECH STONE & TILE CLEANER**



The daily, pH neutral cleaner, formulated to remove tough everyday spills, dirt and grease on natural stone, tile, masonry, and grout without degrading the surface.

**RECOMMENDED SURFACES:**

Natural stone, masonry, tile and grout such as Marble, Granite, Limestone, Travertine, Quartzite, Slate, Sandstone, Flagstone, Concrete, Ceramic Tile, and Porcelain Tile.

**FEATURES/BENEFITS:**

- Daily cleaner — cleans everyday messes
- Neutral pH formula — gently cleans without degrading natural stone, tile, and grout
- Removes everyday spills, dirt and grease
- Leaves a clean fresh scent
- Better indoor air quality
- Ready-to-use or concentrate formulas

US ITEM #	PACKAGE SIZE	CASE
<b>READY-TO-USE</b>		
ST341-0624-10	24 oz (709 ml) spray	12
<b>CONCENTRATED</b>		
ST341-0632-20	quart 32 oz (946 ml)	6
ST341-0401-20	gal (3.8 L)	4





## STONETECH QUARTZ & TILE CLEANER



The ready-to-use, daily cleaner that removes dust, dirt, spills and light stains from quartz, engineered stone and tile surfaces.

### RECOMMENDED SURFACES:

For quartz, engineered stone and tile surfaces such as Quartz, Polished Marble, Polished Granite, Porcelain Tile, and Ceramic Tile.

### FEATURES/BENEFITS:

- For quartz, tile, and other engineered stone
- Daily cleaner — removes everyday spill and light stains
- No rinse, water-based formula
- Leaves a clean fresh scent
- Suitable for food areas
- Low VOC — Better indoor air quality
- Great for Cambria®, Silestone®, Zodiaq®, and Caesarstone® brand surfaces

US ITEM #	PACKAGE SIZE	CASE
ST315-0624-10	24 oz (709 ml) spray	12
ST315-1202-10	2 oz (59 ml) spray	12



**STONETECH®  
STAINLESS STEEL PRO CLEANER**



The professional grade cleaner that clings onto stainless steel surfaces to eliminate grease, dust, smudges, and fingerprints and leave a streak-free finish.

**RECOMMENDED SURFACES:**

Stainless Steel. Do not use on colored Concrete, dyed Granite, and acid-sensitive stones such as Marble, Limestone, and Travertine.

**FEATURES/BENEFITS:**

- Cleans, polishes, and protects
- Leaves a streak-free finish
- Removes finger prints, smudges, water spots, and oily residues
- Professional grade — no hard scrubbing or buffing needed
- Foaming-action sprayer — avoids drips and over-spray

**STONETECH MOLD AND MILDEW  
STAIN REMOVER**



The ready-to-use, specialty cleaner that removes unsightly mold and mildew stains from natural stone, tile, masonry, and grout.

**RECOMMENDED SURFACES:**

Natural stone, tile, masonry and grout surfaces such as Marble, Granite, Limestone, Travertine, Slate, Ceramic Tile, Porcelain Tile, Glass Tile, Brick, and unpolished poured Concrete slabs.

**FEATURES/BENEFITS:**

- Eliminates unsightly mold and mildew stains
- For natural stone, tile, masonry, and grout
- Won't degrade stone or grout
- Leaves a fresh, clean scent
- Foaming action sprayer — clings onto surface to avoid drips
- No VOC

US ITEM #	PACKAGE SIZE	CASE
ST340-0624-10	24 oz (709 ml) spray	6

US ITEM #	PACKAGE SIZE	CASE
ST320-0624-10	24 oz (709 ml) spray	6



**STONETECH SOAP SCUM REMOVER**



The ready-to-use, powerful specialty cleaner formulated to remove soap scum, hard water stains, and dirt from natural stone, tile, and grout.

**RECOMMENDED SURFACES:**

Natural stone and tile surfaces such as Marble, Granite, Limestone, Travertine, Slate, Ceramic Tile, Porcelain Tile, and Glass Tile.

**FEATURES/BENEFITS:**

- Eliminates stubborn soap scum, hard water stains, and dirt
- For natural stone, tile, and grout
- Spray on foam, cleans, and shines
- Leaves a fresh, clean scent
- No VOC — better indoor air quality

**STONETECH DEEPKLENZ™ CLEANER‡**



The maximum strength cleaner, formulated to easily remove deep and stubborn dirt, grease, grime, oil, and food stains from natural stone, tile, and grout.

**RECOMMENDED SURFACES:**

Natural stone, masonry, tile and grout, such as Marble, Granite, Limestone, Travertine, Slate, Sandstone, Concrete, Ceramic Tile, Porcelain Tile, and Stainless Steel Tile. \*For other artificial stones, refer to artificial stone manufacturer.

**FEATURES/BENEFITS:**

- Maximum strength cleaner
- Easily removes deep and stubborn grease, oils, and food stains
- Cleans, degreases and prepares surface for resealing
- Water-based, alkaline formula
- Safe on stone
- Low VOC — better indoor air quality
- Ready-to-use formula

US ITEM #	PACKAGE SIZE	CASE
ST338-0624-10	24 oz (709 ml) spray	6

US ITEM #	PACKAGE SIZE	CASE
ST439-0624-10	24 oz (709 ml) spray	6



May be subject to Volatile Organic Compound sales restrictions at the state, county and/or city level. Please see [www.laticrete.com](http://www.laticrete.com) for further guidance.

‡ NOTE: Not available for sale in Canada.

**STONETECH® KLENZALL™ CLEANER**



The heavy duty strength, alkaline cleaner made to remove the toughest dirt, grease and grime on natural stone, tile, masonry, and grout.

**RECOMMENDED SURFACES:**

Natural stone, tile, masonry and grout surfaces such as Marble, Granite, Limestone, Travertine, Quartzite, Slate, Sandstone, Flagstone, Concrete, Ceramic Tile, and Porcelain Tile.

**FEATURES/BENEFITS:**

- For natural stone, tile, masonry, and grout
- Removes tough dirt, grease, and grime
- Cleans, degreases, and prepares surface for resealing
- Safe on stone, will not etch
- Water-based, alkaline formula
- Ready-to-use or concentrate formulas

US ITEM #	PACKAGE SIZE	CASE
<b>READY-TO-USE</b>		
ST319-0624-10	24 oz (709 ml) spray	6
<b>CONCENTRATED</b>		
ST319-0632-20	quart 32 oz (946 ml)	6
ST319-0401-20	gal (3.8 L)	4
ST319-0105-20	5 gal (18.9 L)	1
ST319-1202-20	2 oz (59 ml)	12



**STONETECH RESTORE™ ACIDIC CLEANER**



The heavy duty, acidic cleaner removes dirt, hard water, efflorescence and rust from tile and acid resistant stone, masonry, and grout.

**RECOMMENDED SURFACES:**

Tile, grout and natural stone such as Ceramic Tile, Porcelain Tile, Granite, Slate, and Sandstone. Do NOT use on colored concrete, dyed Granite, and acid-sensitive stones such as Marble, Limestone, and Travertine.

**FEATURES/BENEFITS:**

- Heavy Duty Cleaner for tile and acid resistant stone, masonry, and grout
- Removes dirt, hard water deposits, efflorescence, and rust
- Renews the look of the surface
- Water-based, acidic formula
- No VOC — better indoor air quality

US ITEM #	PACKAGE SIZE	CASE
ST327-0632-20	quart 32 oz (946 ml)	6
ST327-0401-20	gal (3.8 L)	4
ST327-0105-20	5 gal (18.9 L)	1
ST327-1202-20	2 oz (59 ml)	12



**STONETECH EPOXY GROUT HAZE & COATING STRIPPER - GEL<sup>‡</sup>**



The fast-acting, water-based gel that dissolves epoxy grout haze and tough coatings in minutes.

**RECOMMENDED SURFACES:**

Natural stone, tile, masonry surfaces such as granite, marble, limestone, bluestone, travertine, sandstone, slate, flagstone, quartzite, concrete, saltillo tile, quarry tile, ceramic tile and porcelain tile. Not for use on highly sensitive marbles.

**FEATURES/BENEFITS:**

- For natural stone, tile and masonry
- Eliminates epoxy grout haze in 10 minutes or less
- Removes epoxy grout haze and tough coatings — varnish, lacquer, sealer, wax, paint, polyurethane, and acrylic
- Fast-acting, non-runny gel — great for vertical and horizontal applications
- Water-based formula
- Low odor, low VOC and non-flammable
- No Methylene Chloride

US ITEM #	PACKAGE SIZE	CASE
ST316-0632-11	quart 32 oz (946 ml)	6
ST316-0401-11	gal (3.8 L)	4
ST316-1202-11	2 oz (59 ml)	12

**STONETECH GROUT HAZE REMOVER (For cement base)**



The heavy duty cleaner designed to remove cementitious grout haze and residue left from installation.

**RECOMMENDED SURFACES:**

Natural stone, tile and Masonry Surfaces such as: Marble, Granite, Slate, Limestone, Travertine, Sandstone, Concrete, Ceramic and Porcelain tile.

**FEATURES/BENEFITS:**

- Removes grout haze and residue
- Reduces overall installation time
- Maximum strength formula

US ITEM #	PACKAGE SIZE	CASE
	quart 32 oz (946 ml)	6



<sup>‡</sup> NOTE: Not available for sale in Canada.

**STONETECH® OIL STAIN REMOVER**



The ready-to-use, problem solving solution to removing deep-set oil-based stains from natural stone, masonry, and grout.

**RECOMMENDED SURFACES:**

Natural stone, masonry and cementitious grout such as Marble, Granite, Limestone, Travertine, Quartzite, Slate, Sandstone, and Concrete.

**FEATURES/BENEFITS:**

- For natural stone, masonry, and grout
- Pulls out deep-set oil and grease stains
- Ready-to-use, just stir and apply
- Leaves no permanent residue

US ITEM #	PACKAGE SIZE	CASE
ST322-0603-11	3 oz (89 ml) can	6
ST322-0616-11	pint (473 ml) can	6

**STONETECH STONE POLISH**



The enhancing polish, that restores the luster of polished natural stone by adding a non-greasy, streak-free protective shine.

**RECOMMENDED SURFACES:**

Polished natural stone such as: Marble, Granite, Limestone, Travertine, and Quartzite. NOT FOR USE ON FLOORS. MAY CREATE SLIPPING HAZARD.

**FEATURES/BENEFITS:**

- Shines, protects and restores
- Restores the luster of polished stone
- Leaves non-greasy, streak-free brilliant shine
- Quick and easy touch up
- Water-based formula — better for you and the environment
- Great for kitchen and bathroom countertops and vanities

US ITEM #	PACKAGE SIZE	CASE
ST313-0624	24 oz (709 ml) spray	6
ST313-1202	2 oz (59 ml)	12



See your LATICRETE Sales Representative for approved Canadian item numbers.

**STONETECH ENHANCER PRO™ SEALER**



The color enhancing, penetrating sealer that provides a maximum deep rich color and stain protection on natural stone, masonry, and grout.

**RECOMMENDED SURFACES:**

Natural stone, masonry and grout such as Bluestone, Slate, Travertine, Sandstone, Limestone, Flagstone, Textured Stone, Flamed Stone, and Tumbled Stone.

**FEATURES/BENEFITS:**

- Deepens color of porous natural stone, masonry, and grout
- Maximum stain protection — no gloss
- For interior and exterior use
- Weather and UV resistant
- Solvent-based formula
- Professional grade

US ITEM #	PACKAGE SIZE	CASE
ST304-1216	pint 16 oz (473 ml)	12
ST304-0632	quart 32 oz (946 ml)	6
ST304-0401	gal (3.8 L)	4
ST304-0105	5 gal (18.9 L)	1
ST304-1202	2 oz (59 ml)	12

**STONETECH ENHANCER & SEALER**



The water-based, color enhancing sealer that seals and enhances natural stone, masonry, and grout to a deep rich color.

**RECOMMENDED SURFACES:**

Unpolished natural stone, masonry, and grout surfaces such as Bluestone, Slate, Travertine, Limestone, Flagstone, Textured Stone, Flamed Stone, Tumbled Stone, and Concrete.

**FEATURES/BENEFITS:**

- Deepens color of porous natural stone, masonry, and grout
- Provides stain protection — no gloss
- For interior use
- Easy to use, water-based formula

US ITEM #	PACKAGE SIZE	CASE
ST303-0632	quart 32 oz (946 ml)	6
ST303-040	gal (3.8 L)	4
ST303-0105	5 gal (18.9 L)	1
ST303-1202	2 oz (59 ml)	12



May be subject to Volatile Organic Compound sales restrictions at the state, county and/or city level. Please see [www.laticrete.com](http://www.laticrete.com) for further guidance.

**STONETECH® HIGH GLOSS FINISH & SEALER**



The water-based, enhancing sealer that leaves a high shine, heavy duty finish to stone, porous tile, masonry, and grout.

**RECOMMENDED SURFACES:**

Natural stone, porous tile, masonry, and grout surfaces such as Slate, Textured Limestone, Textured Travertine, Concrete, Saltillo Tile, Bluestone, Sandstone, and Flagstone. Not intended for use on glazed, honed, polished, or non-absorbing surfaces, wood floors and decks, showers, countertops, or near pool areas.

**FEATURES/BENEFITS:**

- Leaves a brilliant shine and deepens color
- Protects against water and oil based stains
- Provides a heavy duty coating
- Water-based formula — better for you and the environment
- For interior use, on textured stone, porous tile, masonry, and grout

US ITEM #	PACKAGE SIZE	CASE
ST311-0632	quart 32 oz (946 ml)	6
ST311-0401	gal (3.8 L)	4
ST311-1202	2 oz ( 59 ml)	12

**STONETECH SEMI GLOSS FINISH & SEALER**



The water-based, enhancing sealer that leaves a semi gloss, heavy duty finish on stone, porous tile, masonry, and grout.

**RECOMMENDED SURFACES:**

Natural stone, porous tile, masonry, and grout such as Slate, Textured Limestone, Textured Travertine, Concrete, Saltillo Tile, Bluestone Sandstone, and Flagstone. Not intended for use on glazed, honed, polished, or non-absorbing surfaces (Ceramic Tile, Porcelain Tile), wood floors and decks, showers, countertops, or near pool areas.

**FEATURES/BENEFITS:**

- Leaves a subtle shine and deepens color
- Protects against water and oil based stains
- Provides a heavy duty coating
- Water-based formula — better for you and the environment
- For interior use, on textured stone, porous tile, masonry, and grout

US ITEM #	PACKAGE SIZE	CASE
ST336-0632	quart 32 oz (946 ml)	6
ST336-0401	gal (3.8 L)	4
ST336-1202	2 oz (59 ml)	12



See your LATICRETE sales representative for approved Canadian item numbers.



**STONETECH HONING POWDER**



The professional grade, stone restoration honing powders that eliminate mild to deep scratches and create even honed finishes. Available in extra fine to coarse grits.

**RECOMMENDED SURFACES:**

Natural stone such as most Marble, Limestone, Travertine, and Terrazzo.

**FEATURES/BENEFITS:**

- Creates an even, honed, flat finish
- Prepares stone for polishing and shining
- Available in 180, 280, 400, 600, and 800 grit levels
- Different grits eliminate mild to deep scratches
- Non-acidic for natural stone and terrazzo
- Designed for professional use

US ITEM #	PACKAGE SIZE	CASE
	1 lb 14 oz (850 g)	
ST312-0630-180	180 grit	6
ST312-0630-280	280 grit	6
ST312-0630-400	400 grit	6
ST312-0630-600	600 grit	6
ST312-0630-800	800 grit	6

**STONETECH POLISHING POWDER**



The professional grade, stone restoration powder that eliminates etch marks and light wear patterns and creates a smooth, satin finish.

**RECOMMENDED SURFACES:**

Natural stone such as most Marble, Limestone, Travertine, and Terrazzo.

**FEATURES/BENEFITS:**

- Creates a smooth, satin finish
- Eliminates etch marks and light wear patterns
- Non-acidic for natural stone
- Designed for professional use

US ITEM #	PACKAGE SIZE	CASE
ST326-0625	1 lb 9 oz (708 g)	6

## STONETECH® COUNTERTOP WARRANTY CARE KIT



Protect your customer's countertop investment with the STONETECH® Countertop warranty program. Care kit includes STONETECH BulletProof® Sealer (quart) and STONETECH Revitalizer Cleaner & Protector — citrus scent (24 oz spray) for maximum protection and daily maintenance. Covers common household food and beverage stains — etching not included.

### RECOMMENDED SURFACES:

Granite, Marble, and select Quartzite, and Basalt countertops.

Brought to you by Protect Plus Surfaces™



Residential



Commercial



Outdoor on select granite

For further warranty program details see [www.stonetechn.com/warranty](http://www.stonetechn.com/warranty)

### FEATURES/BENEFITS:

- Guarantees stain protection from common household foods and beverages
- 25-year fully transferable residential warranty
- 15-year commercial and industrial warranty
- 1-year outdoor warranty on select granite

Sealer must be applied by a certified and trained STONETECH installer. Etching is not covered. For further details on warranty program see [www.stonetechn.com/warranty](http://www.stonetechn.com/warranty)

US ITEM #	CONTENTS	CASE
ST344-0632-KIT	BulletProof® Quart + Revitalizer® Citrus 24 oz spray	6
ST344-0155-KIT*	BulletProof, 55 gal + Revitalizer Citrus Gift box (220 units)	1



\*Special Order — See your sales representative for details and approval.



Category	Product	Concrete	Portland Cement Mortar Bed	Ceramic Tile <sup>2</sup>	Masonry	Cement Backer Board
<b>UNDERLAYMENTS</b>	NXT <sup>®</sup> Level Plus *	I <sup>12</sup>	I	I <sup>13</sup>	I	I
	NXT Level DL *	I <sup>12</sup>	I	I <sup>13</sup>	I	I
	NXT Level *	I <sup>12</sup>	I	I <sup>13</sup>	I	I
	NXT Level SP	I <sup>12</sup>	I	I <sup>13</sup>	I	I
	NXT Level Flow	I <sup>12</sup>	I	I <sup>13</sup>	I	I
	NXT Patch	E	E	E <sup>9</sup>	E	E
	NXT Skim	I	I	I	I	I
<b>SOUND CONTROL</b>	170 Sound & Crack Isolation Mat *	I	I	I	I	I
<b>ANTI-FRACTURE MEMBRANE</b>	Blue 92 Anti-Fracture Membrane	E	E	E**	E	E
	FRACTURE BAN™	E	E	E**	E	E
<b>WATERPROOFING MEMBRANES</b>	HYDRO BAN <sup>®</sup>	E	E	E**	E	E
	9235 Waterproofing Membrane	E	E	E**	E	E
	HYDRO BARRIER™	E	E	E**	E	E
	LATAPOXY <sup>®</sup> Waterproof Flashing Mortar	E	E	^^	E	E
	HYDRO BAN Sheet Membrane	E	E	E**	E	E
	HYDRO BAN Quick Cure	E	E	E**	E	E
<b>UNCOUPLING MEMBRANE</b>	STRATA_MAT™ and STRATA_MAT XT	E	E	N	N	I
<b>VAPOR REDUCTION MEMBRANE</b>	NXT Vapor Reduction Coating	I	N	N	N	N
<b>EPOXY ADHESIVES</b>	LATAPOXY 300 Adhesive	E <sup>^</sup>	E <sup>^</sup>	E <sup>^</sup>	E <sup>^</sup>	E <sup>^</sup>
	LATAPOXY BIOGREEN™ 300	E <sup>^</sup>	E <sup>^</sup>	E <sup>^</sup>	E <sup>^</sup>	E <sup>^</sup>
<b>SPOT BOND ADHESIVES</b>	LATAPOXY 310 Stone Adhesive / LATAPOXY 310 Rapid Stone Adhesive	E†	N	I	E†	I
<b>LATEX THICK-BED</b>	3701 Fortified Mortar	E	E	E	E	E
	3701 Mortar Admix with 226 Thick-Bed Mortar	E	E	E	E	E
	3701 Lite Mortar	E	E	E	E	E
	3701 Lite Mortar R	E	E	E	E	E
	Quick Cure Mortar Bed	E	E	E	E	E
<b>SOUND CONTROL/CRACK SUPPRESSION MORTAR</b>	125 TRI MAX <sup>®</sup> * United States Patent No.: 6784229 B2 (and other Patents).	I	I	I	I	I
	4-XLT and 4-XLT Rapid	E	E	E	E	E
	LHT™ Plus and LHT (mixed with 3701 Admix)	E	E	E	E	I
<b>LATEX THIN-BED</b>	3701 Mortar Admix with 272 Mortar or 317	E	E	E	E	E
<b>FLEXIBLE LATEX THIN-BED</b>	333 Flexible Additive with 272 Mortar, 317 or LHT	E <sup>4</sup>	E <sup>4</sup>	E <sup>4</sup>	E <sup>4</sup>	E <sup>4</sup>
<b>MULTI-PURPOSE THIN-SET MORTARS</b>	254 Platinum	E	E	E	E	E
	MULTIMAX™ Lite	E	E	E	E	E
	257 TITANIUM™	E	E	E	E	E
	TRI-LITE™	E	E	E	E	E
	253 Gold	E	E	E	E	E
	254R Platinum Rapid	E	E	E	E	E
	253R Gold Rapid	E	E	E	E	E
	252 Silver	E	E	I	E	I
<b>GLASS TILE INSTALLATION MORTAR</b>	Glass Tile Adhesive	E	E	E	E	E
<b>THIN-SET MORTAR</b>	272 Mortar	E <sup>4</sup>	E <sup>4</sup>	I <sup>10</sup>	E <sup>4</sup>	E <sup>10</sup>
	317 Mortar	E <sup>4</sup>	E <sup>4</sup>	I <sup>10</sup>	E <sup>4</sup>	E <sup>10</sup>
<b>MASTIC ADHESIVES</b>	15 Premium Mastic	I	I	N	I	I

E = Recommended for exterior and interior applications.

I = Recommended for interior applications only.

N = Not recommended for these applications.

1 Structurally sound, clean, free of dust, laitance, dirt, oil, grease, wax, sealers and curing compounds; floor systems over which tile or stone will be installed shall be in conformance with the International Residential Code (IRC) for residential applications, the International Building Code (IBC) for commercial applications, or applicable building codes; concrete must be 28 days old w/ 7 day damp cure unless using 3701 Latex Thin-Set Mortars or 254 Platinum are used.

2 For existing resilient flooring, ceramic tile, terrazzo, and non-water soluble curbsack adhesive – see LATICRETE Technical Data Sheet 135 – Ceramic & Stone Tile Over Existing Flooring

3 For proper plywood floor construction – see LATICRETE TDS 152 – Bonding Ceramic Tile, Stone or Brick Over Wood Floors

4 Exterior use requires gauging with 333 Flexible Additive (residential and light commercial installations that are not continuously submerged) – see data sheet 266.0 or 3701 Mortar Admix – see data sheet 231.0

5 Use as an unbonded, wire-reinforced mortar bed or installed over diamond metal lath which has been mechanically fastened to the substrate for horizontal applications; or, as a scratch coat and brown coat over diamond metal lath which has been mechanically fastened into the studs, over cleavage membrane for vertical installations

6 Exterior use limited to residential and light commercial installations that are not continuously submerged

7 Requires gauging with 3701 Mortar Admix – see data sheet 231.0

8 Requires gauging with 333 Flexible Additive – see data sheet 266.0

9 Requires surface to be abraded with a carborundum disk and cleaned thoroughly prior to application

10 Requires gauging with a LATICRETE™ Latex Additive (see recommended combinations above) for all applications

11 Prime floor with NXT™ PRIMER prior to mechanically fastening 3.2# diamond metal lath over entire substrate – see TDS 230N

12 All non-suction substrates may require bead blasting or mechanical abrasion to ensure curing compounds, sealers or other potential bond breakers are removed – see TDS 230N for guidelines and surface preparation requirements

13 Refer to TDS 230N for preparation and installation guidelines

14 OSB is also a suitable substrate for STRATA\_MAT™ - refer to DS 026.0

15 Requires mixing with NXT Embossing Admix

\* Horizontal use only. 170 Sound & Crack Isolation Mat can be turned up the wall (max. of 3" (75 mm)) in place of the perimeter isolation strip

\*\* Skim coat existing ceramic tile, stone or portland cement terrazzo with a latex thin-bed mortar first

<sup>^</sup> Do not use on exterior facades or building envelopes

<sup>^^</sup> Consult LATICRETE Technical Services for these substrates

† Consult LATICRETE Technical Services Dept. for exterior applications

◊ Floors only (Interior and exterior)

SUBSTRATES<sup>1</sup>

Category	Product	Cement Terrazzo <sup>2</sup>	Exterior Glue Plywood <sup>3</sup>	Resilient Flooring <sup>2</sup>	Gypsum Wallboard	Hi-Pressure Laminate	Steel	Data Sheet #
<b>UNDERLAYMENTS</b>	NXT <sup>®</sup> Level Plus *	I <sup>12</sup>	I <sup>11</sup>	I <sup>12</sup>	N	N	N	505.0
	NXT Level DL *	I <sup>12</sup>	I <sup>11</sup>	I <sup>12</sup>	N	N	N	029.2
	NXT Level *	I <sup>12</sup>	I <sup>11</sup>	I <sup>12</sup>	N	N	N	504.0
	NXT Level SP	I <sup>12</sup>	I <sup>11</sup>	I <sup>12</sup>	N	N	N	35609
	NXT Level Flow	I <sup>12</sup>	I <sup>11</sup>	I <sup>12</sup>	N	N	N	36623
	NXT Patch	E <sup>9</sup>	I	I	N	N	N	501.0
	NXT Skim	I	I	I <sup>15</sup>	N	N	N	506.0
<b>SOUND CONTROL</b>	170 Sound & Crack Isolation Mat *	I	I	N	N	N	N	170.0
<b>ANTI-FRACTURE MEMBRANE</b>	Blue 92 Anti-Fracture Membrane	E**	I	N	I	N	N	647.0
	FRACTURE BAN <sup>™</sup>	E	I	N	N	N	N	195.0
<b>WATERPROOFING MEMBRANES</b>	HYDRO BAN <sup>®</sup>	E**	I	N	I	N	N	663.0
	9235 Waterproofing Membrane	E**	I	N	I	N	N	236.0
	HYDRO BARRIER <sup>™</sup>	E**	I	N	I	N	N	105.0
	LATAPOXY <sup>®</sup> Waterproof Flashing Mortar	^^	^^	^^	^^	^^	^^	682.0
	HYDRO BAN Sheet Membrane	E	I	N	N	N	N	041.0
<b>UNCOUPLING MEMBRANE</b>	STRATA_MAT <sup>™</sup> and STRATA_MAT XT	I	I <sup>14</sup>	I	N	N	N	026.0
<b>VAPOR REDUCTION MEMBRANE</b>	NXT Vapor Reduction Coating	N	N	N	N	N	N	507.0
<b>EPOXY ADHESIVES</b>	LATAPOXY 300 Adhesive	E	I	I	I	I	E	633.0
	LATAPOXY BIOGREEN <sup>™</sup> 300	E	I	I	I	I	E	023.0
<b>SPOT BOND ADHESIVES</b>	LATAPOXY 310 Stone Adhesive / LATAPOXY 310 Rapid Stone Adhesive	N	I	N	N	N	I <sup>†</sup>	679.0 & 679.3
<b>LATEX THICK-BED</b>	3701 Fortified Mortar	E	I <sup>5</sup>	I <sup>5</sup>	I <sup>5</sup>	I <sup>5</sup>	I <sup>5</sup>	100.0
	3701 Mortar Admix with 226 Thick-Bed Mortar	E	I <sup>5</sup>	I <sup>5</sup>	I <sup>5</sup>	I <sup>5</sup>	I <sup>5</sup>	231.0
<b>SOUND CONTROL/CRACK SUPPRESSION MORTAR</b>	125 TRI MAX <sup>®</sup>	I	I	N	N	N	N	204.0
	4-XLT and 4-XLT Rapid	N	I	N	I	N	N	080.0 & 081.0
	LHT <sup>™</sup> Plus and LHT	E	I	I	N	N	N	180.0
<b>LATEX THIN-BED</b>	3701 Mortar Admix with 272 Mortar, or 317	E	N	N	I	N	N	231.0
<b>FLEXIBLE LATEX THIN-BED</b>	333 Flexible Additive with 272 Mortar, 317, or LHT	E <sup>6</sup>	I	I	I	I	N	266.0 259.0, 317.0
<b>MULTI-PURPOSE THIN-SET MORTARS</b>	254 Platinum	E	I	I	I	I	N	677.0
	MULTIMAX Lite	E	I	N	I	N	N	255.0
	257 TITANIUM <sup>™</sup>	E	I	N	I	N	N	292.0
	TRI-LITE <sup>™</sup>	E	I	N	I	N	N	320.0
	253 Gold	E	I	I	I	I	N	296.0
	254R Platinum Rapid	E	I	I	I	I	N	729.0
	253R Gold Rapid	E	I	I	I	I	N	296.3
	252 Silver	I	I	N	I	N	N	676.0
<b>GLASS TILE INSTALLATION MORTAR</b>	Glass Tile Adhesive Lite	E	I	N	I	N	N	36628
<b>THIN-SET MORTAR</b>	272 Mortar	I <sup>10</sup>	I <sup>8</sup>	I <sup>8</sup>	I	I <sup>8</sup>	N	259.0
	317 Mortar	I <sup>10</sup>	I <sup>8</sup>	I <sup>8</sup>	I	I <sup>8</sup>	N	317.0
<b>MASTIC ADHESIVES</b>	15 Premium Mastic	N	I	N	I	N	N	286.0

E = Recommended for exterior and interior applications.

I = Recommended for interior applications only.

N = Not recommended for these applications.

1 Structurally sound, clean, free of dust, laitance, dirt, oil, grease, wax, sealers and curing compounds; floor systems over which tile or stone will be installed shall be in conformance with the International Residential Code (IRC) for residential applications, the International Building Code (IBC) for commercial applications, or applicable building codes; concrete must be 28 days old w/ 7 day damp cure unless using 3701 Latex Thin-Set Mortars or 254 Platinum are used.

2 For existing resilient flooring, ceramic tile, terrazzo, and non-water soluble curbside adhesive – see LATICRETE Technical Data Sheet 135 – Ceramic & Stone Tile Over Existing Flooring

3 For proper plywood floor construction – see LATICRETE TDS 152 – Bonding Ceramic Tile, Stone or Brick Over Wood Floors

4 Exterior use requires gauging with 333 Flexible Additive (residential and light commercial installations that are not continuously submerged) - see data sheet 266.0 or 3701 Mortar Admix – see data sheet 231.0

5 Use as an unbonded, wire-reinforced mortar bed or installed over diamond metal lath which has been mechanically fastened to the substrate for horizontal applications; or, as a scratch coat and brown coat over diamond metal lath which has been mechanically fastened into the studs, over cleavage membrane for vertical installations

6 Exterior use limited to residential and light commercial installations that are not continuously submerged

7 Requires gauging with 3701 Mortar Admix – see data sheet 231.0

8 Requires gauging with 333 Flexible Additive – see data sheet 266.0

9 Requires surface to be abraded with a carborundum disk and cleaned thoroughly prior to application

10 Requires gauging with a LATICRETE<sup>®</sup> Latex Additive (see recommended combinations above) for all applications

11 Prime floor with NXT<sup>™</sup> PRIMER prior to mechanically fastening 3.2# diamond metal lath over entire substrate – see TDS 230N

12 All non-suction substrates may require bead blasting or mechanical abrasion to ensure curing compounds, sealers or other potential bond breakers are removed – see TDS 230N for guidelines and surface preparation requirements

13 Refer to TDS 230N for preparation and installation guidelines

14 OSB is also a suitable substrate for STRATA\_MAT<sup>™</sup> - refer to DS 026.0

15 Requires mixing with NXT Embossing Admix

\* Horizontal use only; 170 Sound & Crack Isolation Mat can be turned up the wall (max. of 3" (75 mm)) in place of the perimeter isolation strip

\*\* Skim coat existing ceramic tile, stone or portland cement terrazzo with a latex thin-bed mortar first

^ Do not use on exterior facades or building envelopes

^^ Consult LATICRETE Technical Services for these substrates

† Consult LATICRETE Technical Services Dept. for exterior applications

Ⓞ Floors only (interior and exterior)













## Mosaic Installation that Blends a Contemporary Design with Western Flair Checks-in to Downtown Fort Worth Hotel

In early 2020, Texas commercial real estate developer Jackson Shaw wanted a show stopping sculpture and surrounding mosaic flooring to greet guests as they arrived at the Antonio Catalan (AC) Marriott Hotel in Fort Worth. As one of many swanky collaborations between AC Hotels President Antonio Catalan and Marriott International, the 252-room, 16-story hotel would be the first for the city. Strategically situated in the heart of downtown's booming Sundance Square, which has served as the new hotspot for top-tier employers and major U.S. headquarter relocations over the past few years, the hotel would emanate a classic modern design with European soul and Spanish roots, complementing the legacy Fort Worth is known for.

Jackson Shaw selected accomplished mosaic designer Julie Richey, owner of Julie Richey Mosaics, to spearhead what would be one's first impression before entering the hotel, an elaborate mosaic entryway featuring a column sculpture and surrounding mosaic flooring. Jackson Shaw's main request was that the artistic feature would exude a 'contemporary design with a Western flair,' which would also complement the ambiance of the hotel's interior. Inspired by local boot maker, M.L. Leddy, located in the historic Fort Worth Stockyards, Richey planned to incorporate the company's custom design aesthetic into an 11-by-10-foot (3 by 3.4-meters) mosaic flooring situated in the exterior entry. Plans for a 77.8 square-foot (7.23 square meter) Pamplona Rose Column, inspired by Spanish-rose themed leatherwork and sunburst stitch seen on custom boots, would also greet guests before they check-in.

With hopes to open its doors in Fall 2020, Richey hit the ground running on the project. With more than 30 years of experience in creating custom mosaic artwork and a portfolio of notable projects that spanned around the globe, Richey knew that a project of this size needed dependable, high-performance products.

"I have always had excellent results with LATICRETE and trust the quality. Working on commercial and residential mosaic projects means each one has a different set of challenges: site, intended use, physical materials, etc. In any situation, the LATICRETE technical support services are an essential tool for me to learn which materials work best for any given application," said Richey.

The project would be commissioned in two phases: the mosaic flooring, which is a boot stitch pattern outlining solid, waterjet-cut slabs of Neolith porcelain, and the column, an 8-foot-tall (2.4 meters) fiberglass form clad in mosaic tiles. In total, the project would encompass more than 200 pounds (90.7 kilograms) of glass mosaics in 35 different colors.

*Check out the full story on [www.laticrete.com](http://www.laticrete.com)*

