



Slurry Bond Coats (MVIS) – When and What to Use TDS 143M

Slurry bond coats are used to bond 'wet' consistency toppings or leveling beds over horizontal substrates, such as concrete or masonry. In any case, their purpose is to provide an adhesive layer that bonds the substrate and the material going over it.

For stone tile, thin brick, and stone paver setting purposes, traditional installation methods required dusting dry cement, or spreading a cement paste/slurry over the semi-dry mortar bed just prior to placing the stone. The Stone are then placed in the dry cement powder or, more correctly, a portland cement/water paste and "beaten" to imbed them fully in the mortar bed. "Beating" attaches a layer of cement rich paste as an adhesive between the sandy mortar bed surface and the stone backs.

Instead of the traditional cement paste, [MVIS Hi-Bond Veneer Mortar](#) mixed to a soft, wet slurry consistency is applied with a flat side of a trowel over the mortar bed. The stones are placed in the wet slurry and "beat-in" with a rubber mallet and beating block. This method requires the bonded mortar bed to have a minimum thickness of $\frac{3}{4}$ " (19 mm).

There are 2 methods of stone installation when using a bonded mortar bed: the pre-screed method and the wet set method.

- The pre-screed method (allowing the bonded mortar bed to cure before the application of stone) allows the bonded mortar to have nominal thickness, the mortar bed can be screeded as low as the aggregate will allow.
- The wet set method (setting stone on top of uncured semi dry mortar bed and beat in with a slurry) has a required minimum thickness of $\frac{3}{4}$ " (19 mm).

Recommended Mortar Bed and Slurry Bond Coat Mortars:

- [MVIS Premium Mortar Bed](#)
Dry Pack Consistency for Floors: Mix a 60 lb bag (27.2 kg) with 2 – 3.2 quarts (1.9 – 3 L) of water for 2 to 3 minutes. Mix to a stiff, semi-dry consistency. Allow to slake for 5 minutes. Remix for another 2 to 3 minutes without adding any water or powder.
- [MVIS Hi-Bond Veneer Mortar](#)
Slurry Bond Coat: Mix 7 quarts (6.6 L) water: 50 lbs. MVIS Hi-Bond Veneer Mortar.
Approximate Coverage @ 1/16" (1.5 mm) thickness: 120 - 130 ft² (11.1 - 12 m²) per stated mix proportions

See link to detail drawing [Bonded Mortar Bed](#)

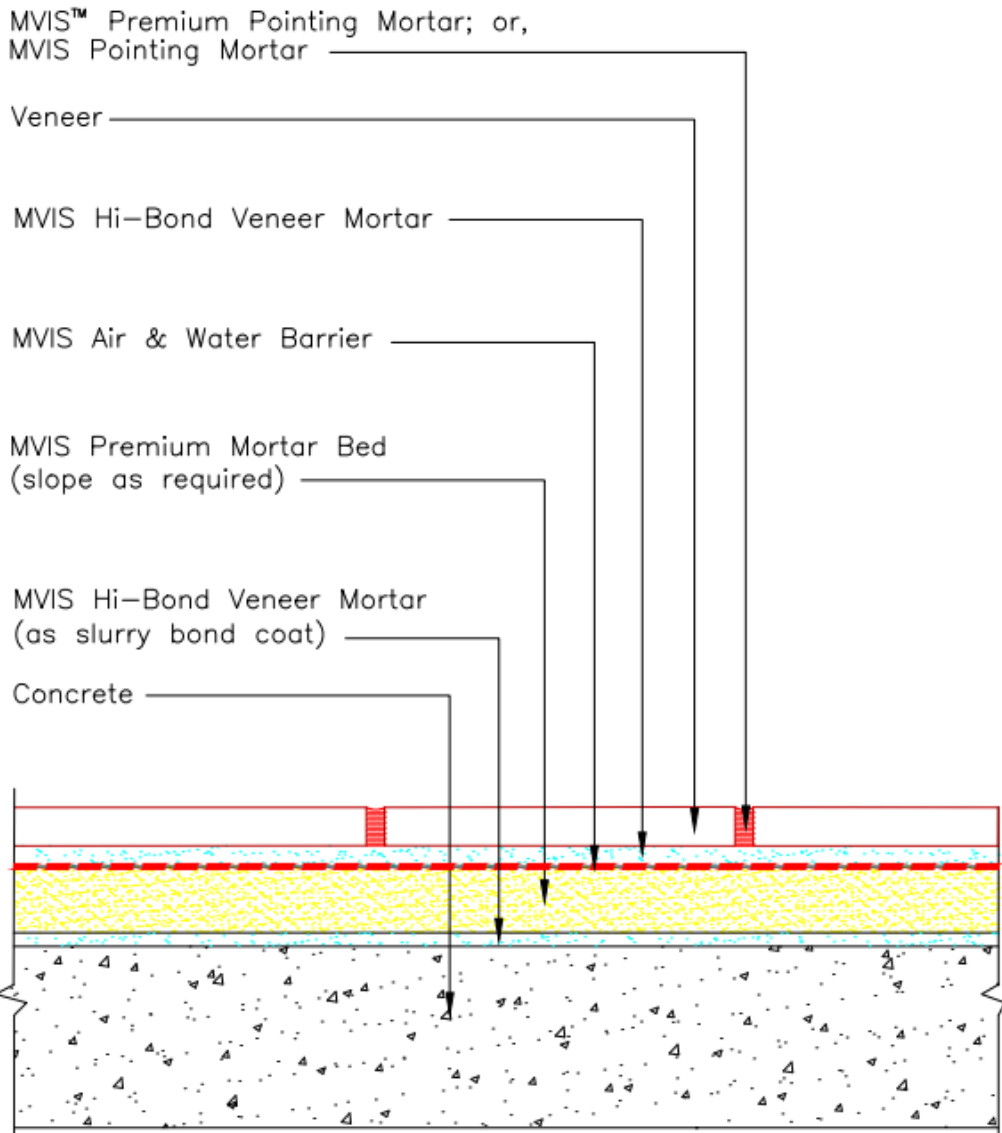

Technical Data Sheets are subject to change without notice. For latest revision, check our website at www.laticrete.com
TDS 143.doc R 9 January 2023



LATICRETE INTERNATIONAL, INC. ▪ 1 LATICRETE Park North ▪ Bethany, CT 06524-3423 USA
800.243.4788 ▪ support@laticrete.com ▪ www.laticrete.com

©2013 LATICRETE INTERNATIONAL, INC. All trademarks shown are the intellectual properties of their respective owners.